

# 330 N ANCESTOR PLACE

INDUSTRIAL SPACE FOR LEASE / BOISE, ID 83704



Two (2) docks and one (1) grade level door

Generous truck and trailer access to all doors

Close to restaurants and retail with easy access to major thoroughfares

Includes full HVAC for the office—providing both heating and air conditioning. Warehouse is heated by a dedicated gas-fired system

The building is fully sprinklered throughout

SPACE	SIZE	RATE
Suite 150	OFFICE 2,182 SF	\$1.45 PSF NNN
	WAREHOUSE 2,363 SF	
	TOTAL 4,545 SF	

SUBMARKET	West Boise	AVAILABLE	2/1/2026
BLDG TYPE	Industrial/Flex	EST. NNN	\$0.38 PST
GRADE DOORS	(1) 12X12	DOCK DOORS	(2) 10x10
ZONING	I-1 Industrial Light	CLEAR HEIGHT	25'

CONTACT AGENT FOR SHOWING INSTRUCTIONS

CONTACT

**GAVIN PHILLIPS, SIOR**  
208.401.4101  
gavin@tokcommercial.com

**MIKE ARNOLD**  
208.957.5609  
mikea@tokcommercial.com

HIGHLIGHTS



DETAILS



UPDATED: 11.7.2025

THIS PROPERTY IS EXCLUSIVELY MARKETING BY TOK BOISE LLC DBA TOK COMMERCIAL  
This information was obtained from sources believed reliable but cannot be guaranteed. Any opinions or estimates are used for example only.

**TOK**COMMERCIAL.COM



AVAILABLE



## FLOOR PLAN

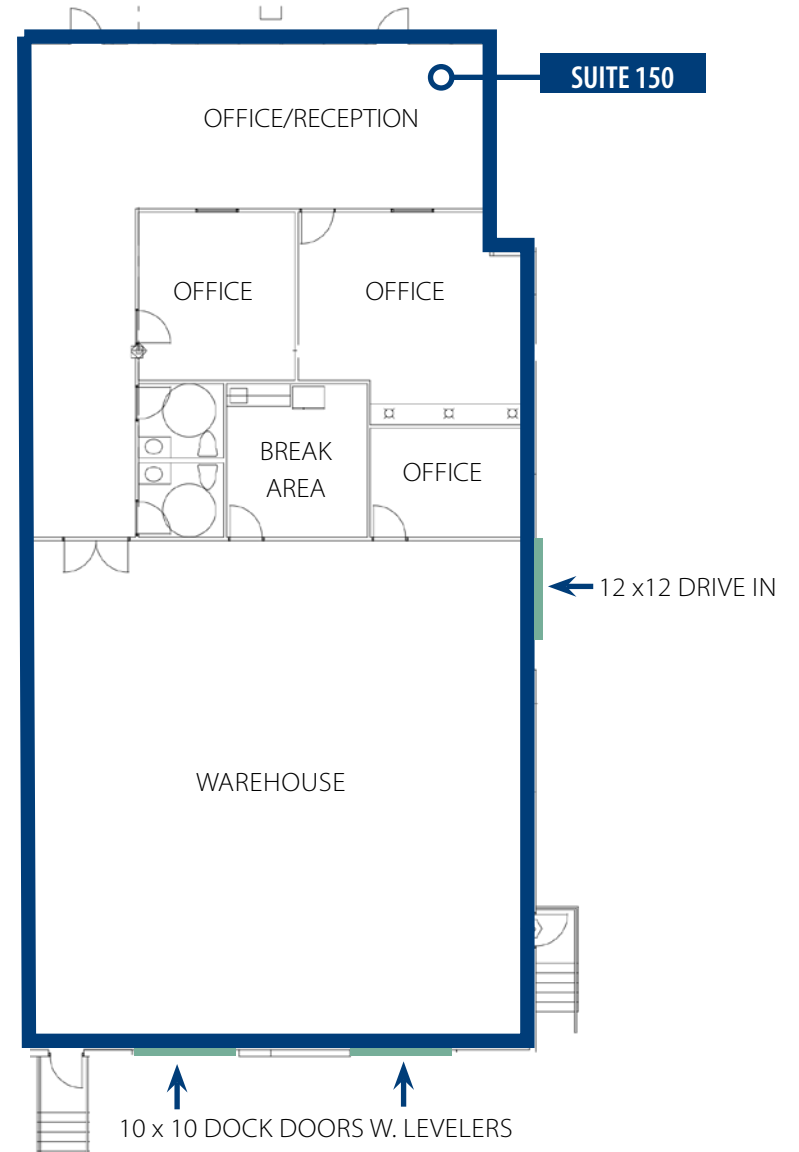

330 ANCESTOR



# AERIAL MAP

