



SPERRY

SEGAI CRE

2020

ELM CT
ONTARIO, CA 91761

FOR SALE

Call for More Information



Cristina Hsieh, CCIM
MANAGING BROKER
909.967.9588
cristina.hsieh@sperrycga.com
CalDRE #01944970



Property Details & Highlights



Property Type	Industrial
Property Sub-type	Warehouse, Distribution
APN	0113-395-28
Building Size*	±25,247 SF
Lot Size	±1.07 Acres
Year Built/Renovated	1988/2021
Footing and Foundation	Reinforced Concrete Slab
Structure	Concrete Tilt-up
Loading Dock	Two (2) 12'x14' Interior Truck Well
Ground Level Door*	Two (2) 10' x 12', Five (5) 12' x 14'
Power	225 Amp, 277/480 V, 3 Phase (Verify)
Ceiling Height	18' Minimum Clear Height

Introducing a prime owner-user and investment opportunity in the heart of the Inland Empire Airport Area, one of the fastest-growing industrial markets in the nation. This property features ±25,247 SF total building area, consisting of ±1,202 SF (4.8%) office space and ±24,045 SF (95.2%) warehouse space.

With seven (7) ground level doors and two (2) interior truck wells, the property is designed for maximum efficiency and seamless logistics. The versatile layout provides ample space for light manufacturing, warehousing, or distribution, catering to a wide range of business operations.

Strategically located with convenient access to major freeways and regional transportation corridors, this property offers an ideal foundation for owner-users and investors seeking a strategic foothold in the long-term growth in the Inland Empire region.

* Size measured per appraisal report



- Well-maintained Industrial Park
- Three (3) Private Offices, Lobby/Reception, Three (3) Restrooms.
- Fire Sprinklered
- 39 Asphalt-paved Parking Spaces (Parking Ratio of 1.54 per 1,000 square feet)
- Monthly Association Fee: \$742.01 (as of January 2026)
- Convenient Access to Fwy I-10, SR-60, I-15
- Appr. 4 miles from Ontario International Airport
- Inland Empire West- Airport Area Submarket

Additional Photos



Lobby/Reception



Ground Level Roll-up Doors



Warehouse (Photo Taken While Vacant)



Two (2) Interior Truck Wells

Floor Plans (NOT TO SCALE)

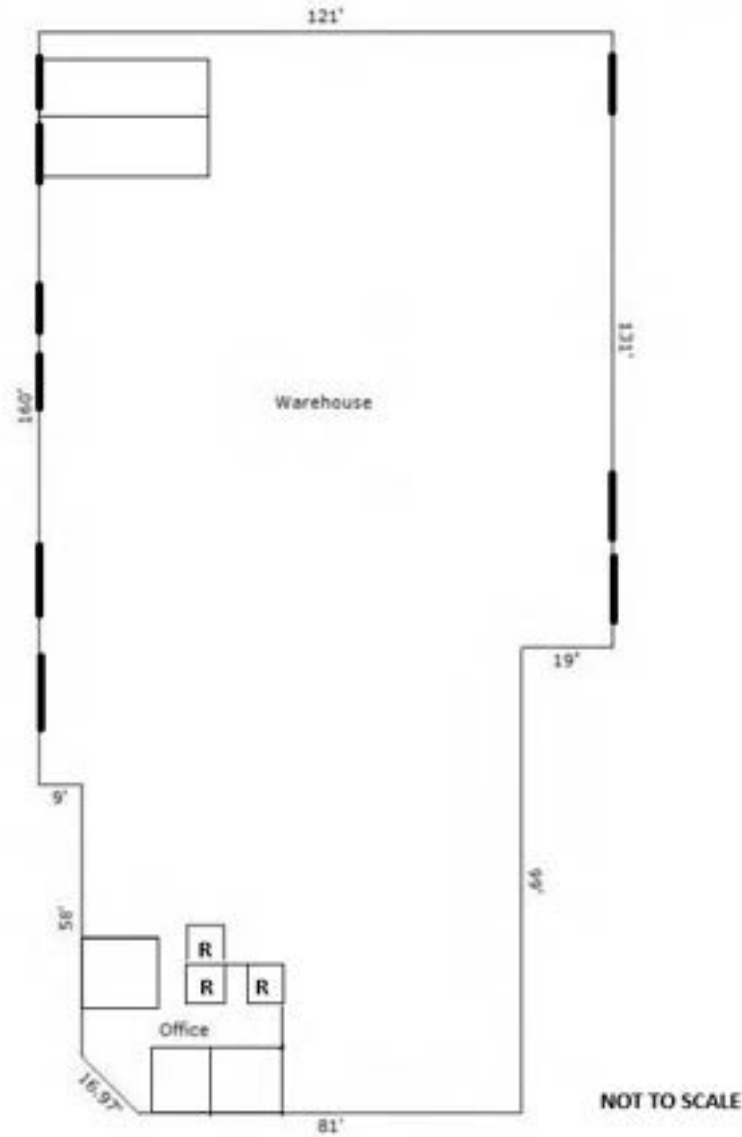

Location Map

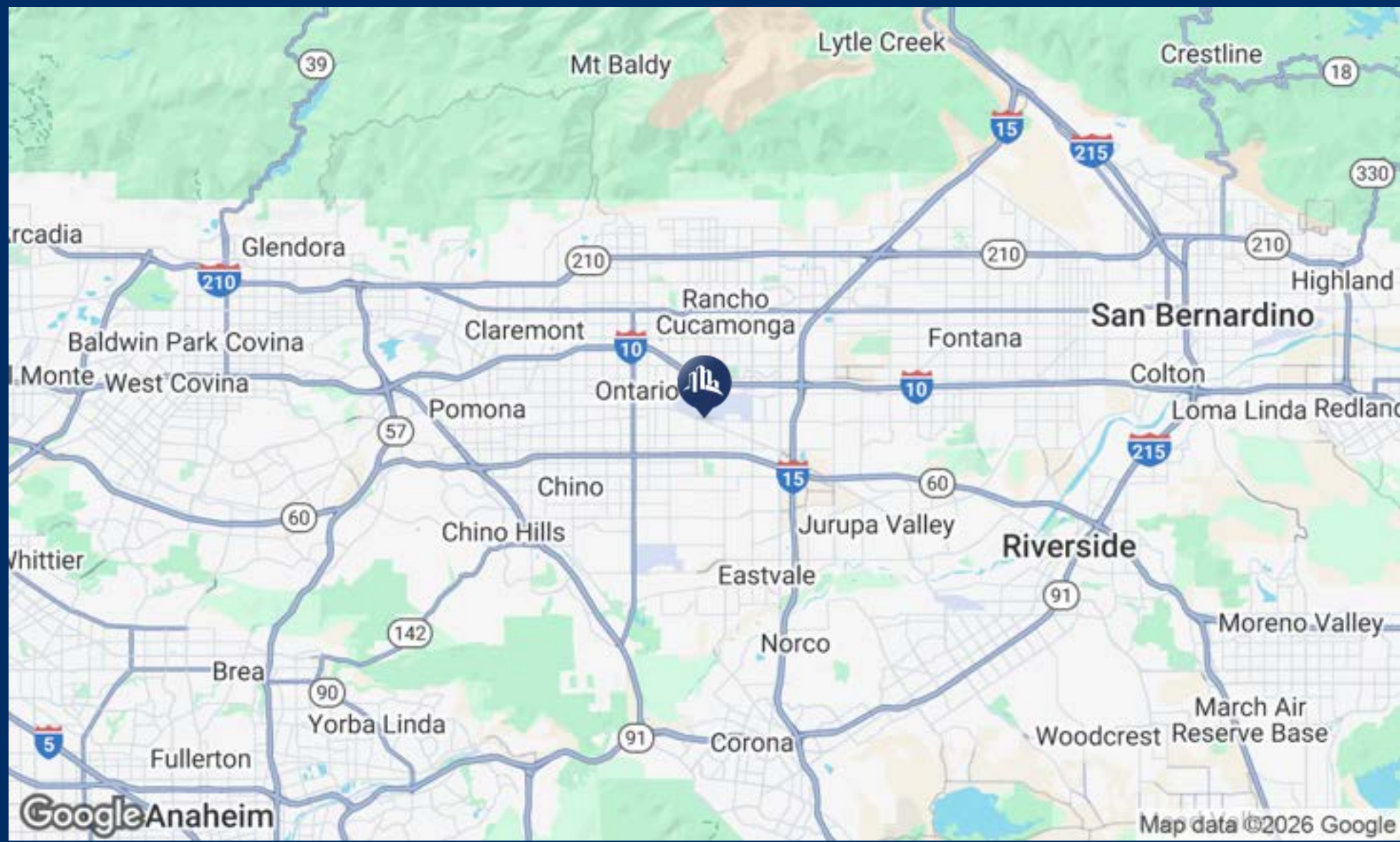

SPERRY - SEGAI CRE | 3200 E. GUASTI ROAD #100 | ONTARIO, CA 91761

SEGAICRE.COM

We obtained the information above from sources we believe to be reliable. However, we have not verified its accuracy and make no guarantee, warranty or representation about it. It is submitted subject to the possibility of errors, omissions, change of price, rental or other conditions, prior sale, lease or financing, or withdrawal without notice. We include projections, opinions, assumptions or estimates for example only, and they may not represent current or future performance of the property. You and your tax and legal advisors should conduct your own investigation of the property and transaction.