

Pointe West I

15951 SW 41st Street, Davie, FL



Pointe West I

- Institutionally owned business park
- Busy Weston road frontage
- Building 1, Suite 100 - dock height loading
- Building 3, Suite 100 - grade level loading

Rate & Term

- \$19.00 psf NNN
- Minimum 5-year term

Availabilities

- Building 1, Suite 100 - 7,234 sf
- Building 3, Suite 100 - 7,800 sf

Location

- Located at the NE corner of Weston Rd and SW 41st

Drive Time



15 Miles, 17 Minutes



1 Miles, 3 Minutes



17 Miles, 19 Minutes



5 Miles, 10 Minutes



FLL

20 Miles, 22 Minutes



5 Miles, 10 Minutes

Tom Viscount, Principal
954 643 6591
tom.viscount@avisonyoung.com

333 E Las Olas Blvd
Suite 200
Fort Lauderdale, FL 33301

Pointe West I

Building 1 | 15751 SW 41st Street, Davie, FL

Suite 100 - 7,234 sf

- Endcap with multiple windows
- 24' clear height
- Dock height loading

Rate & Term

- \$19.00 psf NNN
- Minimum 5-year term

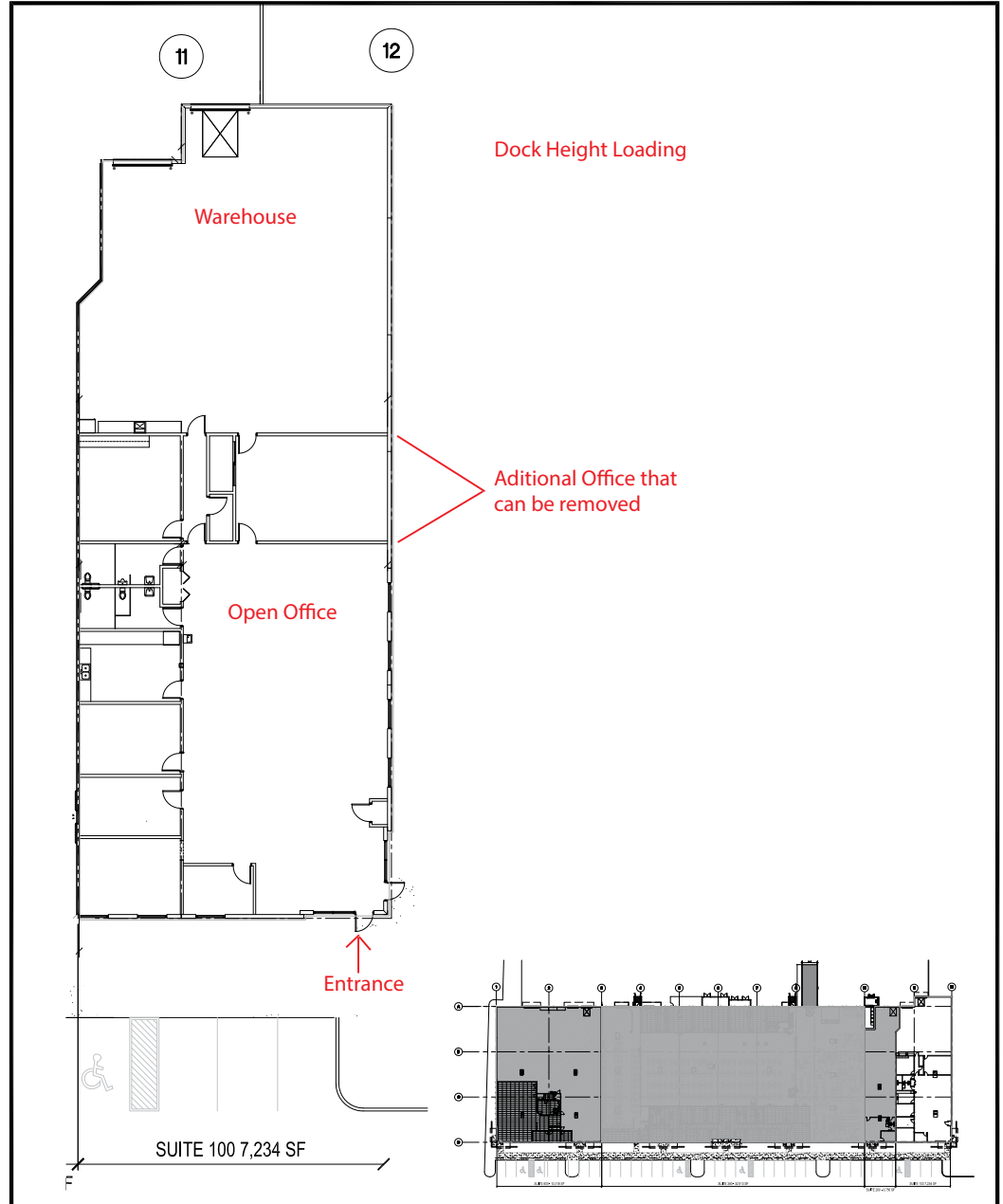

**AVISON
YOUNG**

Tom Viscount, Principal
954 643 6591
tom.viscount@avisonyoung.com

333 E Las Olas Blvd
Suite 200
Fort Lauderdale, FL 33301

Pointe West I

Building 3 | 15951 SW 41st Street, Davie, FL

Suite 100 - 7,800 sf

- Endcap with multiple windows
- 24' clear height
- Grade level loading

Rate & Term

- \$19.00 psf NNN
- Minimum 5-year term

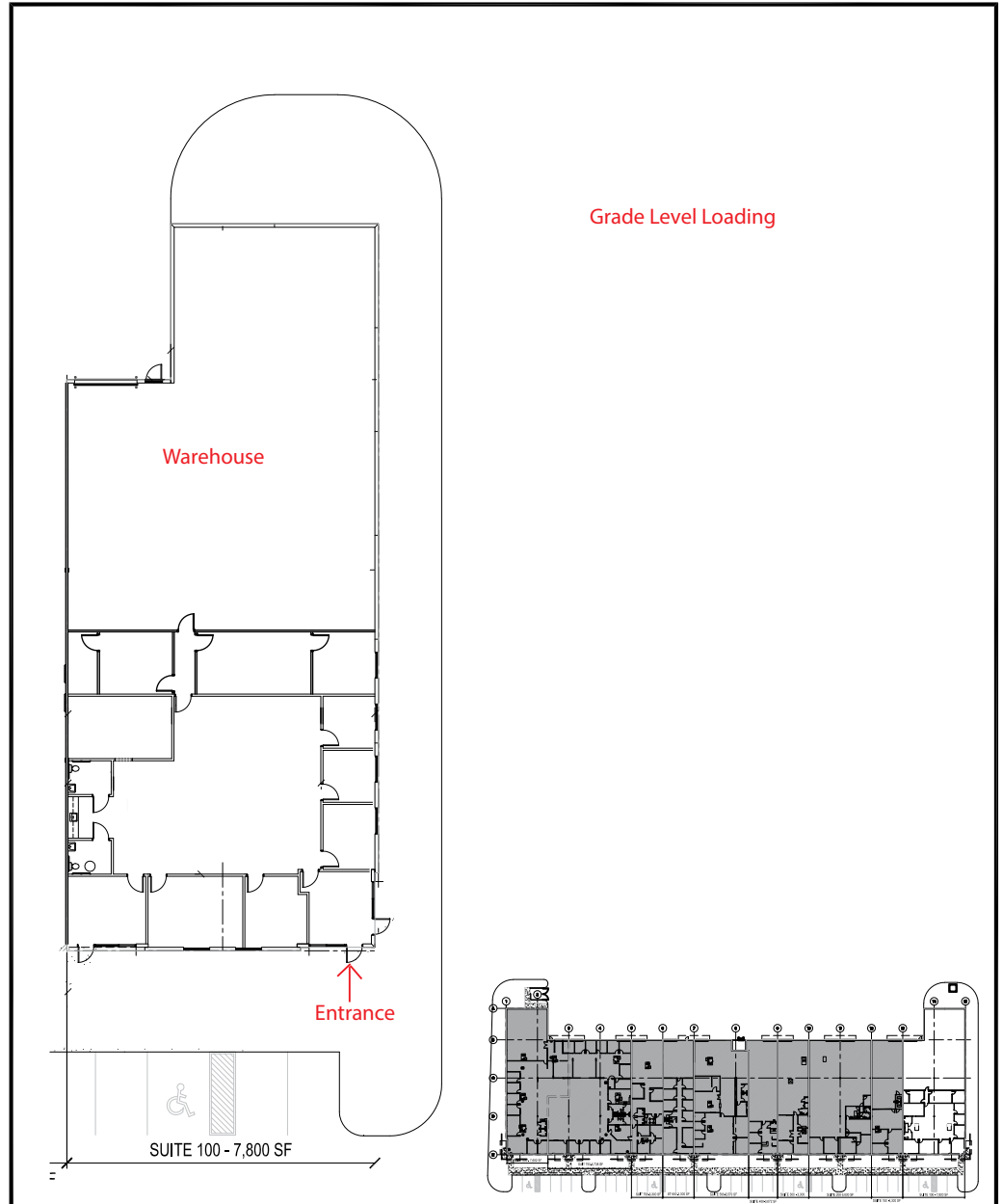

**AVISON
YOUNG**

Tom Viscount, Principal
954 643 6591
tom.viscount@avisonyoung.com

333 E Las Olas Blvd
Suite 200
Fort Lauderdale, FL 33301

Pointe West I

15951 SW 41st Street, Davie, FL

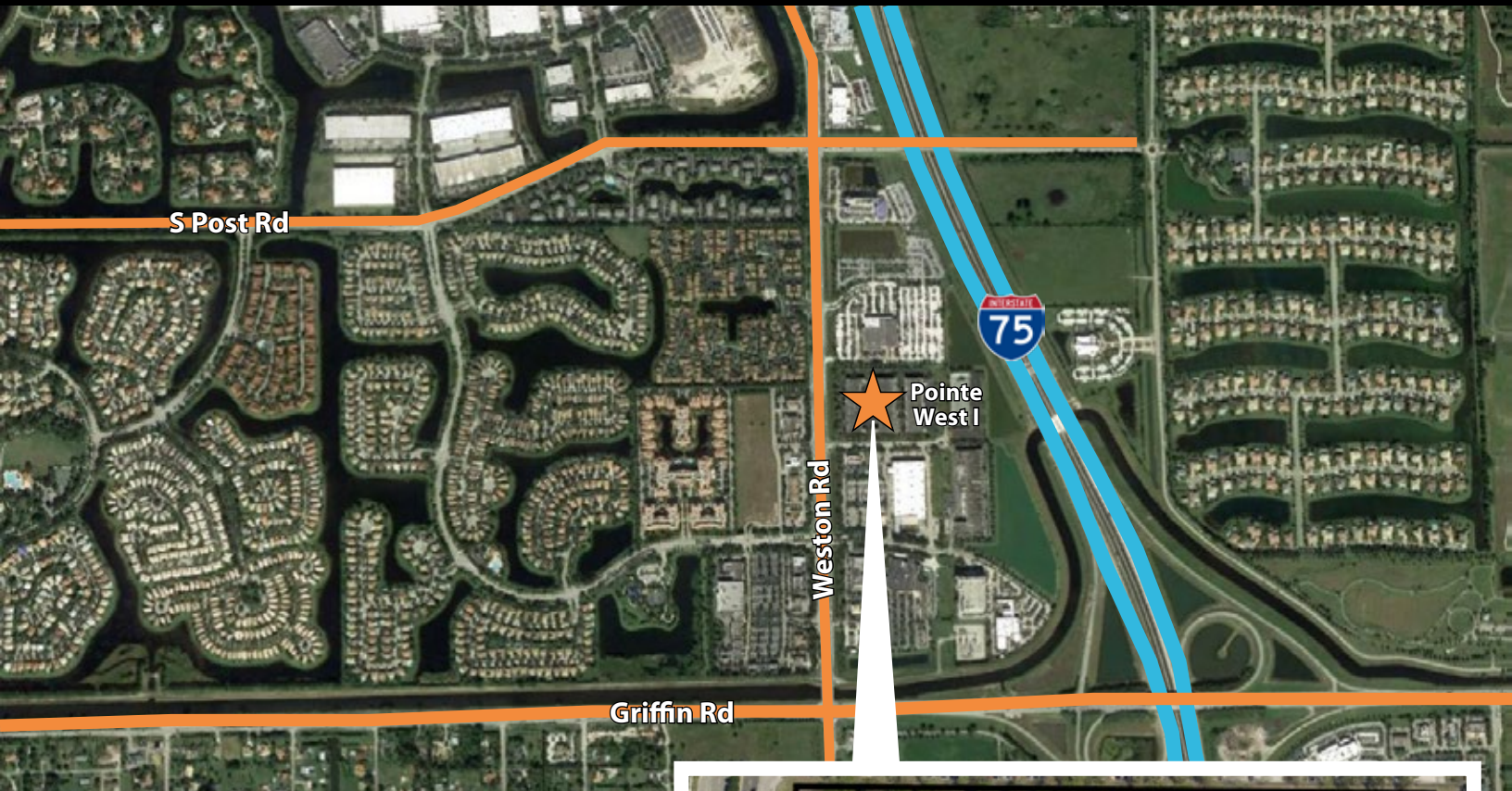

Prime Location

- Busy Weston Road Frontage
- 1 Mile to I-75
- 5 Miles to I-595 or SR 27
- 15 Miles to Florida's Turnpike
- 20 Miles to Fort Lauderdale-Hollywood International Airport and Port Everglades



**AVISON
YOUNG**

Tom Viscount, Principal
954 643 6591
tom.viscount@avisonyoung.com

333 E Las Olas Blvd
Suite 200
Fort Lauderdale, FL 33301