

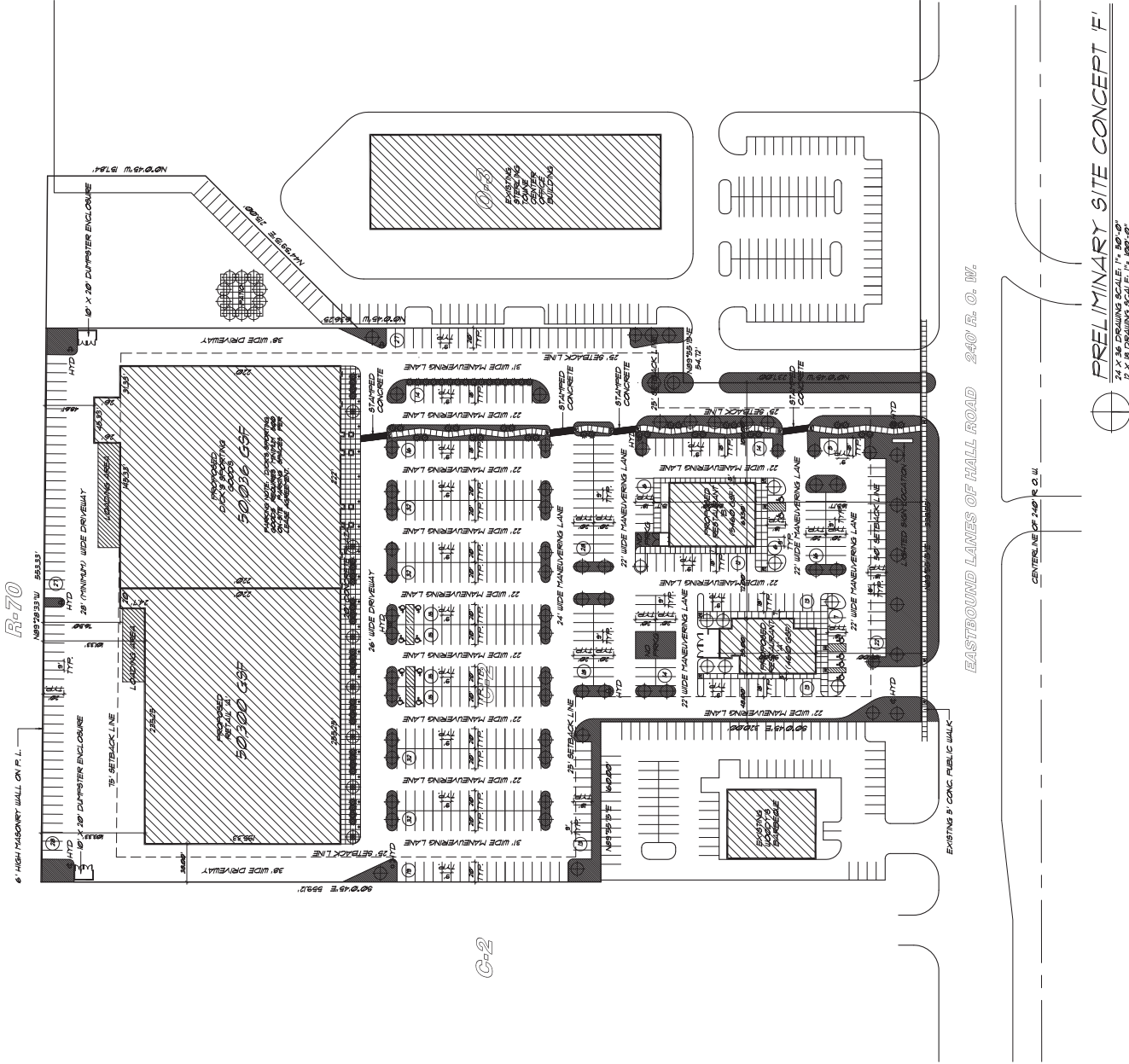

## SITE LOCATION MAP

NOT TO SCALE

- ### SITE PLANNING DATA:
1. PROJECT GENERAL DESCRIPTION: NEW DEVELOPMENT CONSISTS OF NEW DUCKS SPORTING GOODS STORE (AREA 001), NEW RESTAURANT BUILDING FOR UNANVED TRAVELERS (AREA 002), AND NEW RESTAURANT BUILDING FOR UNANVED TRAVELERS (AREA 003).
  2. SITE ZONING: PLANNED COMMERCIAL DISTRICT (C-2). ZONING OF SURROUNDING PROPERTIES ARE SHOWN ON DEVELOPMENT WILL BE FULLY AND APPROPRIATELY INTEGRATED.
  3. TRASH RECEPTACLES: AS SHOWN ON THE SITE PLAN.
  4. SANITATION: LOCATED IN THE REAR OF THE PROPOSED DEVELOPMENT AND WILL BE FULLY AND APPROPRIATELY INTEGRATED.
  5. FENCES AND WALLS: AN EXISTING 6' HIGH CAST-IN-PLACE CONCRETE SCREENING WALL RUNS ALONG THE SOUTH PROPERTY LINE. NO FURTHER WALLS OR FENCES ARE PROPOSED.
  6. SITE DIMENSIONS: INDICATED ON THE SITE PLAN DRAWING.
  7. LEGAL DESCRIPTION: INDICATED ON THE SITE PLAN DRAWING.
  8. SITE AREA: APPROX. 87,000 SQ. FT. (2.0 ACRES).
  9. PROPOSED HYDRANT LOCATIONS: INDICATED ON THE SITE PLAN DRAWING.
  10. PARKING SPACES: INDICATED ON THE SITE PLAN DRAWING.
    - TOTAL PARKING SPACES: 150
    - TOTAL PARKING SPACES: 150
    - TOTAL PARKING SPACES: 150
  11. TRASH RECEPTACLES: INDICATED ON THE SITE PLAN DRAWING.
  12. SANITATION: INDICATED ON THE SITE PLAN DRAWING.



## PRELIMINARY SITE CONCEPT 'F'

24' X 36' DRAWING SCALE: 1" = 50'-0"  
12' X 18' DRAWING SCALE: 1" = 100'-0"