

211 EAST 123RD STREET NEW YORK, NY

DRIVE-IN/RETAIL/
OFFICE SPACE
FOR LEASE

LEARN MORE



2,500 SF GROUND AVAILABLE + 1,200 BASEMENT



CONTACT US

ANTHONY GAGLIANO

(917) 446-4400

ANTHONY@SRPBROKERS.COM

RUDOLPH DEMASI

(914) 391-1949

RUDY@SRPBROKERS.COM

PAUL MCVEIGH

(646) 339-7890

PAUL@SRPBROKERS.COM

THE INFORMATION CONTAINED HEREIN HAS BEEN OBTAINED FROM SOURCES BELIEVED TO BE RELIABLE BUT IS NOT GUARANTEED. STRATEGIC REALTY PARTNERS AND ITS AGENTS MAKE NO REPRESENTATIONS OR WARRANTIES, EXPRESS OR IMPLIED, AS TO THE ACCURACY, COMPLETENESS, OR SUITABILITY OF THE INFORMATION. ALL INTERESTED PARTIES ARE RESPONSIBLE FOR CONDUCTING THEIR OWN INDEPENDENT INVESTIGATION AND VERIFICATION OF ALL DATA, INCLUDING BUT NOT LIMITED TO SQUARE FOOTAGE, ZONING, LAND USE, AND FINANCIAL PROJECTIONS. THIS OFFERING IS SUBJECT TO ERRORS, OMISSIONS, PRIOR SALE OR LEASE, CHANGE IN PRICE OR TERMS, AND WITHDRAWAL WITHOUT NOTICE.

PRIME EAST HARLEM LOCATION

- 2,500 SF Ground Floor with 1,200 SF Basement
- Flexible Use Including Retail, Drive-In Space, Office
- Ceiling Height: 11'
- Legal Curb Cut and Driveway with Enforceable Tow Away Zone
- Large Overhead Door with Drive-In Bay
- Easily Accessed by Major Transportation, 2 Blocks away from the 4 5 6 Trains
- Ideal for a Distributor, Manufacturer, E-Commerce Business, Automotive and Much More



CONTACT US

ANTHONY GAGLIANO
(917) 446-4400

ANTHONY@SRPBROKERS.COM

RUDOLPH DEMASI
(914) 391-1949

RUDY@SRPBROKERS.COM

PAUL MCVEIGH
(646) 339-7890

PAUL@SRPBROKERS.COM

211 EAST 123RD STREET FLOOR PLAN

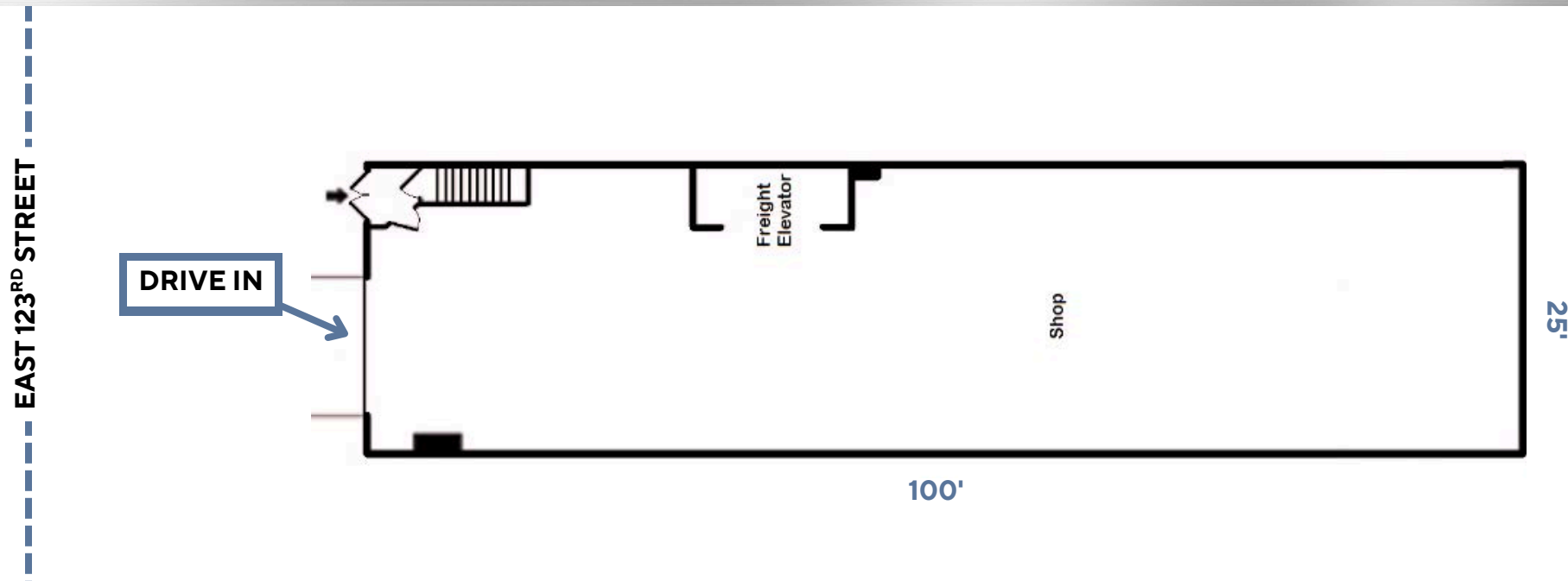

MATTERPORT 3D VIRTUAL WALKTHROUGH

SCAN HERE



CONTACT US

ANTHONY GAGLIANO

(917) 446-4400

ANTHONY@SRPBROKERS.COM

RUDOLPH DEMASI

(914) 391-1949

RUDY@SRPBROKERS.COM

PAUL MCVEIGH

(646) 339-7890

PAUL@SRPBROKERS.COM

THE INFORMATION CONTAINED HEREIN HAS BEEN OBTAINED FROM SOURCES BELIEVED TO BE RELIABLE BUT IS NOT GUARANTEED. STRATEGIC REALTY PARTNERS AND ITS AGENTS MAKE NO REPRESENTATIONS OR WARRANTIES, EXPRESS OR IMPLIED, AS TO THE ACCURACY, COMPLETENESS, OR SUITABILITY OF THE INFORMATION. ALL INTERESTED PARTIES ARE RESPONSIBLE FOR CONDUCTING THEIR OWN INDEPENDENT INVESTIGATION AND VERIFICATION OF ALL DATA, INCLUDING BUT NOT LIMITED TO SQUARE FOOTAGE, ZONING, LAND USE, AND FINANCIAL PROJECTIONS. THIS OFFERING IS SUBJECT TO ERRORS, OMISSIONS, PRIOR SALE OR LEASE, CHANGE IN PRICE OR TERMS, AND WITHDRAWAL WITHOUT NOTICE.

211 EAST 123RD ST NEW YORK, NY



CONTACT US

ANTHONY GAGLIANO
(917) 446-4400

ANTHONY@SRPBROKERS.COM

RUDOLPH DEMASI
(914) 391-1949

RUDY@SRPBROKERS.COM

PAUL MCVEIGH
(646) 339-7890

PAUL@SRPBROKERS.COM

THE INFORMATION CONTAINED HEREIN HAS BEEN OBTAINED FROM SOURCES BELIEVED TO BE RELIABLE BUT IS NOT GUARANTEED. STRATEGIC REALTY PARTNERS AND ITS AGENTS MAKE NO REPRESENTATIONS OR WARRANTIES, EXPRESS OR IMPLIED, AS TO THE ACCURACY, COMPLETENESS, OR SUITABILITY OF THE INFORMATION. ALL INTERESTED PARTIES ARE RESPONSIBLE FOR CONDUCTING THEIR OWN INDEPENDENT INVESTIGATION AND VERIFICATION OF ALL DATA, INCLUDING BUT NOT LIMITED TO SQUARE FOOTAGE, ZONING, LAND USE, AND FINANCIAL PROJECTIONS. THIS OFFERING IS SUBJECT TO ERRORS, OMISSIONS, PRIOR SALE OR LEASE, CHANGE IN PRICE OR TERMS, AND WITHDRAWAL WITHOUT NOTICE.

211 EAST 123RD STREET NEW YORK, NY



CONTACT US

ANTHONY GAGLIANO

(917) 446-4400

ANTHONY@SRPBROKERS.COM

RUDOLPH DEMASI

(914) 391-1949

RUDY@SRPBROKERS.COM

PAUL MCVEIGH

(646) 339-7890

PAUL@SRPBROKERS.COM

THE INFORMATION CONTAINED HEREIN HAS BEEN OBTAINED FROM SOURCES BELIEVED TO BE RELIABLE BUT IS NOT GUARANTEED. STRATEGIC REALTY PARTNERS AND ITS AGENTS MAKE NO REPRESENTATIONS OR WARRANTIES, EXPRESS OR IMPLIED, AS TO THE ACCURACY, COMPLETENESS, OR SUITABILITY OF THE INFORMATION. ALL INTERESTED PARTIES ARE RESPONSIBLE FOR CONDUCTING THEIR OWN INDEPENDENT INVESTIGATION AND VERIFICATION OF ALL DATA, INCLUDING BUT NOT LIMITED TO SQUARE FOOTAGE, ZONING, LAND USE, AND FINANCIAL PROJECTIONS. THIS OFFERING IS SUBJECT TO ERRORS, OMISSIONS, PRIOR SALE OR LEASE, CHANGE IN PRICE OR TERMS, AND WITHDRAWAL WITHOUT NOTICE.