



**GENESEE  
COMMERCIAL  
GROUP, LLC**

# For LEASE or SALE Stand Alone Flex Building

616 Moss Street

Golden 80401



T. Blake Rogers - 720.530.5788  
tblakerogers@gcgcre.com

Tim P. Rogers - 303.641.4080  
tprogers@gcgcre.com

## Specifications

Available SF: 12,266 sf  
Office SF: 4,837 sf  
W/H SF: 7,429 sf

Sale Price: \$3,066,500  
Price per SF: \$250/sf  
Lot Size: .57 AC

Lease Rate: \$14.50/sf NNN  
NNN's: \$4.17/sf  
Monthly Rent: \$19,083.86  
Term: 5 - 10 Years  
Available: 2/1/2025

Configuration: 60% Warehouse  
Clear: 12'6"  
Power: TBV  
Zoning: I-1 Unincorporated  
Jefferson County  
Loading: 4 Drive-In Doors (10x12)



# IMAGES & FLOOR PLAN

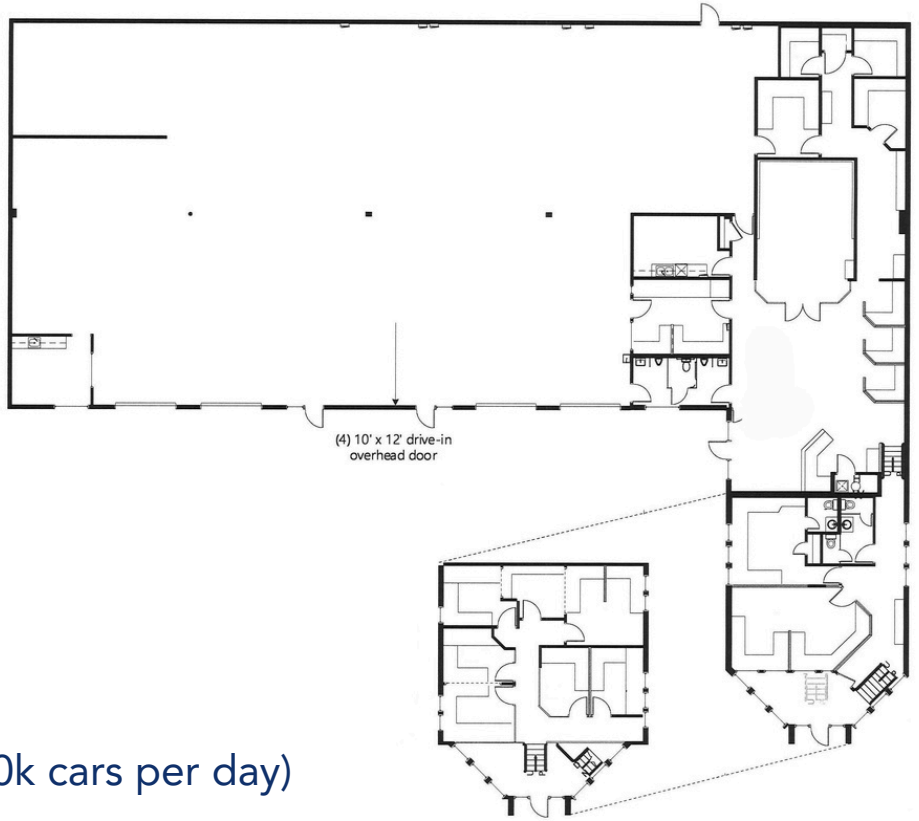

## Property Summation



6th Avenue Signage (80k cars per day)

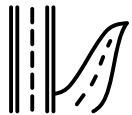

Convenient access to I-70/6th Ave/C-470



Approved Outside Storage



Drive In Loading Doors (x4)



Abundant Food & Retail Options



Ideal Corporate Headquarters



T. Blake Rogers - 720.530.5788  
tblakerogers@gcgcre.com

Tim P. Rogers - 303.641.4080  
trogers@gcgcre.com



**GENESEEE**  
COMMERCIAL  
GROUP, LLC