



- | ±2.0 Acre Parcel
- | Zoned I-2
- | Excellent Ingress/Egress
- | Full Median Break for Access

**Contact Broker:**

**Jeff Doxey, CCIM**

804.363.0332

jeffdoxey@naidominion.com



NAI Dominion



Fast & Friendly

FALLING CREEK IRONWORKS



DEMOGRAPHICS			
	<u>3 MILES</u>	<u>5 MILES</u>	<u>10 MILES</u>
2022 Population	38,949	124,998	507,097
2022 Households	14,431	45,519	202,666
Average HH Income	\$63,341	\$68,415	\$78,483

	<u>3 MILES</u>	<u>5 MILES</u>	<u>10 MILES</u>
2022 Population	38,949	124,998	507,097
2022 Households	14,431	45,519	202,666
Average HH Income	\$63,341	\$68,415	\$78,483



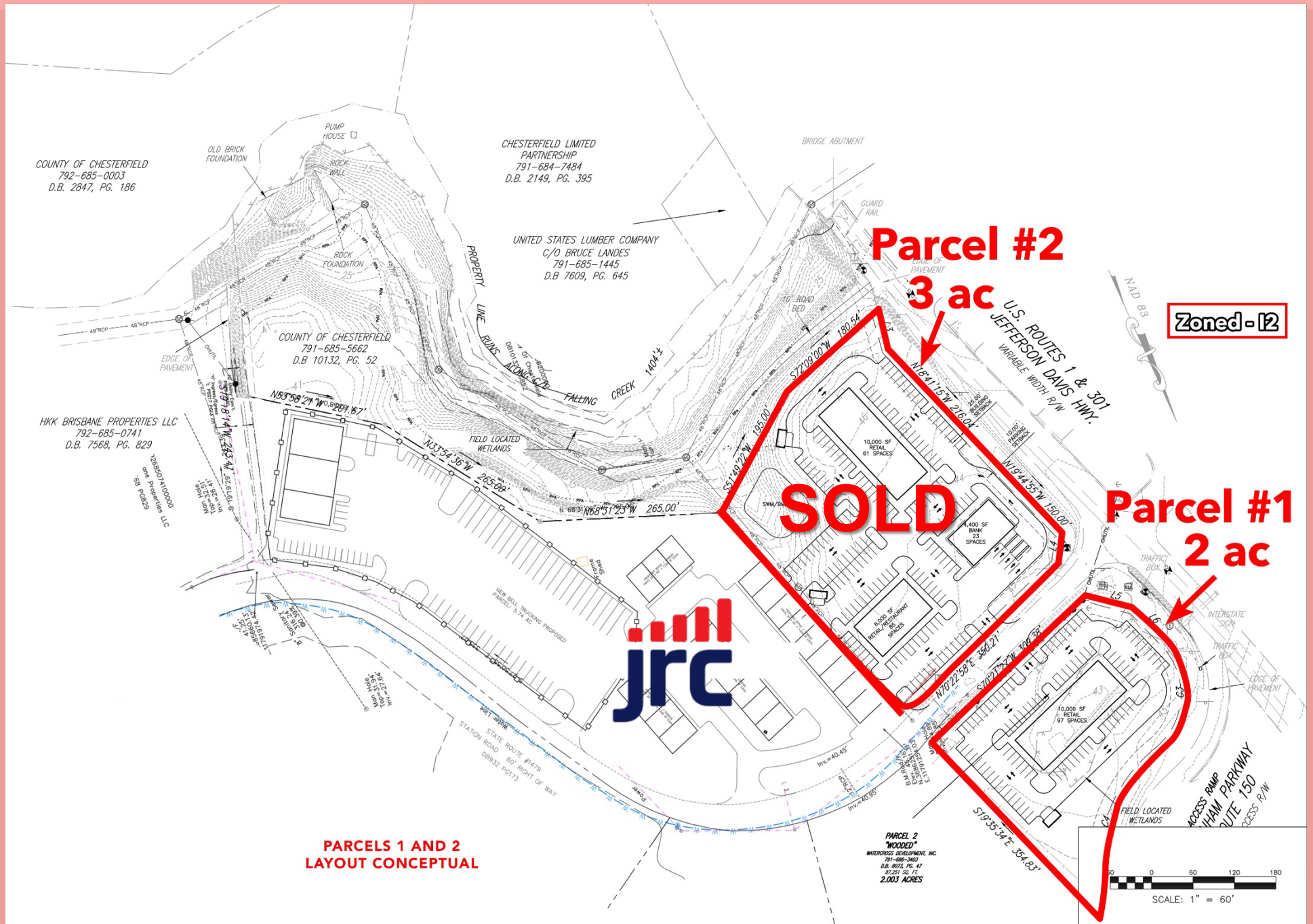

# For Sale

2500 Station Rd | Richmond, VA 23234



## PROPERTY DETAILS

Type:	Land
Parcel Sizes:	±2.0 Acres
Zoned:	I-2
Price:	Contact Broker for Pricing
Address:	2500 Station Rd, Richmond, VA
Cross Streets:	Station Rd + US Route 1
County:	Chesterfield County

## PROPERTY HIGHLIGHTS

- | Parcel Size: ±2.0 acres
- | Flexible zoning supports retail on lot per Chesterfield County
- | Property is located at the on-ramp for Chippenham Pkwy/I-95
- | Excellent ingress/egress with full median break for access

NO WARRANTY OR REPRESENTATION, EXPRESS OR IMPLIED, IS MADE AS TO THE ACCURACY OF THE INFORMATION CONTAINED HEREIN, AND THE SAME IS SUBMITTED SUBJECT TO ERRORS, OMISSIONS, CHANGE OF PRICE, RENTAL OR OTHER CONDITIONS, PRIOR SALE, LEASE OR FINANCING, OR WITHDRAWAL WITHOUT NOTICE, AND OF ANY SPECIAL LISTING CONDITIONS IMPOSED BY OUR PRINCIPALS. NO WARRANTIES OR REPRESENTATIONS ARE MADE AS TO THE CONDITION OF THE PROPERTY OR ANY HAZARDS CONTAINED THEREIN ARE ANY TO BE IMPLIED. REV 4-8-20