



# Southeast Crossing

5425 E Raines Rd, Memphis, TN 38115

Available for Lease  
6,970± SF | Industrial



## Suite Available



**Suite 5**  
1 -dock high door  
1 - grade level door



16'  
Clear  
Height



Easy Access to  
I-40, I-240, I-55 &  
I-22 (Hwy. 78)



Close to  
Memphis  
Int'l Airport &  
Hub facilities

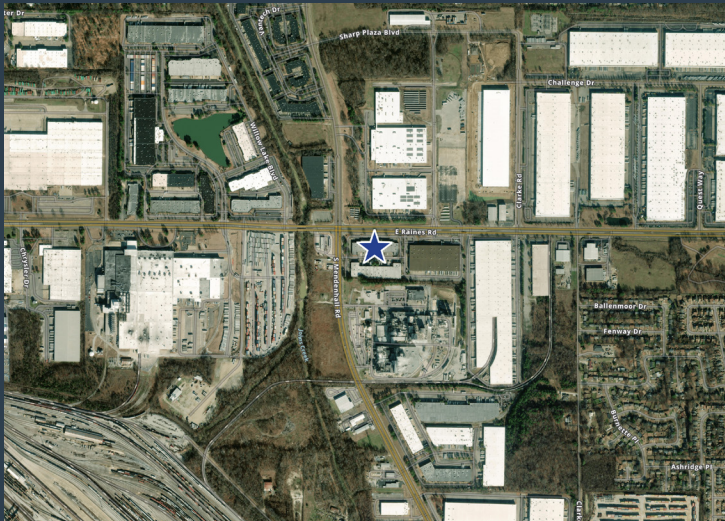

### Please contact

**ELLIOT EMBRY, SIOR**  
Direct: 901 312 4902  
Mobile: 901 634 2583  
elliott.embry@colliers.com

**TIM MASHBURN**  
Direct: 901 312 5771  
Mobile: 901 356 2900  
tim.mashurn@colliers.

[View Online](#)



## Space Features

6,970± SF available	1 dock door
Office 1,340± SF	1 grade level door

## 5425 E Raines Rd Floor plan

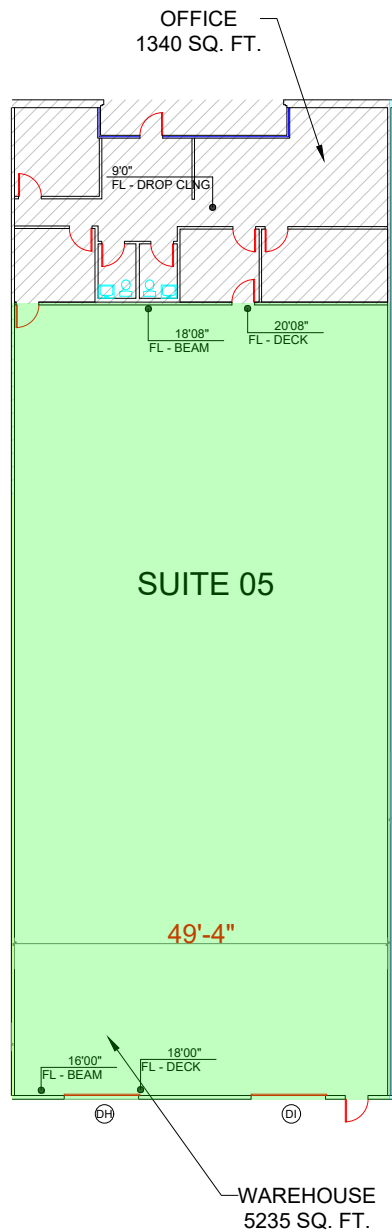

## Please contact

**ELLIOT EMBRY, SIOR**  
 Direct: 901 312 4902  
 Mobile: 901 634 2583  
[elliott.embry@colliers.com](mailto:elliott.embry@colliers.com)

**TIM MASHBURN**  
 Direct: 901 312 5771  
 Mobile: 901 356 2900  
[tim.mashburn@colliers.com](mailto:tim.mashburn@colliers.com)



6363 Poplar Ave., Suite 220  
 901.375.4800  
[colliers.com/memphis](http://colliers.com/memphis)

