



**FOR LEASE** | **186,359 SF**  
**1555 IL ROUTE 75 E** | **FREEPORT, IL**

**ANTHONY CRIVELLO** 414-982-4810 | [ANTHONY@PHOENIXINVESTORS.COM](mailto:ANTHONY@PHOENIXINVESTORS.COM)  
**LUKE HERDER** 414-244-9575 | [LHERDER@PHOENIXINVESTORS.COM](mailto:LHERDER@PHOENIXINVESTORS.COM)

This document has been prepared by Phoenix Investors for advertising and general information only. Phoenix Investors makes no guarantees, representations, or warranties of any kind, expressed or implied, regarding the information including, but not limited to, warranties of content, accuracy, and reliability.



**PHOENIX**  
**INVESTORS**

*Opportunity. Execution. Value Creation.*



# PROPERTY HIGHLIGHTS



**CLOSE PROXIMITY TO  
US HWY 20**



**30 MILES FROM  
CHICAGO ROCKFORD  
INTERNATIONAL  
AIRPORT**



**LOCATED IN THE  
STEPHENSON COUNTY  
ENTERPRISE ZONE**



# PROPERTY DETAILS

1555 IL ROUTE 75 E | FREEPORT, IL

AVAILABLE SPACE	186,359 SF
MINIMUM DIVISIBLE	3,646 SF
OFFICE SPACE	20,256 SF
DOCK DOORS	28
DRIVE-IN DOORS	10 Grade Level
CRANES	10-ton
CLEAR HEIGHT	14' - 25'
WALLS	Metal
YEAR BUILT	1980
FIRE SUPPRESSION	100% Sprinkled
POWER	480 Volt/Phase
LAND AREA	102 Acres
ZONING	M-2: General Manufacturing
<b>OPEX ESTIMATE</b>	<b>\$0.49/SF</b>

[VIEW A VIDEO OF THIS PROPERTY](#)

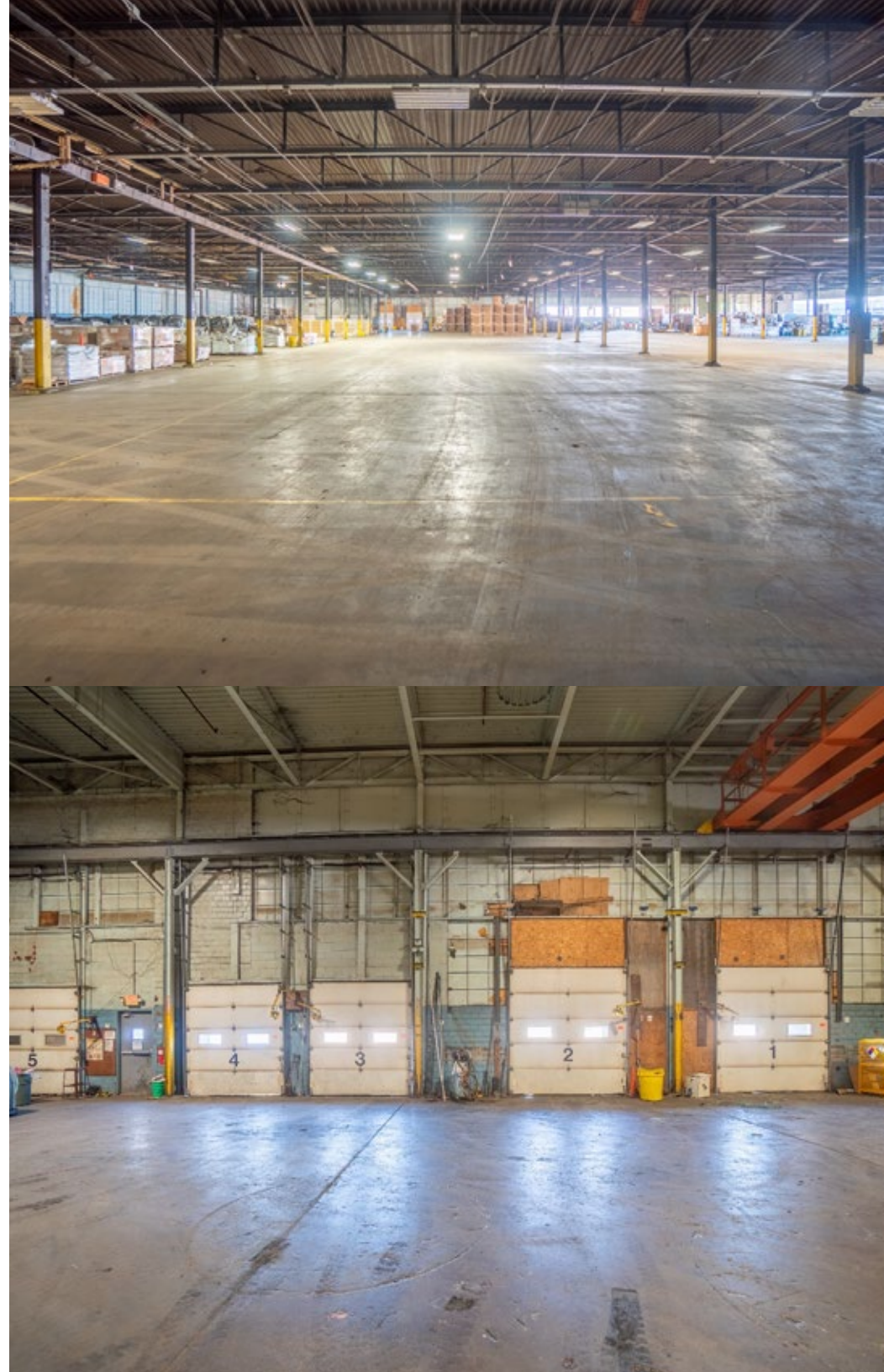

# FLOOR PLAN

1555 IL ROUTE 75 E | FREEPORT, IL

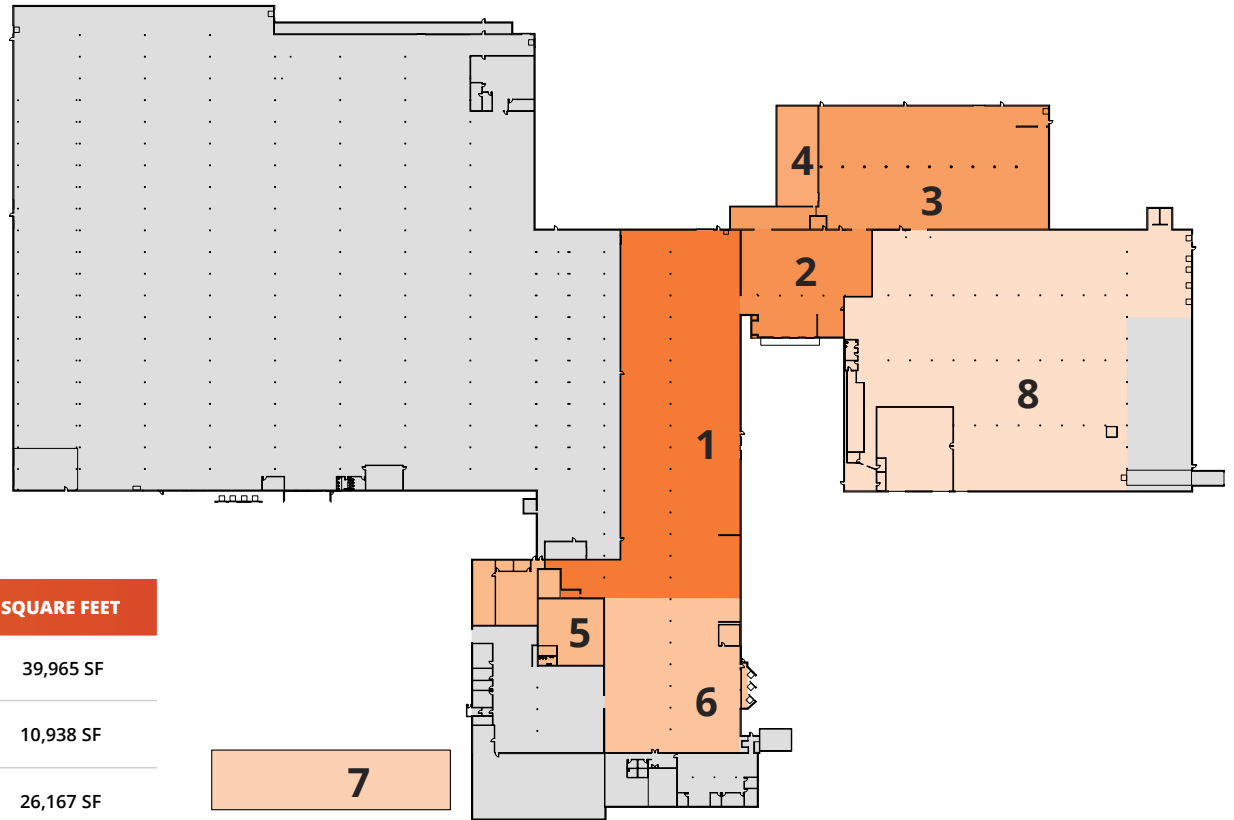

NUMBER	SPACE DESIGNATION	DOCK DOORS	CLEAR HEIGHT	SQUARE FEET
1	AVAILABLE	3	14' 0"	39,965 SF
2	AVAILABLE	3	16' 0"	10,938 SF
3	AVAILABLE	1	22' 0"	26,167 SF
4	AVAILABLE	N/A	22' 0"	3,646 SF
5	AVAILABLE	N/A	DROP CEILING	8,156 SF
6	AVAILABLE	3	14' 0"	18,453 SF
7	AVAILABLE	N/A	DROP CEILING	12,100 SF
8	AVAILABLE	6	25' 0"	66,934 SF
<b>TOTAL</b>				<b>186,359 SF</b>

[VIEW A MATTERPORT WALK-THROUGH](#)



# LOCATION MAP

1555 IL ROUTE 75 E | FREEPORT, IL

<b>ROCKFORD</b>	30 MILES
<b>I-90</b>	38 MILES
<b>I-49</b>	42 MILES
<b>CHICAGO</b>	114 MILES
<b>MILWAUKEE</b>	115 MILES

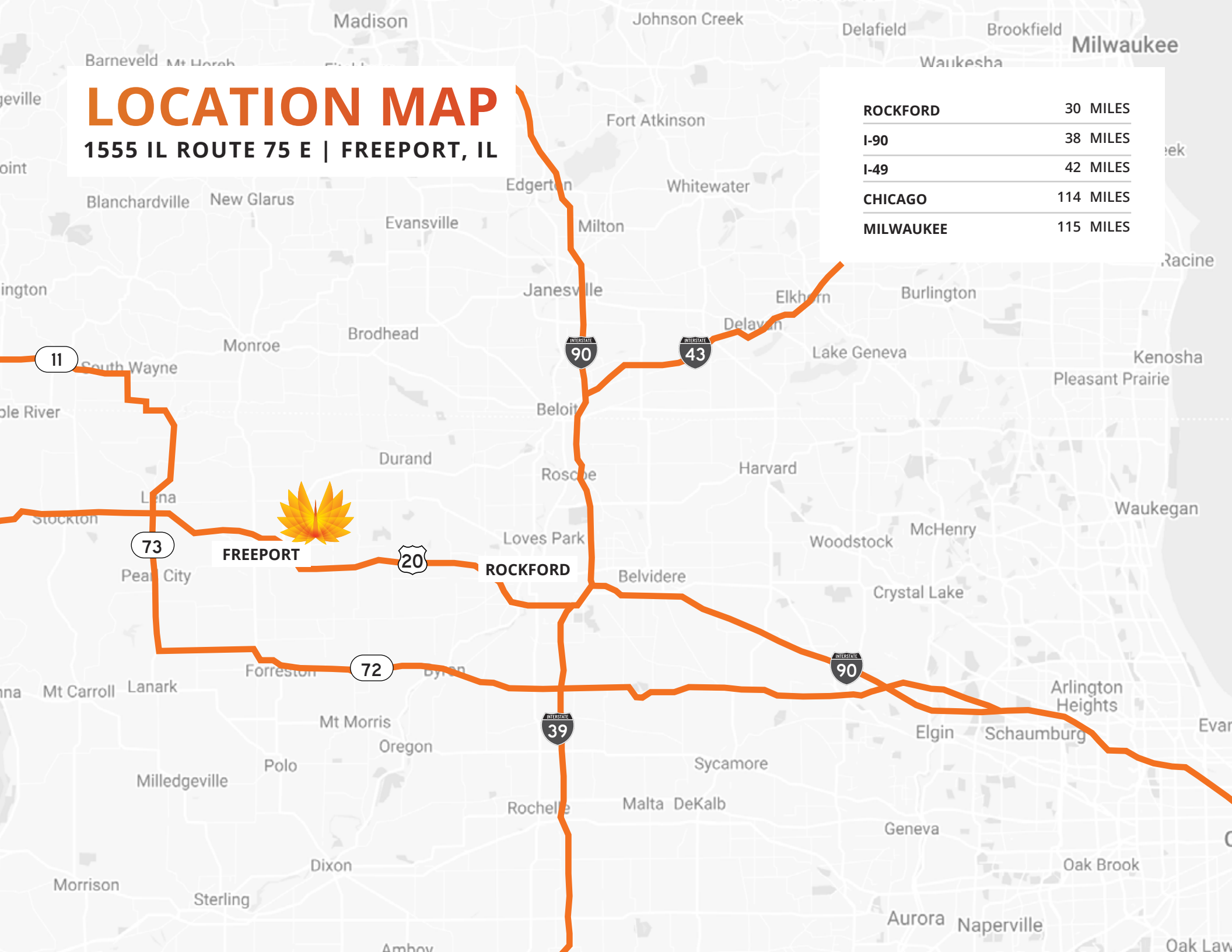



**FOR LEASE** | **186,359 SF**  
**1555 IL ROUTE 75 E** | **FREEMONT, IL**

**ANTHONY CRIVELLO** 414-982-4810 | [ANTHONY@PHOENIXINVESTORS.COM](mailto:ANTHONY@PHOENIXINVESTORS.COM)  
**LUKE HERDER** 414-244-9575 | [LHERDER@PHOENIXINVESTORS.COM](mailto:LHERDER@PHOENIXINVESTORS.COM)



**PHOENIX**  
**INVESTORS**

*Opportunity. Execution. Value Creation.*