

1305 NW 18th Ave.

FOR LEASE



Ben Herman | (503) 276-7197 | [ben@madfishdigital.com](mailto:ben@madfishdigital.com)



# 1305 NW 18th Ave.

**FOR LEASE**

Modern updates in a prime Slab Town/Alphabet District location. Great mix of open creative for cubes or flexible set-up, enclosed offices, and conference areas. Private Balcony & Atrium provide ample natural light. 1 block from street car line. Close proximity to New Seasons, shops on NW 23rd and 21st. Permitted street parking is available from the city. After hours security patrol. Biker's score = 98; Walker's score = 96



## **PROPERTY INFORMATION**

<b>Base Lease Rate:</b>	<b>\$23/SF</b>
-------------------------	----------------

<b>Building Size:</b>	<b>6045 SF</b>
-----------------------	----------------

<b>Minimum divisible:</b>	<b>2900 SF</b>
---------------------------	----------------

<b>Maximum contiguous:</b>	<b>6045 SF</b>
----------------------------	----------------

<b>NNN:</b>	<b>\$5/SF</b>
-------------	---------------





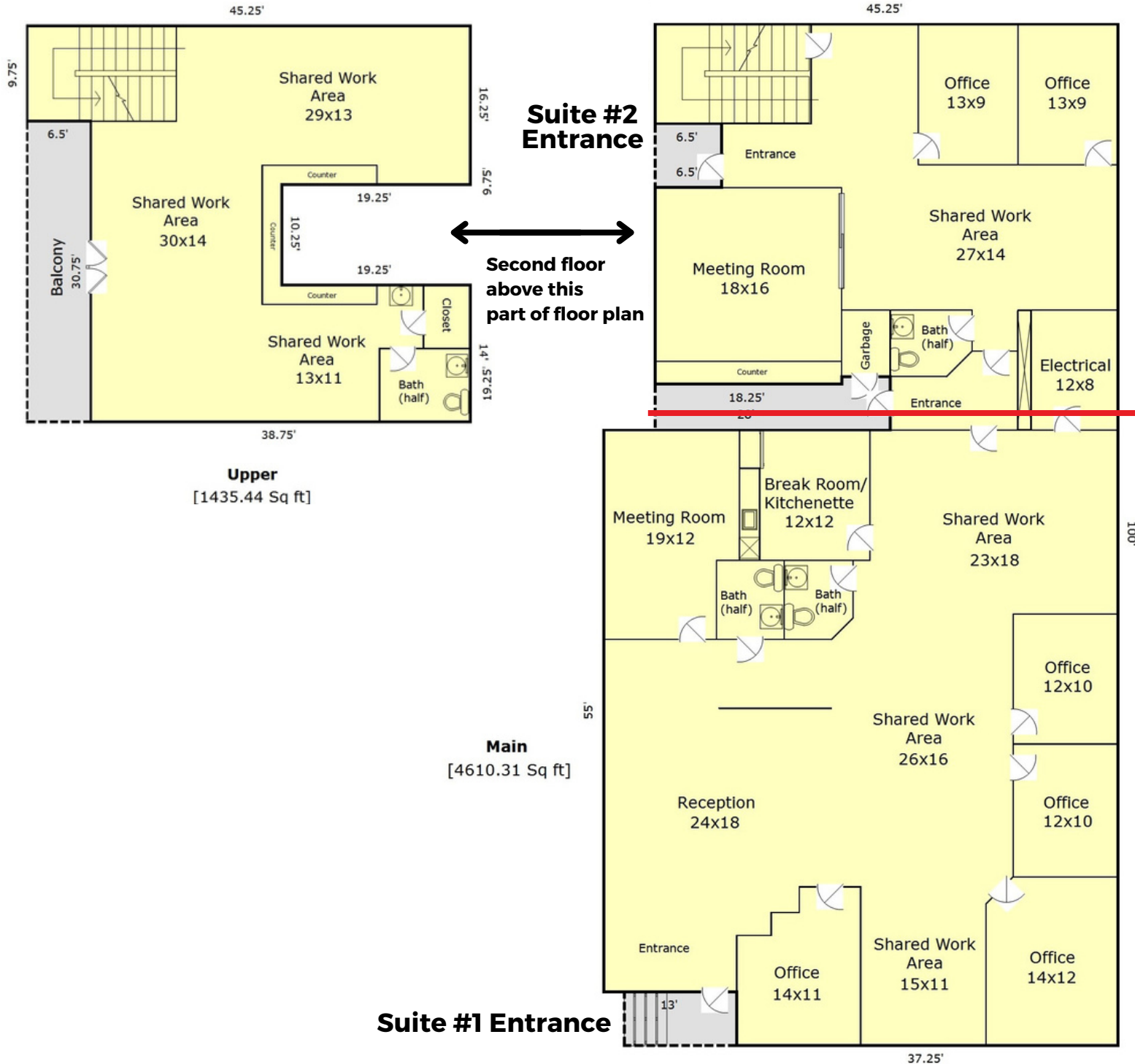



# 1305 NW 18th Ave.

AREA MAP

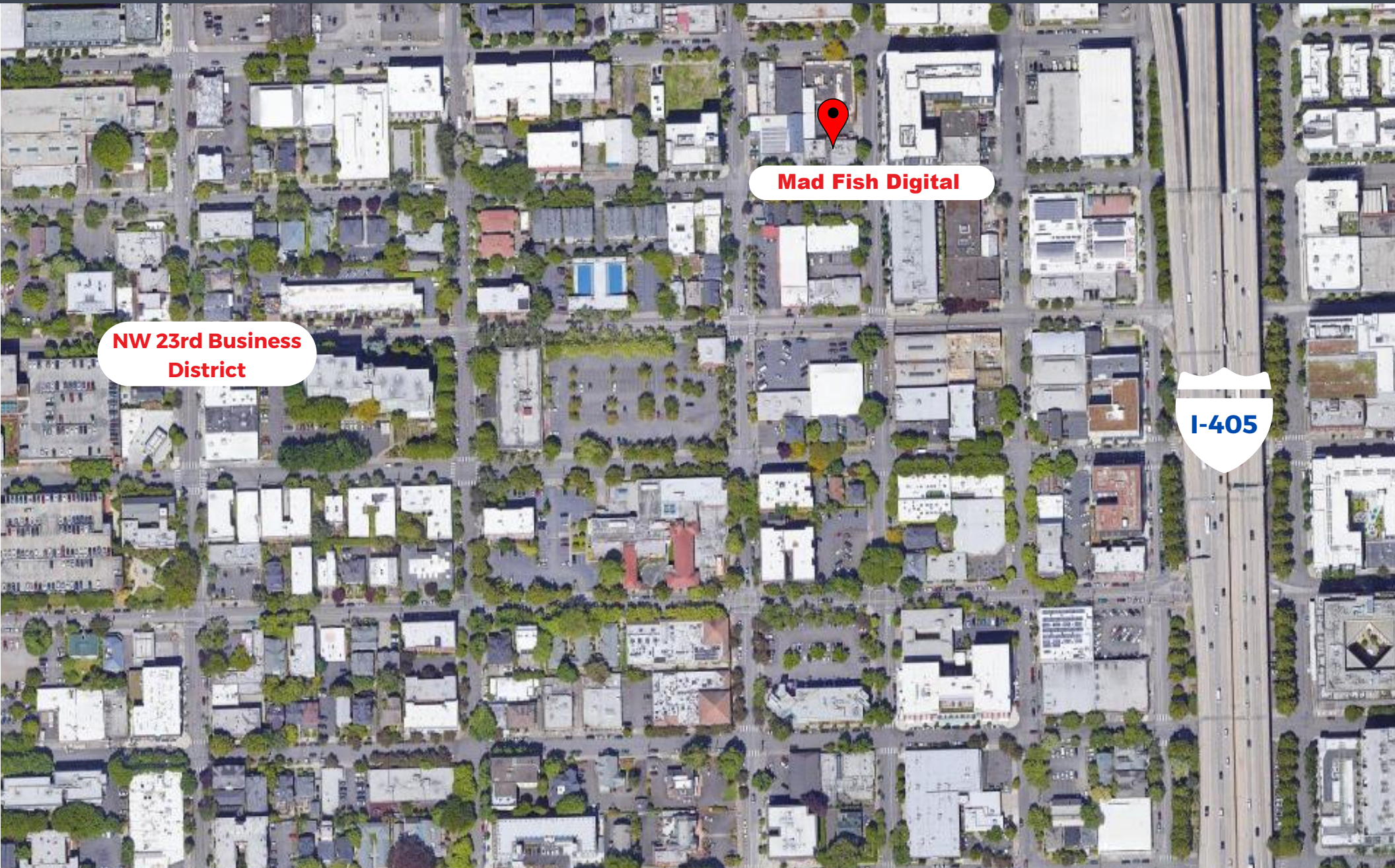

Ben Herman | (503) 276-7197 | [ben@madfishdigital.com](mailto:ben@madfishdigital.com)



# 1305 NW 18th Ave.

## AREA MAP

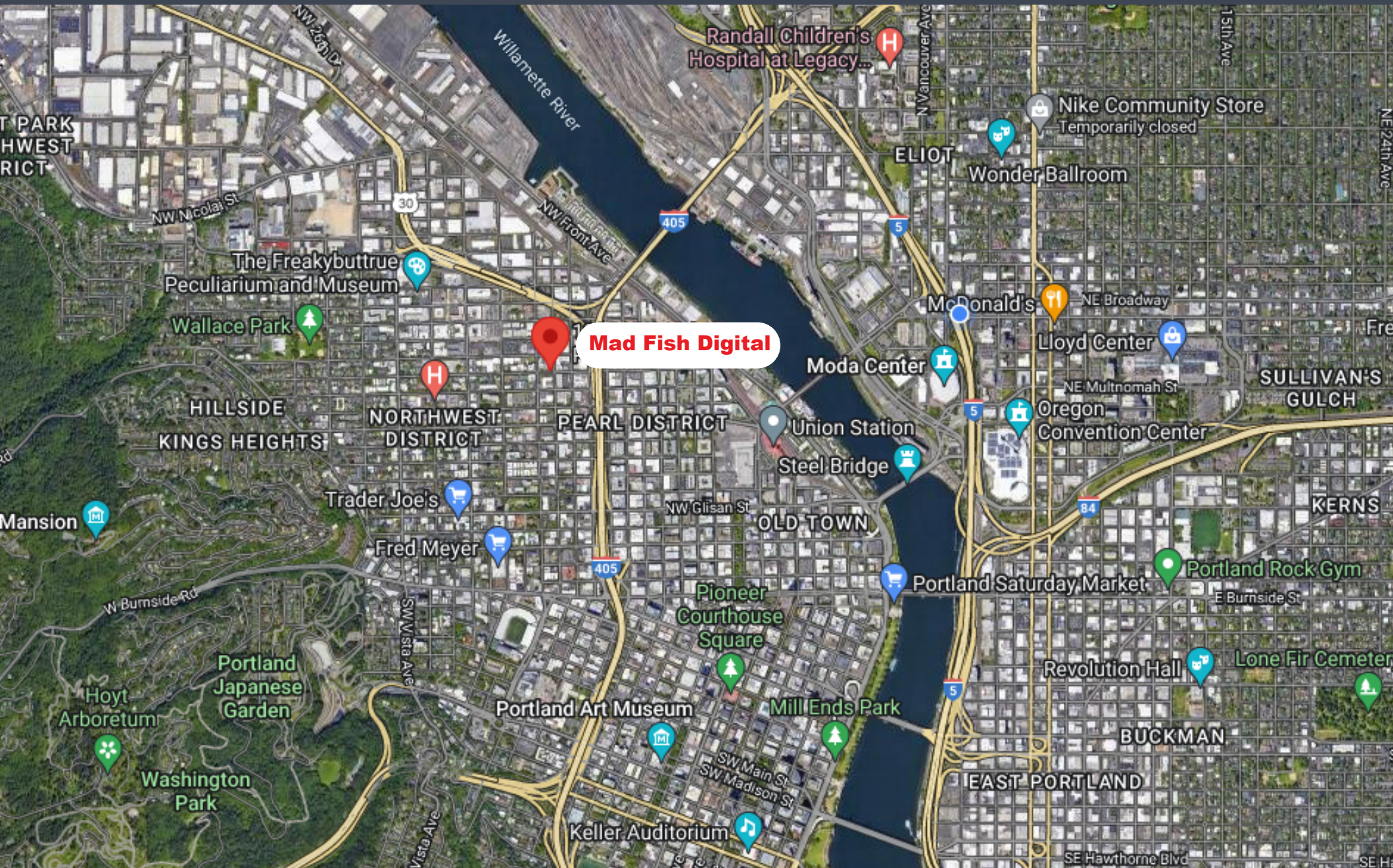

Ben Herman | (503) 276-7197 | [ben@madfishdigital.com](mailto:ben@madfishdigital.com)