



FOR LEASE

# *Airport Center*

3049 UALENA STREET | HONOLULU, HI 96819



CUSHMAN &  
WAKEFIELD

ChaneyBrooks





## ABOUT THE BUILDING

The Airport Center is the only high-rise office building located in close proximity to the Daniel K. Inouye International Airport, H1 freeway, and only about 4 miles (roughly a 15 minute drive) from Honolulu's Central Business District. It has unobstructed views of the mountains and the oceans. Full height windows on higher floors have double pane glass to help insulate the sound of the airport traffic while allowing for views of airport activity, the ocean, and the mountains.

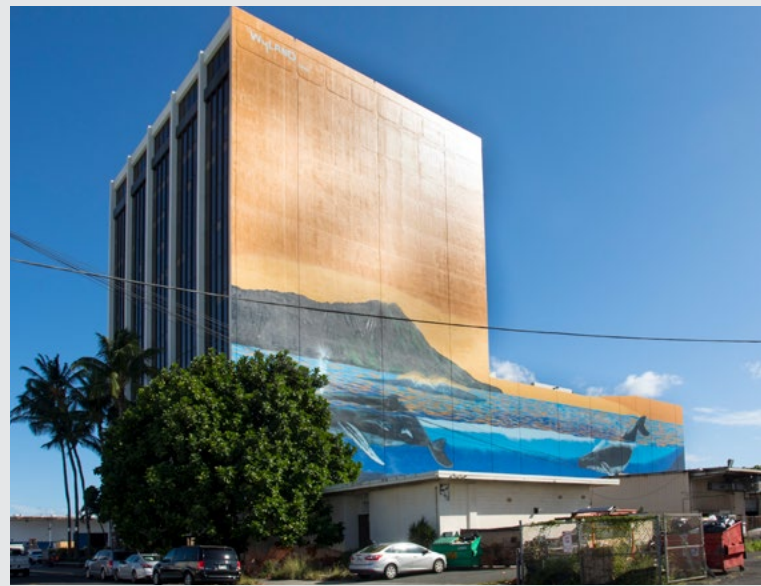





## PARKING RATES

MONTHLY RATES INCL. GET	TYPE	STATUS
\$120.94 - \$138.22	SINGLE	UNRESERVED
\$163.28 - \$186.60	SINGLE	RESERVED
\$181.41 - \$207.33	TANDEM	RESERVED
\$151.18 - \$172.78	TANDEM	ROOF
100 STAMPS PER BOOK HOURLY RATES	DURATION	STATUS
\$98.17	15 MIN	ORANGE
\$196.34	30 MIN	YELLOW
\$392.67	1 HOUR	GREEN

## BUILDING INFORMATION

-  On-site Property Management
-  Suites available from 557 RSF - 8,138
-  1 Conference room available at no charge equipped with WiFi and TV monitor
-  Convenience store on the ground floor with various food establishments nearby
-  2025 OpEx Rent: \$1.96/SF/mo.
-  Base Rent: Call for more information
-  7 floors of secured parking  
Parking Ratio: 1/500 RSF

## ENERGY EFFICIENT UPGRADES COMPLETED IN 2020

- » High efficiency lighting
- » Daylighting sensors
- » Cooling tower fan VFD
- » Other sensors and controllers to create more comfortable suites while reducing energy consumption
- » Projected building energy reduction: ~24%

*\*\*\*Free rent incentives available for LOIs signed by year-end! Schedule a tour today and contact us for more details.\*\*\**

**AC Hours:** M-F: 6am - 6pm,  
SAT: 8am - 4pm, SUN: OFF  
**Building Hours:** M-F: 8am - 6pm,  
SAT: 8am - 2pm, SUN: CLOSED

*Airport Center*

3049 UALENA STREET



FOR LEASE

# Airport Center

3049 UALENA STREET

## CONTACT ME

### DANKA FABIANKOVICOVA (S)

Vice President

+1 808 544 1820

[dfabiankovicova@chaneybrooks.com](mailto:dfabiankovicova@chaneybrooks.com)



CUSHMAN &  
WAKEFIELD

ChaneyBrooks

1440 KAPIOLANI BLVD., SUITE 1010 | HONOLULU, HI 96814 | MAIN +1 808 544 1600 | FAX +1 808 544 9574

©2025 CUSHMAN & WAKEFIELD CHANEYBROOKS. NO WARRANTY OR REPRESENTATION, EXPRESS OR IMPLIED, IS MADE TO THE ACCURACY OR COMPLETENESS OF THE INFORMATION CONTAINED HEREIN, AND SAME IS SUBMITTED SUBJECT TO ERRORS, OMISSIONS, CHANGE OF PRICE, RENTAL OR OTHER CONDITIONS, WITHDRAWAL WITHOUT NOTICE, AND TO ANY SPECIAL LISTING CONDITIONS IMPOSED BY THE PROPERTY OWNER(S). AS APPLICABLE, WE MAKE NO REPRESENTATION AS TO THE CONDITION OF THE PROPERTY (OR PROPERTIES) IN QUESTION.