



# VERANDA PLAZA

1800 S. Bonito Way, Meridian, ID 83642  
73,734 Square Feet Class A Office Building



**Call: 208-322-7300**

[WWW.SUNDANCECO.COM](http://WWW.SUNDANCECO.COM)





# VERANDA PLAZA, in El Dorado Business Campus

1800 S. BONITO WAY, MERIDIAN, ID 83642



## PROPERTY FEATURES

BLDG TYPE: Class A Office Space

BLDG SIZE: 73,734 Square Feet

FLOORS: Three (3) Floors

PARKING: Includes 5/1,000 SF Parking

LEASE TYPE: Full Service, Less Tenant Janitorial

ZONING: CC

## SPACE DETAILS

|            |                   |     |
|------------|-------------------|-----|
| AVAILABLE: | 6,000 & 11,800 SF | 1st |
|            | 6,305 SF          | 2nd |
|            | 15,800 SF         | 3rd |

LEASE TYPE: Full Service  
Less Tenant Janitorial

TERM: 7-10 year lease

SPACE PLAN: Landlord will provide custom  
test fit

## LOCATED



**Call: 208-322-7300**

[WWW.SUNDANCECO.COM](http://WWW.SUNDANCECO.COM)



# VERANDA PLAZA, in El Dorado Business Campus

1800 S. BONITO WAY, MERIDIAN, ID 83642



---

**Call: 208-322-7300**

[WWW.SUNDANCECO.COM](http://WWW.SUNDANCECO.COM)





# VERANDA PLAZA, in El Dorado Business Campus

1800 S. BONITO WAY, MERIDIAN, ID 83642



## BUILDING HIGHLIGHTS

- Newest office project in El Dorado Business Park
- Overland Road frontage
- Eagle Road access and exposure
- Fiber ready building
- Contemporary high end finishes throughout
- Building signage available
- Multiple access points including traffic controlled intersection on Eagle Road
- Centrally located in the Boise Valley, convenient access I-84 (Exit 46) less than one mile
- Close proximity to abundant restaurants, daycares, and retail services in immediate area

**Call: 208-322-7300**

[WWW.SUNDANCECO.COM](http://WWW.SUNDANCECO.COM)



# VERANDA PLAZA, in El Dorado Business Campus

1800 S. BONITO WAY, MERIDIAN, ID 83642

## FLOOR 1- As Built

## AVAILABLE SPACES

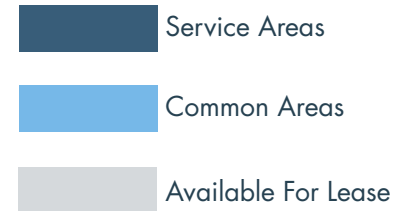
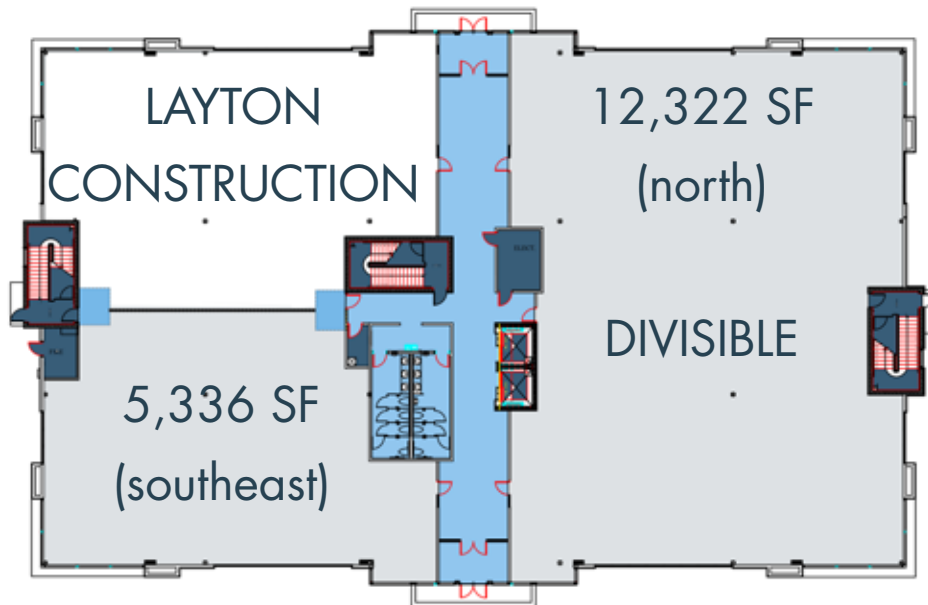

ALL MEASUREMENTS ARE APPROXIMATE AND WILL BE VERIFIED PRIOR TO LEASE EXECUTION

**Call: 208-322-7300**

[WWW.SUNDANCECO.COM](http://WWW.SUNDANCECO.COM)



# VERANDA PLAZA, in El Dorado Business Campus

1800 S. BONITO WAY, MERIDIAN, ID 83642

## FLOOR 2- As Built

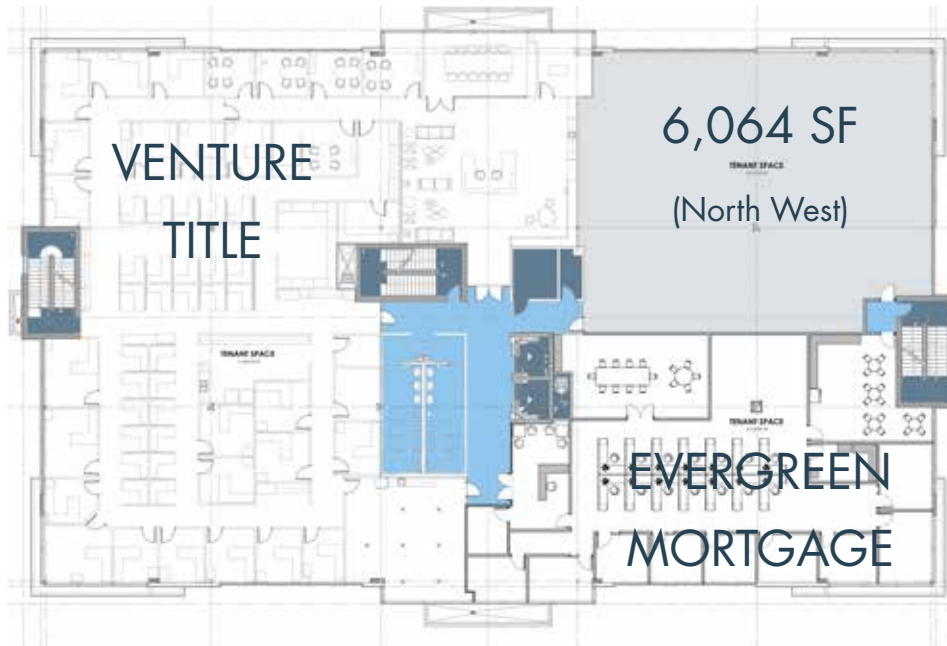

## AVAILABLE SPACES

- Service Areas
- Common Areas
- Available For Lease

## FLOOR 3- As Built

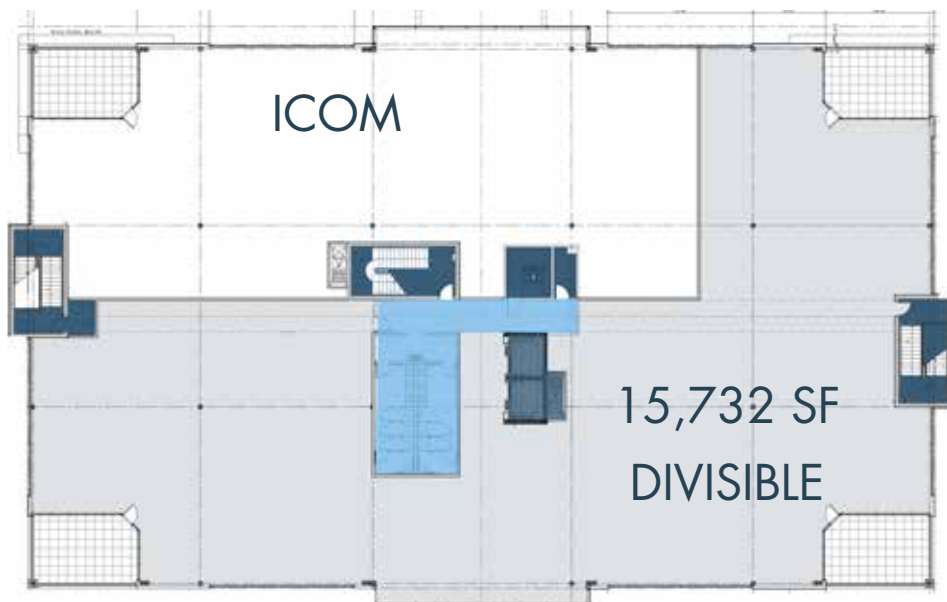

## AVAILABLE SPACES

- Service Areas
- Available For Lease
- Private Balconies, square footage included in premise

ALL MEASUREMENTS ARE APPROXIMATE AND WILL BE VERIFIED PRIOR TO LEASE EXECUTION

**Call: 208-322-7300**

[WWW.SUNDANCECO.COM](http://WWW.SUNDANCECO.COM)





# VERANDA PLAZA, in El Dorado Business Campus

1800 S. BONITO WAY, MERIDIAN, ID 83642

Silverstone and El Dorado Parks provide abundant access points which substantially affects ease of access to and from your business. Our developments are nearly completely built out and you will find excellent internal traffic flow.

## EL DORADO BUSINESS PARK

Eight (8) Traffic Outlets

One (1) Traffic Light Controlled

## SILVERSTONE PARK

Twelve (12) Traffic Outlets

Two (2) Traffic Light Controlled



**Call: 208-322-7300**

[WWW.SUNDANCECO.COM](http://WWW.SUNDANCECO.COM)



# VERANDA PLAZA, in El Dorado Business Campus

1800 S. BONITO WAY, MERIDIAN, ID 83642

## PROPERTY SUMMARY

Veranda Plaza building offers customizable Class A office space in a convenient, easily accessible location in the center of the Boise Valley.

Located in the City of Meridian, in the El Dorado Business Campus, ½ mile south of Interstate 84 (exit 46). Multiple access points, including the signalized intersection of Goldstone Way and Eagle Road, a major north-south commercial arterial in the region.

The El Dorado Business Campus features dual redundancy fiber to ensure uninterrupted, reliable connections. As well as close proximity to Valley Region Transit bus routes and Commute Ride-Club van pool.

The site's central location, with a population of approximately 200,000 within a five-mile radius, ensures a wide variety of amenities within a close vicinity.

Please contact us for more information on this location or additional properties owned and managed by Sundance in the immediate area.

---

**Call: 208-322-7300**

[WWW.SUNDANCECO.COM](http://WWW.SUNDANCECO.COM)

