

AVAILABLE
Ground - 3,887 sf

LEASED

LEASED

200 PARK AVENUE SOUTH

FACING UNION SQUARE PARK @ EAST 17TH STREET

PREMIER UNION SQUARE - RETAIL OPPORTUNITY - 3,887 SF



**Available
Ground - 3,887 sf**

LEASED

LEASED

	Available
Ground	3,887 sf
Frontage	37 ft
Previously	Sephora
Ceiling Heights	16ft

Comments

- Owner will install ventilation for restaurant use
- Union Square is one of the busiest shopping districts in Manhattan
- Outstanding location with tremendous foot traffic and direct access to the Union Square Transit Hub, the 4th busiest subway station in NYC
- Neighbors Include: Barnes & Noble, Petco, W-Hotel, CVS, Verizon, NYU, Union Square Cafe, Whole Foods, Sephora, Crate & Barrell and Venchi
- Union Square Farmers Market with 60,000 daily shoppers

Mark Tergesen | 212-400-9528 | mt@absre.com
Cooper Katz | 646-439-2009 | ckatz@absre.com



L 4 5 6
N Q R W
UNION SQUARE

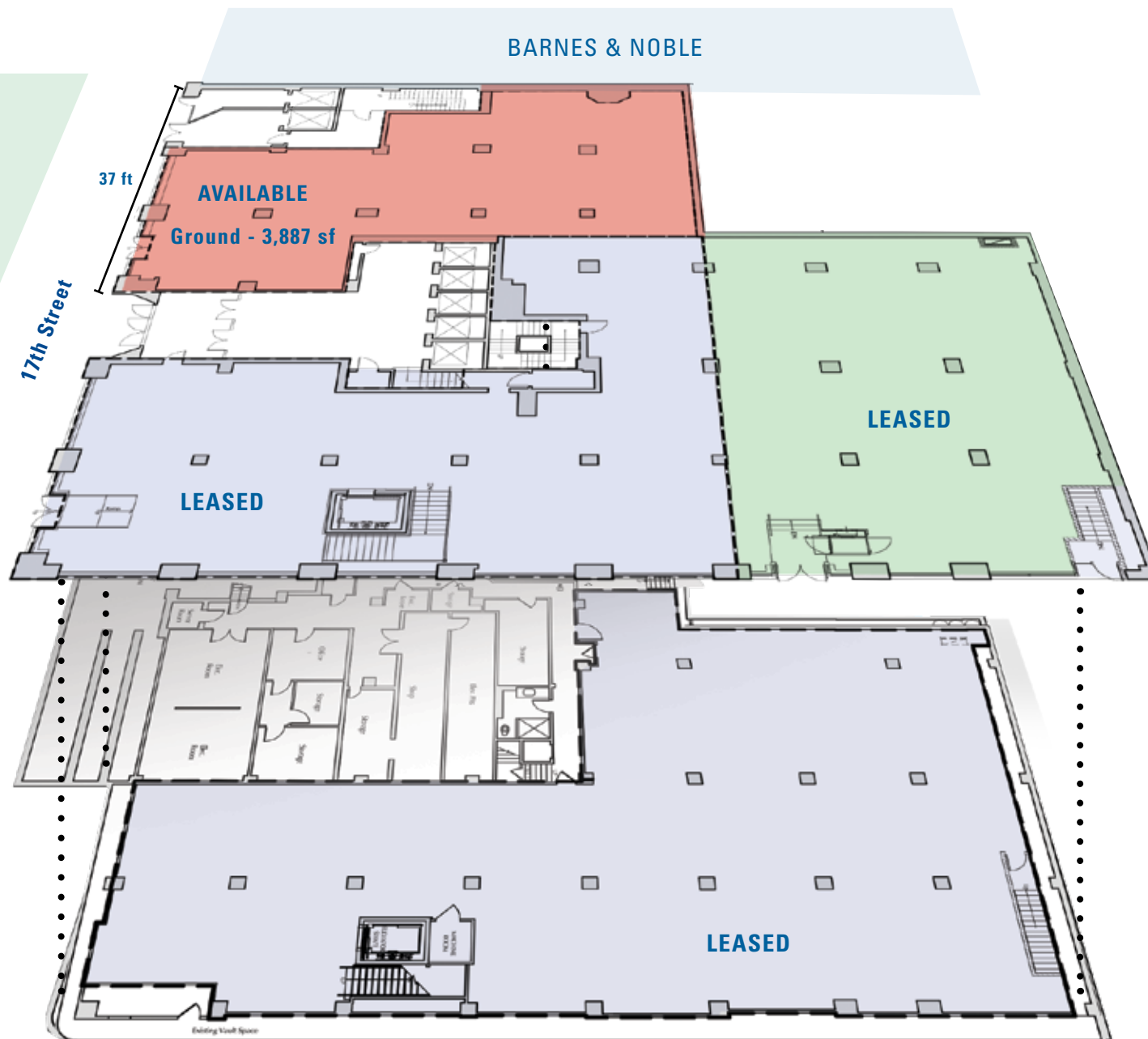

Park Avenue South

Mark Tergesen | 212-400-9528 | mt@absre.com
Cooper Katz | 646-439-2009 | ckatz@absre.com

All information is from sources deemed reliable but is subject to errors or omissions of any magnitude, withdrawal from market, or changes in terms, all without notice. Brokers employment and payment only by written agreement.

Floor Plans Not to Scale



THE TECH & LIFESTYLE HUB

"Union Square is the top NYC destination for residents, employees, students and tourists."

"Steps from NYU, The New School, Benjamin N. Cardozo School of Law and Parsons School of Design."

