

FOR LEASE

CENTER COURT PROFESSIONAL BUILDING

±1,200 – ±32,000 SF AVAILABLE



COMMERCIAL REAL ESTATE SERVICES
PASADENA



**1373 Center Court Dr
Covina, CA 91724**

CHRIS JOHNSON

chris.johnson@lee-associates.com

626.240.2786

License ID 01934154

CHRISTOPHER LARIMORE

clarimore@lee-associates.com

626.240.2788

License ID 01314464

VINCENT MOLITOR

vmolitor@lee-associates.com

626.240.2787

License ID 01295360

All information furnished regarding property for sale, rental or financing is from sources deemed reliable, but no warranty or representation is made to the accuracy thereof and same is submitted to errors, omissions, change of price, rental or other conditions prior to sale, lease or financing or withdrawal without notice. No liability of any kind is to be imposed on the broker herein.

LEASE INFORMATION

+ Lease Rate:	\$1.75/PSF/FSG*
+ Available Size:	±1,200 SF – ±32,000 SF
+ Building Size:	±32,000 SF
+ Lot Size:	±72,934 SF
+ Year Built:	1979
+ Parking Ratio:	4.35/1,000
+ Parcel Number:	8447-021-072, 031-047
+ Zoning:	C-P

*Advertised lease rate is for a lease term of under two years with no TI Allowance.

PROPERTY HIGHLIGHTS

- + Great Owner User Opportunity
- + Medical and Dental Use Allowed
- + Recent Upgrades Throughout
- + Abundant Parking
- + Elevator Served
- + Fully Sprinklered
- + Great Access to 10, 57 and 210 freeways
- + Located right off the Holt exit on the 10 freeway



FOR LEASE
OFFICE | MEDICAL OFFICE IN COVINA

1373
CENTER COURT DRIVE
COVINA, CA 91724

AERIAL PHOTOS



FOR LEASE
OFFICE | MEDICAL OFFICE IN COVINA

1373
CENTER COURT DRIVE
COVINA, CA 91724

PROPERTY LOCATION

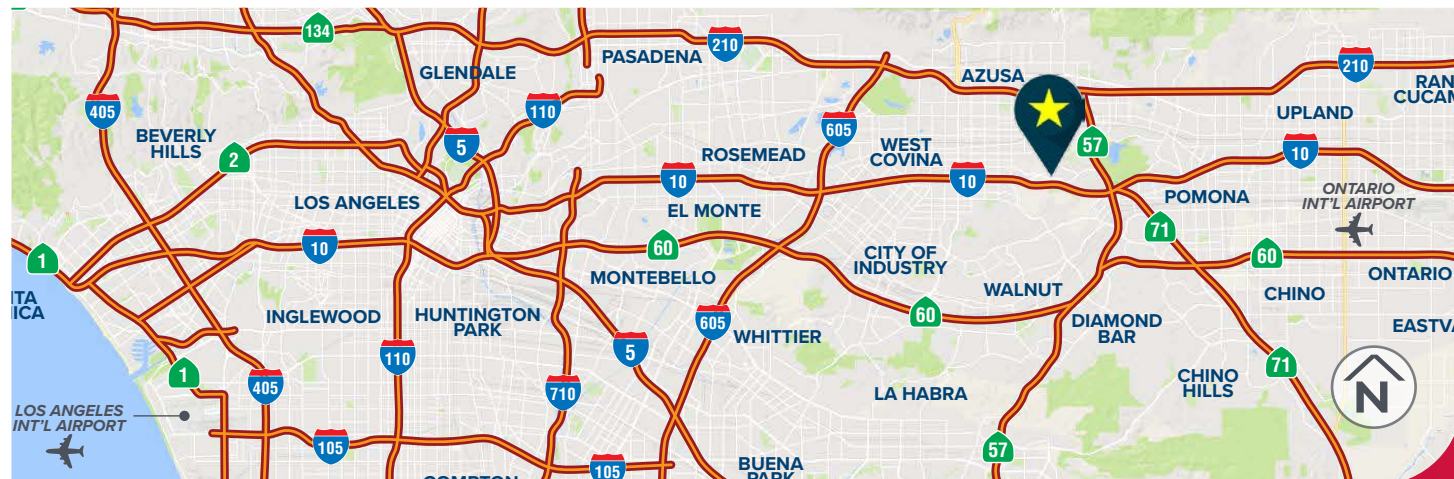
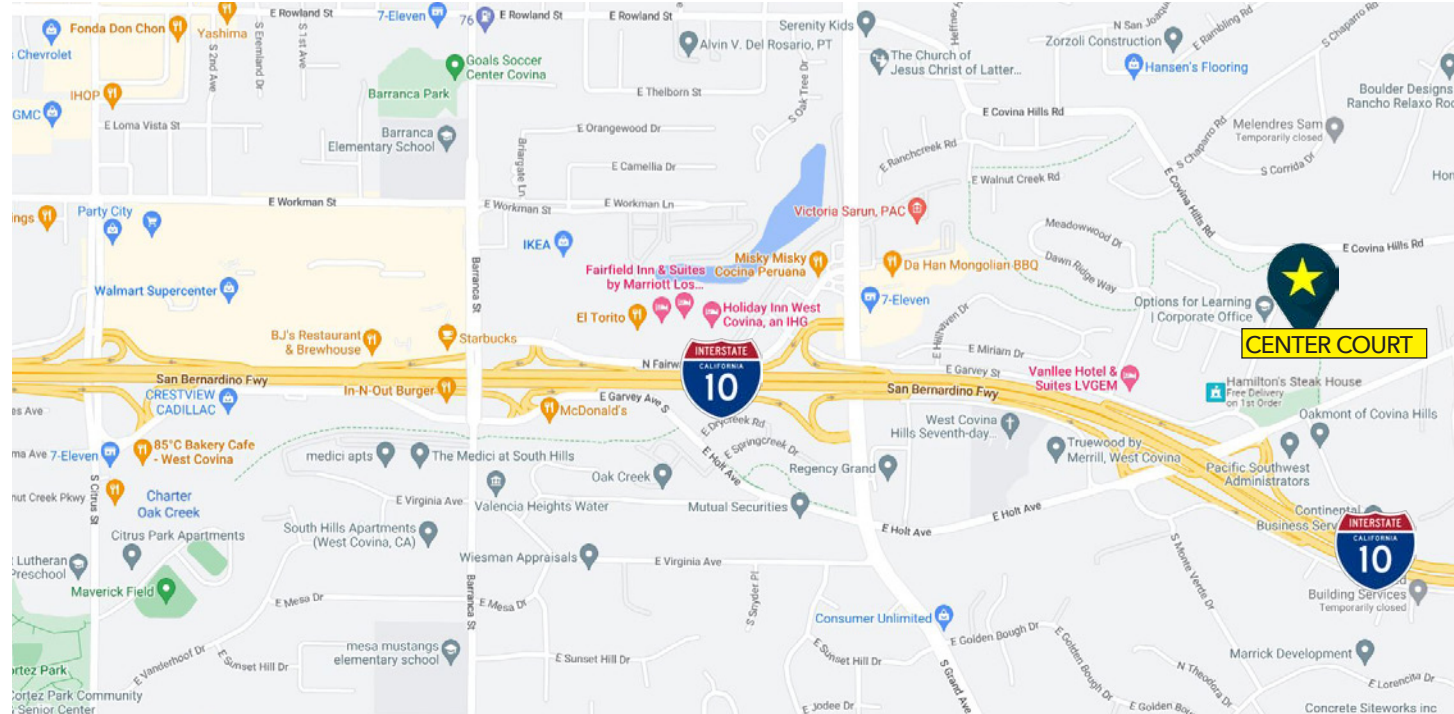

FOR LEASE
OFFICE | MEDICAL OFFICE IN COVINA

1373
CENTER COURT DRIVE
COVINA, CA 91724

1ST FLOOR PHOTOS



FOR LEASE
OFFICE | MEDICAL OFFICE IN COVINA

1373
CENTER COURT DRIVE
COVINA, CA 91724

2ND FLOOR PHOTOS



1ST FLOOR - FLOOR PLAN

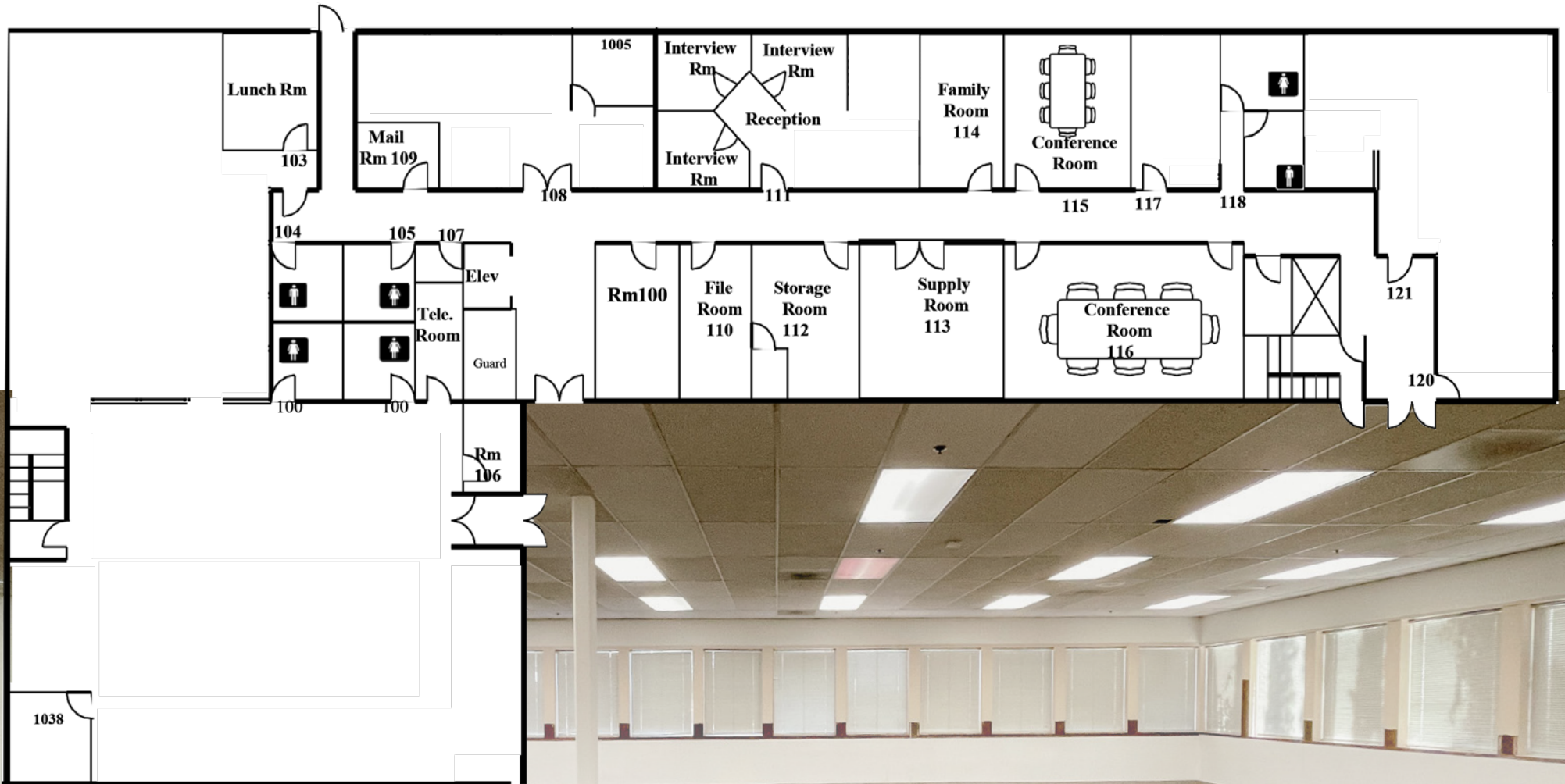

2ND FLOOR - FLOOR PLAN

