

# 10131 IRON ROCK WAY

ELK GROVE, CA

± 4,000 SF FREESTANDING  
INDUSTRIAL BUILDING  
W/YARD

AVAILABLE  
FOR  
LEASE



**NEWMARK**

**MIKE SMITH**

*Director*

916.569.2352

mike.smith@nrmk.com

CA RE License #01504428

**COLE CUMMINGS**

*Associate Director*

916.569.2366

cole.cummings@nrmk.com

CA RE License #02106833

**IRINA SHPYRKA**

*Associate*

916.477.7384

irina.shpyrka@nrmk.com

CA RE License #02037207

# PROPERTY HIGHLIGHTS



- > ±4,000 SF Freestanding Industrial Building
- > ±1,000 SF Office Space
- > Two (2) Grade Level Doors
- > 19' Clear Height
- > ±3,500 SF of Yard Area
- > Situated on ±0.29 AC
- > Built in 2005
- > Zoned M1
- > 480-Volt Power

# FLOOR PLAN

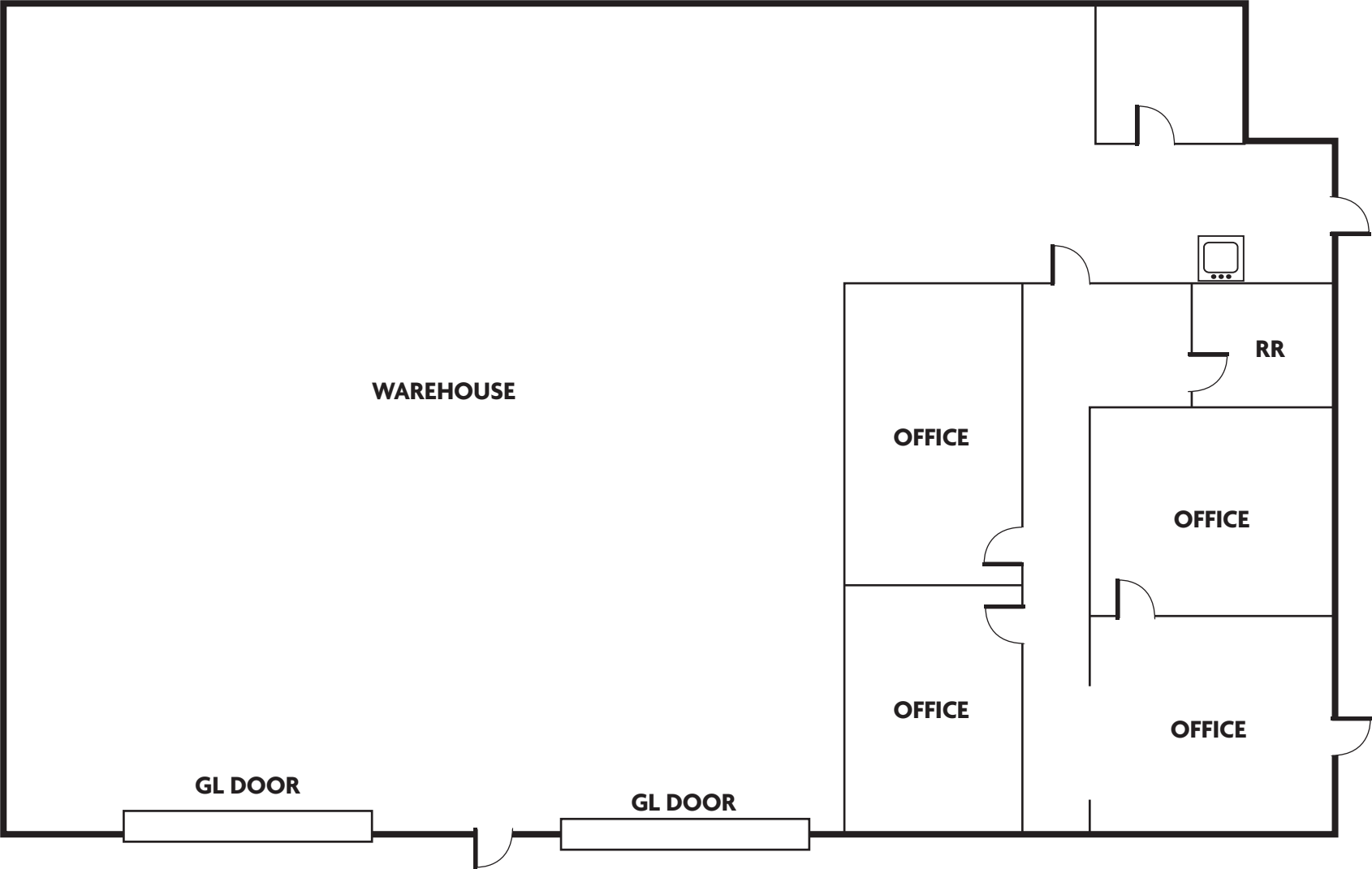



99

5

10131 IRON ROCK WAY

amazon

CALIBER  
COLLISION

Kubota

SKY RIVER  
CASINO

980 9th Street, Suite 2500, Sacramento, CA 95814 T. 916.569.2352

The information contained herein has been obtained from sources deemed reliable but has not been verified and no guarantee, warranty or representation, either express or implied, is made with respect to such information. Terms of sale or lease and availability are subject to change or withdrawal without notice. 3/26

**NEWMARK**

**MIKE SMITH**  
*Director*  
916.569.2352  
mike.smith@nmrk.com  
CA RE License #01504428

**COLE CUMMINGS**  
*Associate Director*  
916.569.2366  
cole.cummings@nmrk.com  
CA RE License #02106833

**IRINA SHPYRKA**  
*Associate*  
916.477.7384  
irina.shpyrka@nmrk.com  
CA RE License #02037207