

INDUSTRIAL BUILDING FOR LEASE



NAI Highland

**2455 Executive Circle
Colorado Springs, CO 80907**

PROPERTY SPECIFICATIONS

Building Size: **± 24,539 SF**

Land Area: **73,102 Square Feet (1.68 Acres)**

Loading Doors:

- Four (4) Ground Level 10'x12'
- Two (2) Dock-High

Ceiling Height: **14'**

Buildout: **Office/Assembly/Warehouse
30% Office | 70% Warehouse (est.)**

Zoning: **BP (Business Park)**

Parking: **Approximately 67 Spaces**

Power: **2000 Amp | 480 Volt (est.)**

Lease Rate: **\$12.50 PSF, NNN**

- Great Location at I-25 & South Circle
- Very Clean Manufacturing Warehouse
- First time Available in 25+ years!
- Fire Sprinklers
- Radiant & Unit Heaters
- Evaporative Cooling in Warehouse
- Two Sets of restrooms



John Onstott | Principal

 719.330.1819

 onstott@highlandcommercial.com

FLOORPLAN | ± 24,539 SF Available

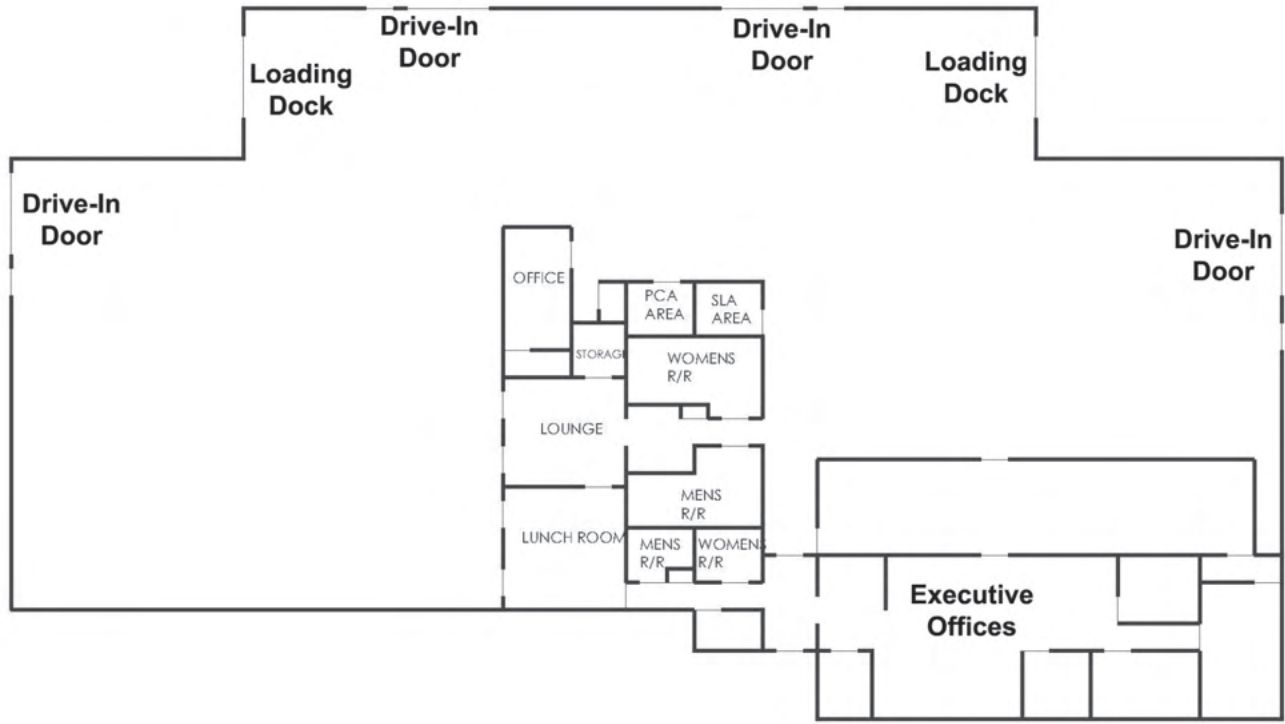

NAI Highland

📍 2 N Cascade Ave. Suite 300, Colorado Springs, CO 80903

☎ 719.577.0044

🌐 www.highlandcommercial.com

NO WARRANTY OR REPRESENTATION, EXPRESS OR IMPLIED, IS MADE AS TO THE ACCURACY OF THE INFORMATION CONTAINED HEREIN, AND THE SAME IS SUBMITTED SUBJECT TO ERRORS, OMISSIONS, CHANGE OF PRICE, RENTAL OR OTHER CONDITIONS, PRIOR SALE, LEASE OR FINANCING, OR WITHDRAWAL WITHOUT NOTICE, AND OF ANY SPECIAL LISTING CONDITIONS IMPOSED BY OUR PRINCIPALS NO WARRANTIES OR REPRESENTATIONS ARE MADE AS TO THE CONDITION OF THE PROPERTY OR ANY HAZARDS CONTAINED THEREIN ARE ANY TO BE IMPLIED. THE ABOVE INFORMATION WHILE NOT GUARANTEED WAS SECURED FROM SOURCES WE BELIEVE TO BE RELIABLE.