



FOR LEASE
244 Oxmoor Court
Birmingham, AL

OXMOOR SOUTH INDUSTRIAL PARK



34,100 SF FULLY RENOVATED WAREHOUSE

Oxmoor Valley Submarket of Birmingham

Lease Rate: \$7.95 / SF (NNN)

For more information, please contact:

BRAD MOFFATT, SIOR
Vice President, SIOR
+1 205 314 5509
bmoffatt@egsinc.com

ADAM EASON
Vice President
+1 205 314 5530
aeason@egsinc.com

2100 3rd Avenue North, Suite 700
Birmingham, AL 35203
phone: +1 205 939 4440
egsinc.com

SCAN HERE

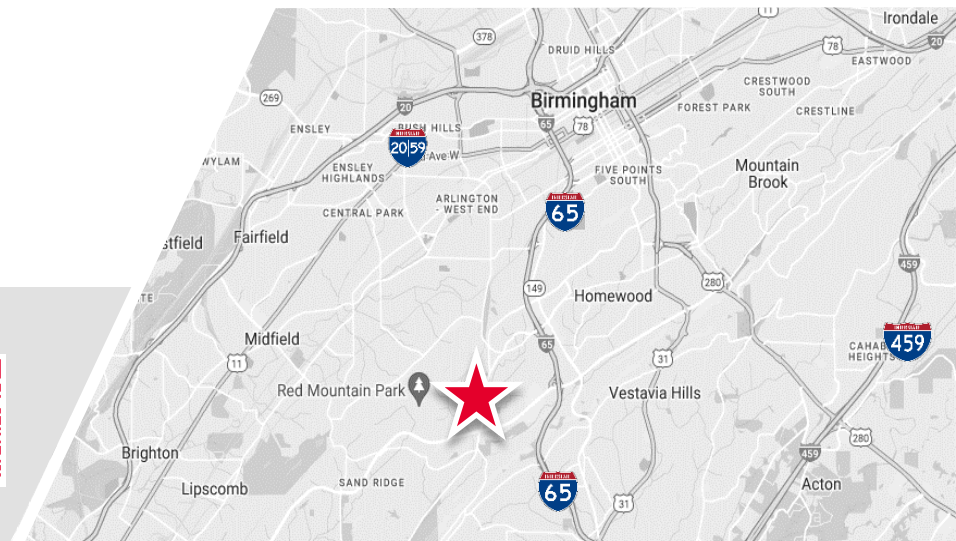

PROPERTY HIGHLIGHTS

- Four (4) bulk distribution buildings totaling ±530,000 SF
- Centrally located bulk warehouse spaces
- Concrete tilt-up construction
- Dock-high and grade-level loading
- Quick access to I-65, West Oxmoor Road and Lakeshore Parkway

Site Plan

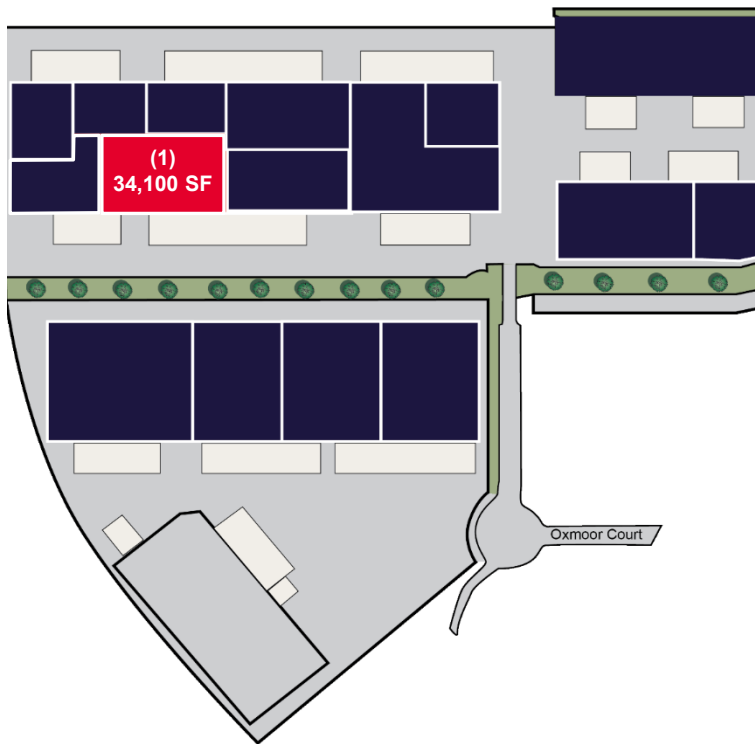

Floor Plan

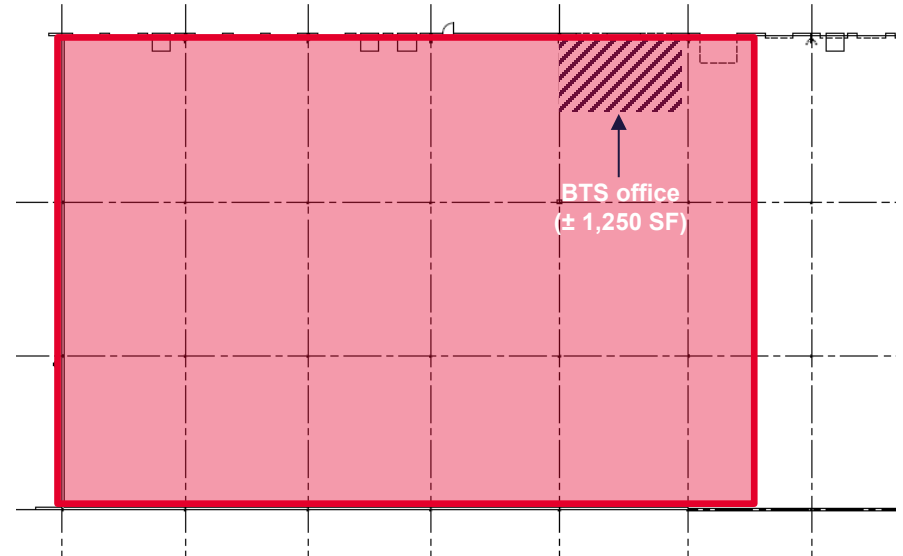

Ref	Size	Office SF	Rate (NNN)	Column Spacing	Ceiling Height	Sprinkler	Loading
1	34,100 SF	BTS (1,250 SF planned)	\$7.95 psf (nnn)	40' x 50'	24'	Wet	(9) dock-high (1) grade level

Independently Owned and Operated / A Member of the Cushman & Wakefield Alliance

Cushman & Wakefield Copyright 2025. No warranty or representation, express or implied, is made to the accuracy or completeness of the information contained herein, and same is submitted subject to errors, omissions, change of price, rental or other conditions, withdrawal without notice, and to any special listing conditions imposed by the property owner(s). As applicable, we make no representation as to the condition of the property (or properties) in question.