



# Flex Manufacturing Building For Lease

3010 E Elwood St | Phoenix, AZ

Contact us for leasing information:

**Paul Sieczkowski SIOR**

Senior Executive Vice President

+1 602 222 5085

[paul.sieczkowski@colliers.com](mailto:paul.sieczkowski@colliers.com)

**Justin Sieczkowski**

Vice President

+1 602 222 5155

[justin.sieczkowski@colliers.com](mailto:justin.sieczkowski@colliers.com)

**Colliers**

2390 E Camelback Rd, Ste 100

Phoenix, AZ 85016

+1 602 222 5000



# Flex Manufacturing Building For Lease

3010 E Elwood St | Phoenix, AZ

## Property Features

Location	3010 E Elwood St, Phoenix, AZ
Building Size	±61,344 sf
Site	±4.40 acres
Office	±9,000 sf
Divisibility	(±16,392 sf - ±61,344 sf)
Zoning	A-2, City of Phoenix
Loading	7 grade level doors and potential double truckwell on east end of building
Power	3,000A 277/480V 3-Phase (dropped to work station in warehouse)
Clear Height	20' - 24'
Warehouse	100% air conditioned
Yard	Gated secured yard
Parking	±141 spaces
Occupancy	Immediate
Column Spacing	42' x 50'
Layout	Reception area, 18 offices, 3 conference rooms, 2 break rooms, 3 bull pens, 5 restrooms and warehouse.



## Location Highlights

- Freeway visibility | ±300,000 vehicles per day
- Minutes from Sky Harbor International Airport and Arizona State University (Tempe)
- Ideal Central Phoenix location with access to all areas of the Valley.

**Lease Rate**      **\$1.33 NNN**



# Floor Plan

3010 E Elwood St | Phoenix, AZ

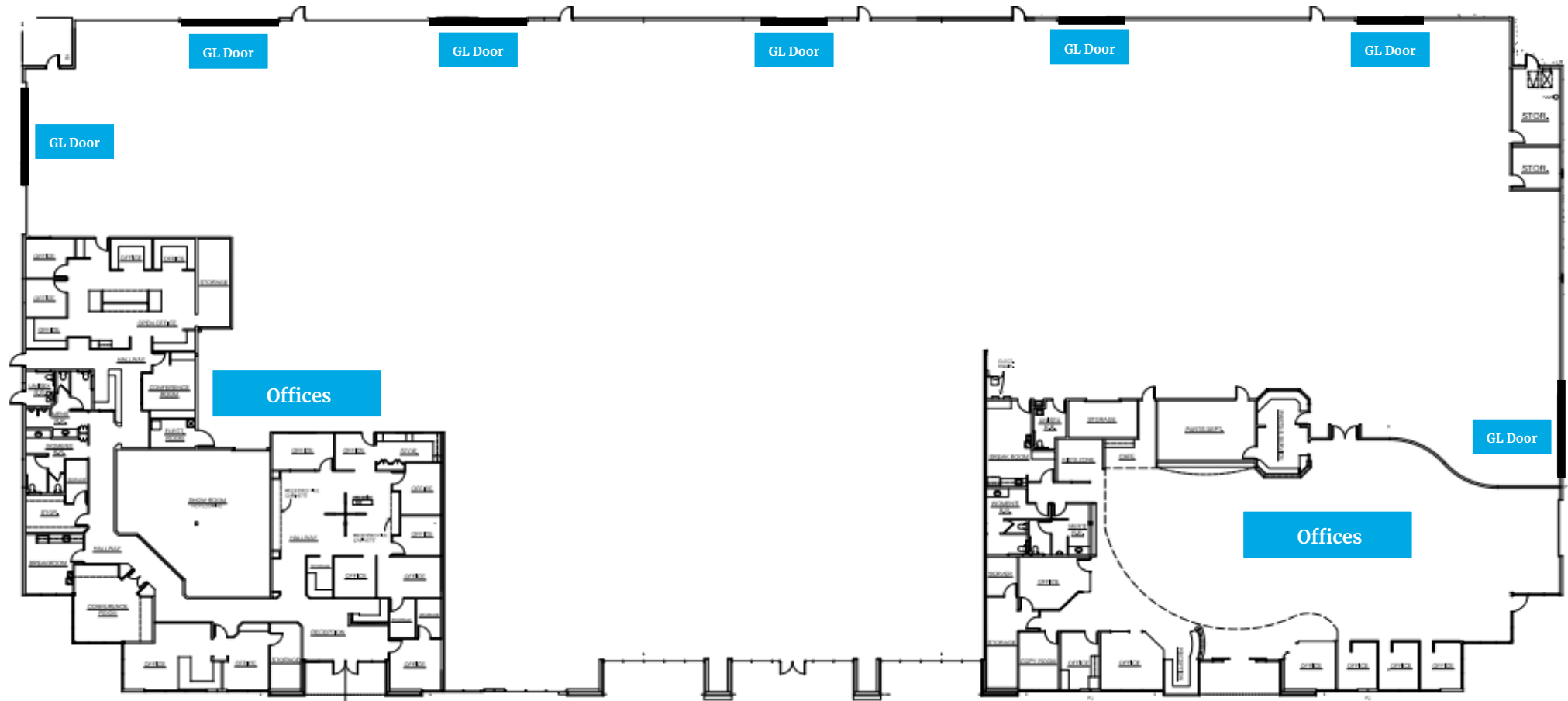

3010 E Elwood St  
Phoenix, AZ



±4.40  
Acre Parcel



±61,344  
Building SF

