



# BOOSALIS PROPERTIES

REAL ESTATE INVESTMENT AND MANAGEMENT

## 12741 MARBLESTONE DRIVE, WOODBRIDGE VA 22192 COMMERCIAL PAD SITE GROUND LEASE



### PROPERTY FEATURES

- Located in PW Town Center
- Zoned PMD
- 24,175 sf finished land bay - building-ready
- 2 signalized entrances to Town Center
- Approved for a 6,000 sf restaurant
- Other allowable uses include daycare and freestanding commercial

### DEMOGRAPHIC SNAPSHOT

	1 MILE	3 MILE	5 MILE
POPULATION	11,009	92,361	188,185
HOUSEHOLDS	3,399	29,826	61,185
AVERAGE HH INCOME	\$90,030	\$94,723	\$96,622

### TRAFFIC COUNTS

Prince William Parkway	47,000 VPD
Ridgefield Road	15,000 VPD

## FOR MORE INFORMATION

### GEORGE BOOSALIS

President/Principal Broker  
george@boosalisproperties.com  
703.494.7691 office | 703.283.6071 cell

### MELANIE NOBRIGA

melanie@boosalisproperties.com  
703.494.7691 office | 808.937.9417 cell

### BOOSALIS PROPERTIES

13562 Richmond Hwy., Suite 100  
Woodbridge, VA 22191  
www.BoosalisProperties.com

This information has been obtained through sources deemed reliable, but accuracy can not be guaranteed.





**BOOSALIS**  
PROPERTIES

REAL ESTATE INVESTMENT AND MANAGEMENT

## 12741 MARBLESTONE DRIVE, WOODBRIDGE VA 22192 COMMERCIAL PAD SITE GROUND LEASE



### FOR MORE INFORMATION

**GEORGE BOOSALIS**

President/Principal Broker

[george@boosalisproperties.com](mailto:george@boosalisproperties.com)

703.494.7691 office | 703.283.6071 cell

**MELANIE NOBRIGA**

[melanie@boosalisproperties.com](mailto:melanie@boosalisproperties.com)

703.494.7691 office | 808.937.9417 cell

**BOOSALIS PROPERTIES**

13562 Richmond Hwy., Suite 100

Woodbridge, VA 22191

[www.BoosalisProperties.com](http://www.BoosalisProperties.com)

This information has been obtained through sources deemed reliable, but accuracy can not be guaranteed.





**BOOSALIS**  
PROPERTIES

REAL ESTATE INVESTMENT AND MANAGEMENT

# 12741 MARBLESTONE DRIVE, WOODBRIDGE VA 22192 COMMERCIAL PAD SITE GROUND LEASE

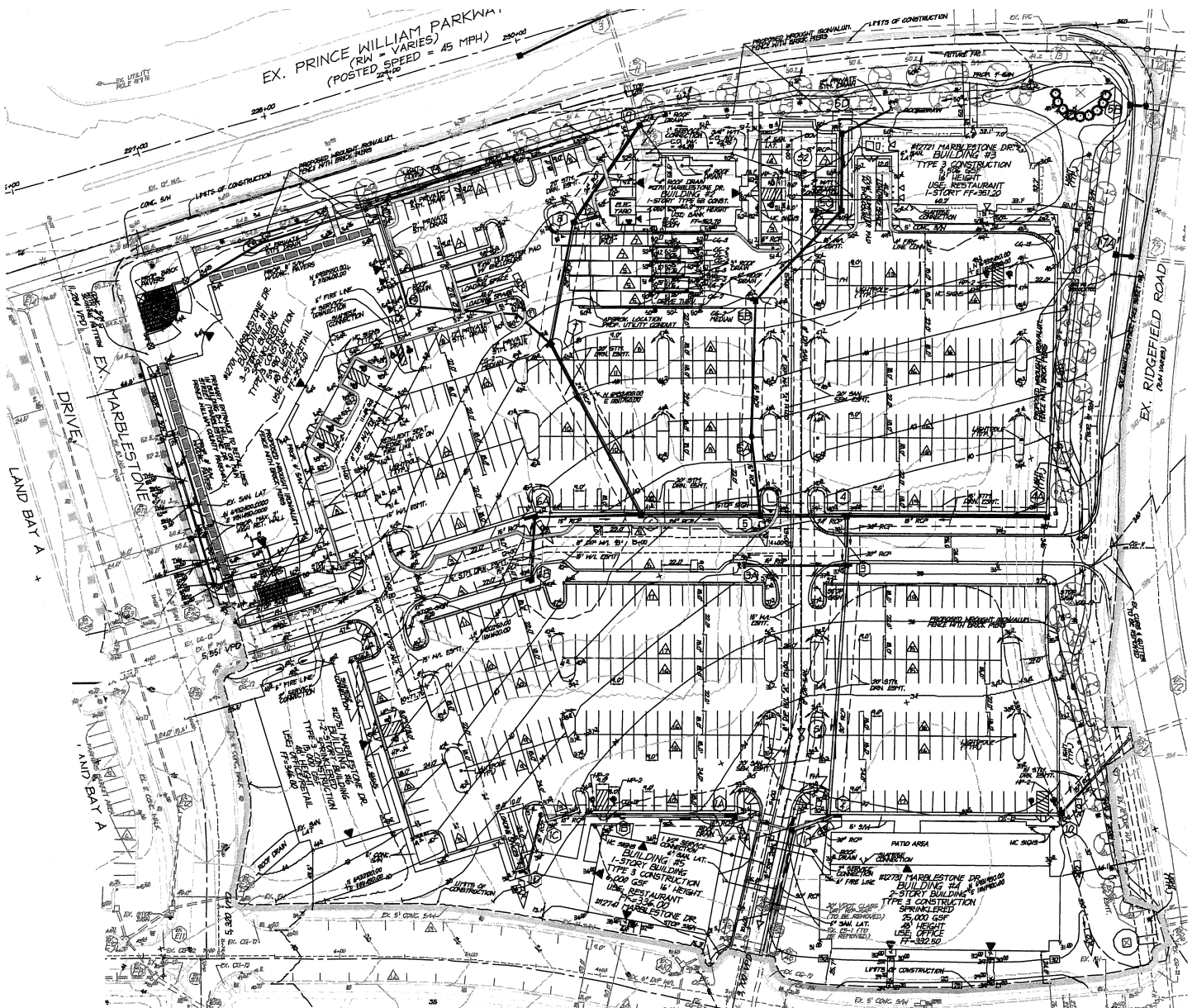

## FOR MORE INFORMATION

**GEORGE BOOSALIS**  
President/Principal Broker  
george@boosalisproperties.com  
703.494.7691 office | 703.283.6071 cell

**MELANIE NOBRIGA**  
melanie@boosalisproperties.com  
703.494.7691 office | 808.937.9417 cell

**BOOSALIS PROPERTIES**  
13562 Richmond Hwy., Suite 100  
Woodbridge, VA 22191  
www.BoosalisProperties.com

This information has been obtained through sources deemed reliable, but accuracy can not be guaranteed.