

# ANTHEM CORPORATE

3715 W Anthem Way, Anthem, AZ

  
TRANSWESTERN  
REAL ESTATE  
SERVICES



## Office and Medical Space Available

PLEASE CONTACT YOUR EXCLUSIVE ADVISORS FOR MORE INFORMATION

**KATHLEEN MORGAN | Managing Director**  
602.809.1048  
kathleen.morgan@transwestern.com

**KEVIN SMIGIEL | Vice President**  
602.550.9295  
kevin.smigiel@transwestern.com

**VINCE FEMIANO | Managing Director**  
602.791.3310  
vince.femiano@transwestern.com

**ANDREW OLIVET | Advisor**  
602.370.2685  
andrew.olivet@transwestern.com



# Anthem Corporate

3715 W Anthem Way, Anthem, AZ 85086

  
TRANSWESTERN  
REAL ESTATE  
SERVICES



\$30.00

Full Service With Base  
Year Operating Expenses



64,473 SF

Building Size



3%

Annual Increases



4.40:1,000/SF

Parking Ratio



2008

Year Built



TI'S

Available

**2ND FLOOR ±30,361 RSF DIVISIBLE TO 1,200 RSF**

# Availability

2nd Floor  
Plate  
Full Floor  
User

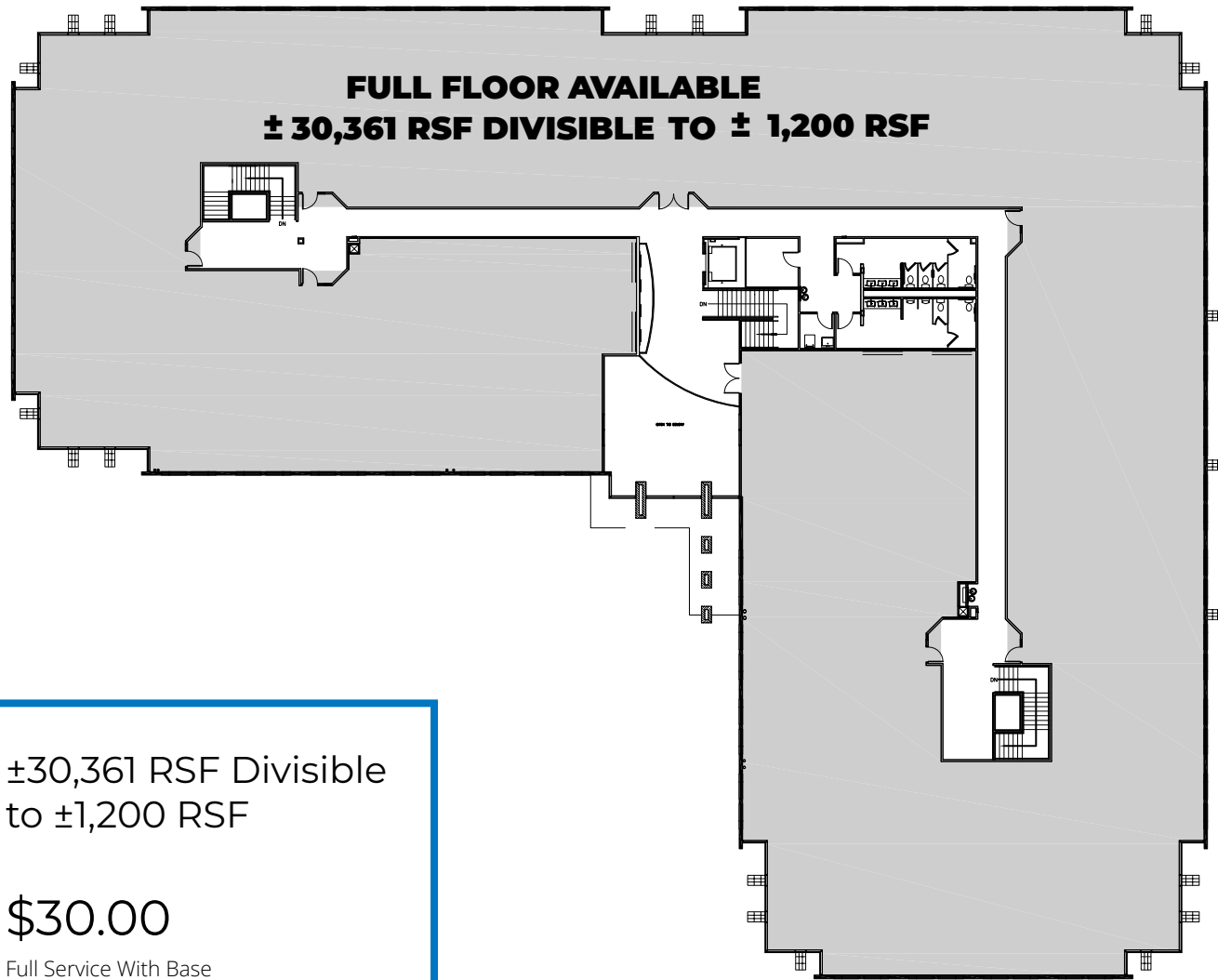

±30,361 RSF Divisible  
to ±1,200 RSF



**\$30.00**

Full Service With Base  
Year Operating Expenses

**PLEASE CONTACT YOUR EXCLUSIVE ADVISORS FOR MORE INFORMATION**



# Location



**Anthem Corporate**



W Anthem Way

N Ventura Dr.

**T**  
**TRANSWESTERN**  
REAL ESTATE  
SERVICES

**PLEASE CONTACT YOUR EXCLUSIVE ADVISORS FOR MORE INFORMATION**

**KATHLEEN MORGAN | Managing Director**  
602.809.1048  
kathleen.morgan@transwestern.com

**KEVIN SMIGIEL | Vice President**  
602.550.9295  
kevin.smigiel@transwestern.com

**VINCE FEMIANO | Managing Director**  
602.791.3310  
vince.femiano@transwestern.com

**ANDREW OLIVET | Advisor**  
602.370.2685  
andrew.olivet@transwestern.com