

FOR LEASE

# OFFICE SPACE

±65,523 SF

181 WEST JOHNSON AVENUE

CHESHIRE, CT



## OFFICE SPACE FOR LEASE

CBRE has been exclusively retained to lease ±65,523 SF of office space at 181 West Johnson Avenue in Cheshire, Connecticut. The space is ideal for a single-tenant user but can be subdivided to accommodate a multi-tenant format.

The facility has abundant parking (7/1,000 SF) is ideal for back-office, medical, call center or processing center. The property offers excellent access to Interstates 691, 84 and 91. Space is available at \$9.50/SF NNN. 2015 CAM (including common area utilities) was \$2.93/SF.

### NEARBY AMENITIES

- + Banking
- + Fitness center
- + Day care
- + Many restaurants located within three miles

[www.cbre.us/newhaven](http://www.cbre.us/newhaven)

**CBRE**

±65,523 SF  
**OFFICE SPACE**

**FOR LEASE**  
**181 WEST JOHNSON AVENUE**  
Cheshire, CT



**BUILDING PHOTOS**





±65,523 SF  
**OFFICE SPACE**

**FOR LEASE**  
**181 WEST JOHNSON AVENUE**  
Cheshire, CT



## FLOOR PLANS

**FIRST FLOOR - ±55,040 SF**



**SECOND FLOOR - ±10,483 SF**

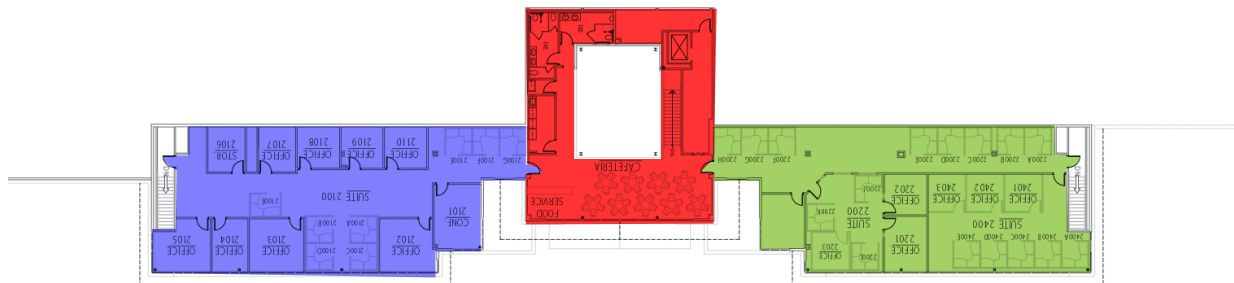

## CONTACT US

### DAVID BARNES

Senior Vice President  
+1 860 987 4782  
david.barnes@cbre.com

### DAVID HANSEN

Vice President  
+1 203 777 5996  
david.hansen@cbre.com

### MATTHEW O'HARE

First Vice President  
+1 203 777 5990  
matthew.ohare@cbre.com

© 2019 CBRE, Inc. This information has been obtained from sources believed reliable. We have not verified it and make no guarantee, warranty or representation about it. Any projections, opinions, assumptions or estimates used are for example only and do not represent the current or future performance of the property. You and your advisors should conduct a careful, independent investigation of the property to determine to your satisfaction the suitability of the property for your needs. Photos herein are the property of their respective owners and use of these images without the express written consent of the owner is prohibited.

[www.cbre.us/newhaven](http://www.cbre.us/newhaven)

**CBRE**