

# South Seminole Industrial

Industrial Flex Space Available

975 & 1175 Florida Central Pky  
Longwood, FL 32750

4,864 - 10,000 RSF AVAILABLE FOR LEASE



# Industrial | Flex

1175 Florida Central Pky Longwood, FL 32750

# SUITE 3200

## SUITE 3200: 5,144 SF FOR LEASE

Available NOW!

### Suite Features:

- + 5,144 SF
- + 342 SF Office Area
- + Front Load
- + Clear Height 20'6"
- + One (1) 9' x 10' Drive-In Ramp
- + 2.00/1,000 SF Parking Ratio
- + Power: 3-phase
- + 1 Restrooms
- + \$15.95 PSF NNN
- + \$3.82 Opex



## Industrial | Flex

1175 Florida Central Pky Longwood, FL 32750

# SUITE 3000

### SUITE 3000: 10,200 SF FOR LEASE

Available NOW!

#### Suite Features:

- + 10,377 SF
- + 2.00/1,000 SF Parking Ratio
- + 1,260 SF Office Area
- + Power: 3-phase
- + Front Load
- + 2 Restrooms
- + Clear Height 20'6"
- + Contact Broker for Pricing
- + One (1) 9' x 10' Dock- Door
- + \$3.82 Opex
- + One (1) 9' x 10' Drive-In Ramp

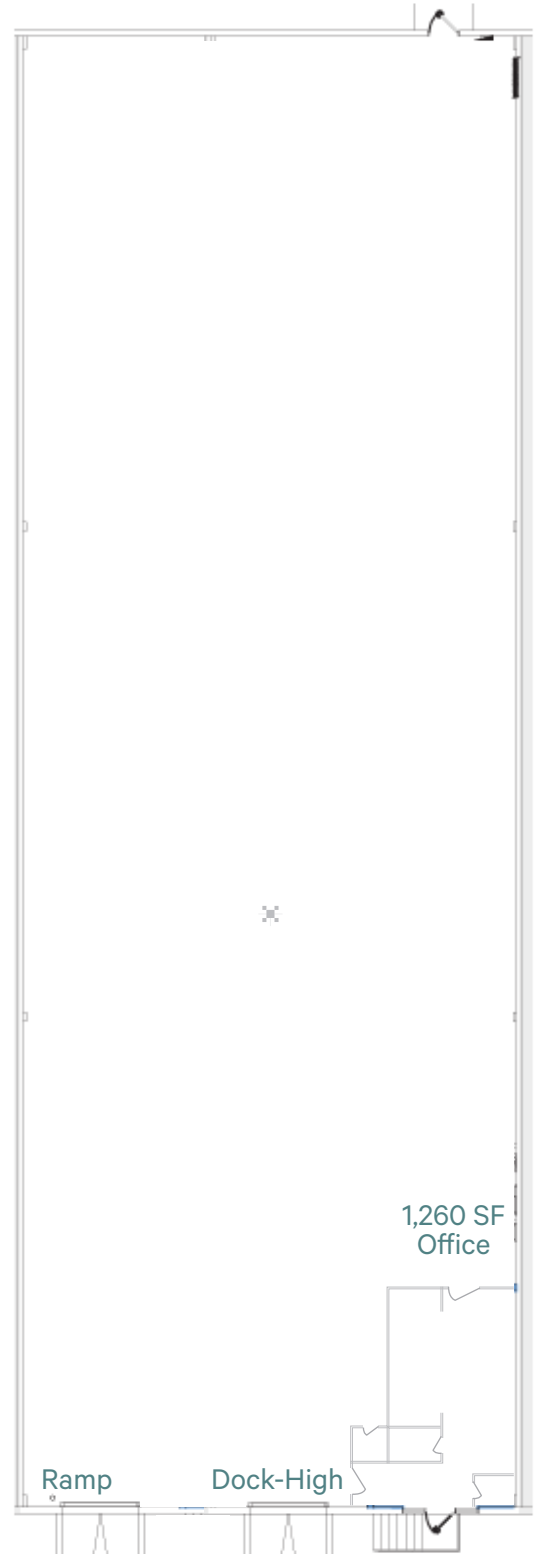
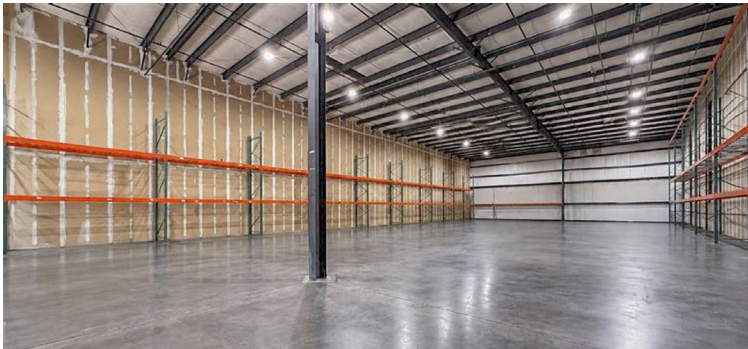

**SUITE 1200 4,864 SF FOR LEASE**

Available NOW!

**Suite Features:**

- + 4,864 SF
- + 933 SF Office
- + 2,045 SF AC Warehouse
- + 2,090 SF Warehouse
- + Rear Load
- + Clear Height 20'6"
- + One (1) 9' x 10' Dock-High
- + 2.00/1,000 SF Parking Ratio
- + Power: 3-phase
- + 1 Restrooms
- + \$15.95 PSF NNN
- + \$3.82 Opex

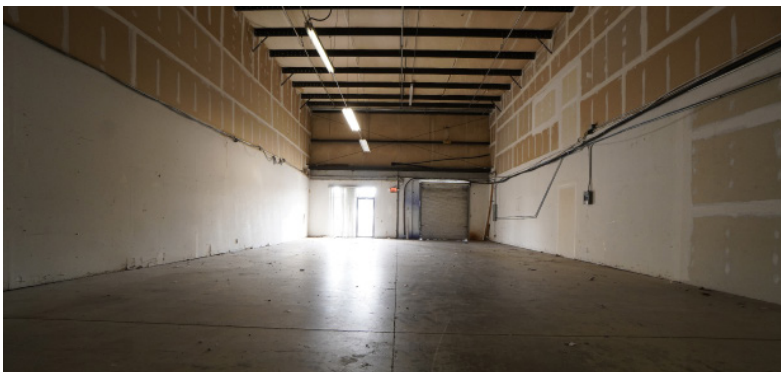

# Industrial | Flex

975 Florida Central Pky Longwood, FL 32750

# SUITE 2150

## SUITE 2150: 10,000 SF FOR LEASE

Available NOW!

### Suite Features:

- + ± 11,750 SF
- + ± 4,416 SF Office
- + 5,548 SF Warehouse
- + Rear Load
- + Clear Height 20'6"
- + Two (2) 9' x 10' Dock-High Doors
- + 2.00/1,000 SF Parking Ratio
- + Power: 3-phase
- + 2 Restrooms
- + Price: Withheld
- + \$3.82 Opex

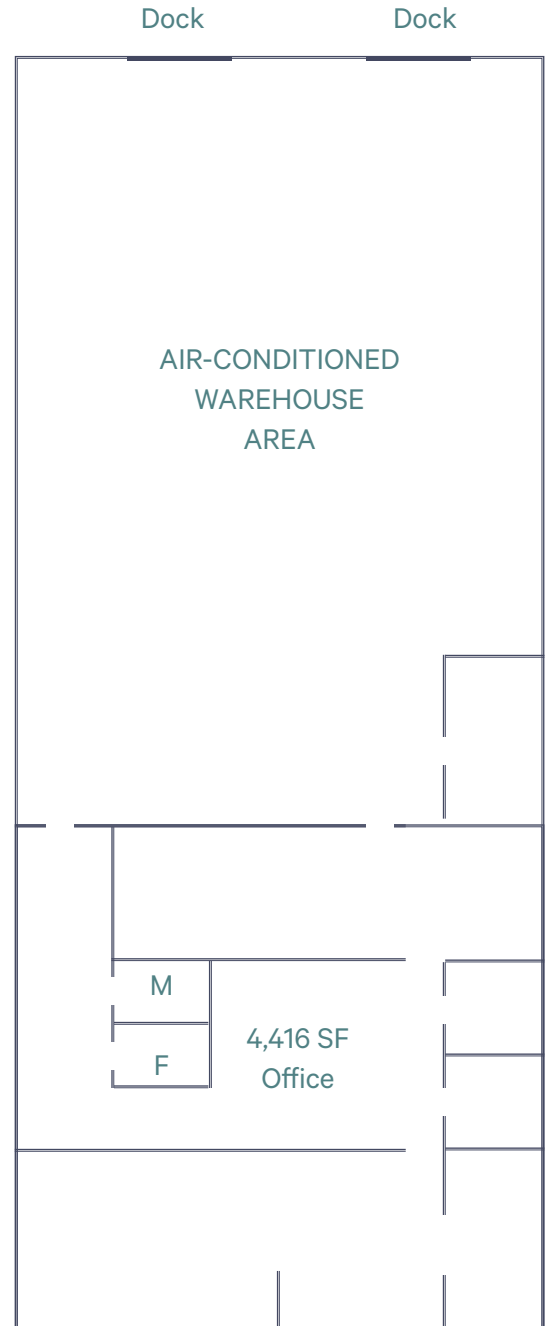

## STRATEGIC LOCATION

### Distance to Key Hubs:

- + Sanford Int'l Airport (SFB): 18 Minutes
- + Port Canaveral: 55 Minutes
- + Orlando Int'l Airport (MCO): 28 Minutes
- + The Villages: 65 Minutes

South Seminole Industrial is an Infill Powerhouse. This location offers a rare 'Goldilocks' zone: the professional image of Longwood paired with the heavy-duty industrial utility of a dock-high facility.

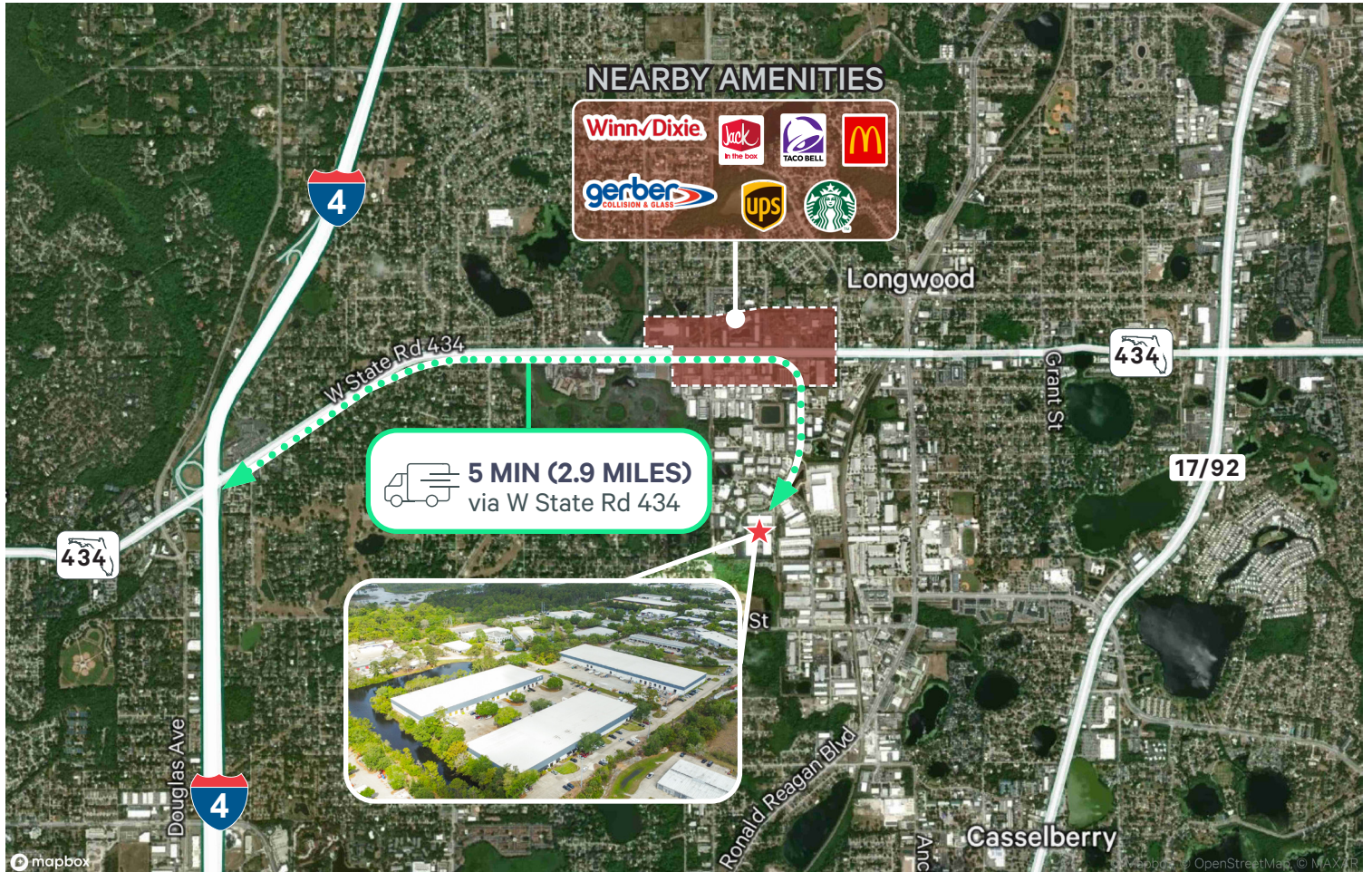

## Contact Us For Leasing

### Cameron Thomas

Senior Associate  
+1 407 404 5078  
[cameron.thomas@cbre.com](mailto:cameron.thomas@cbre.com)

### Alex Eastwood

Senior Associate  
+1 850 356 823  
[alex.eastwood@cbre.com](mailto:alex.eastwood@cbre.com)

### Jose Rivera

Associate  
+1 407 404 5067  
[jose.rivera1@cbre.com](mailto:jose.rivera1@cbre.com)

Scan for:

- More Info
- Save
- Share



© 2026 CBRE, Inc. All rights reserved. This information has been obtained from sources believed reliable, but has not been verified for accuracy or completeness. You should conduct a careful, independent investigation of the property and verify all information. Any reliance on this information is solely at your own risk. CBRE and the CBRE logo are service marks of CBRE, Inc. All other marks displayed on this document are the property of their respective owners, and the use of such logos does not imply any affiliation with or endorsement of CBRE. Photos herein are the property of their respective owners. Use of these images without the express written consent of the owner is prohibited.

# CBRE