



Newly Constructed!  
Available Immediately  
(34,907 to 141,012 SF)



For Sale or For Lease: Industrial

# 16 Studebaker Place

Hamilton, Ontario

**Lennard:** Here is where your business will *grow*.



# 16 Studebaker Place, Hamilton



## Price:

For Sale: **\$39,950,000** (\$283.30 PSF) | For Lease: **\$15.50 PSF Net**



Size  
141,012 SF, Div. from  
34,907 SF to 81,006 SF



Zoned  
M6 (exemp. 677)  
Allows Outside Storage



Shipping  
16 TL | 2 DI



Extra Land  
2 acres or 3.5 acres  
available for open storage  
or trailer parking



Bay Size  
56 x 43'9"



Available  
Immediately



Clear Height  
36'



Car Parking  
59 Autos



Solar-Ready  
Roof and structure  
upgraded for solar panels



Power  
1600 amps

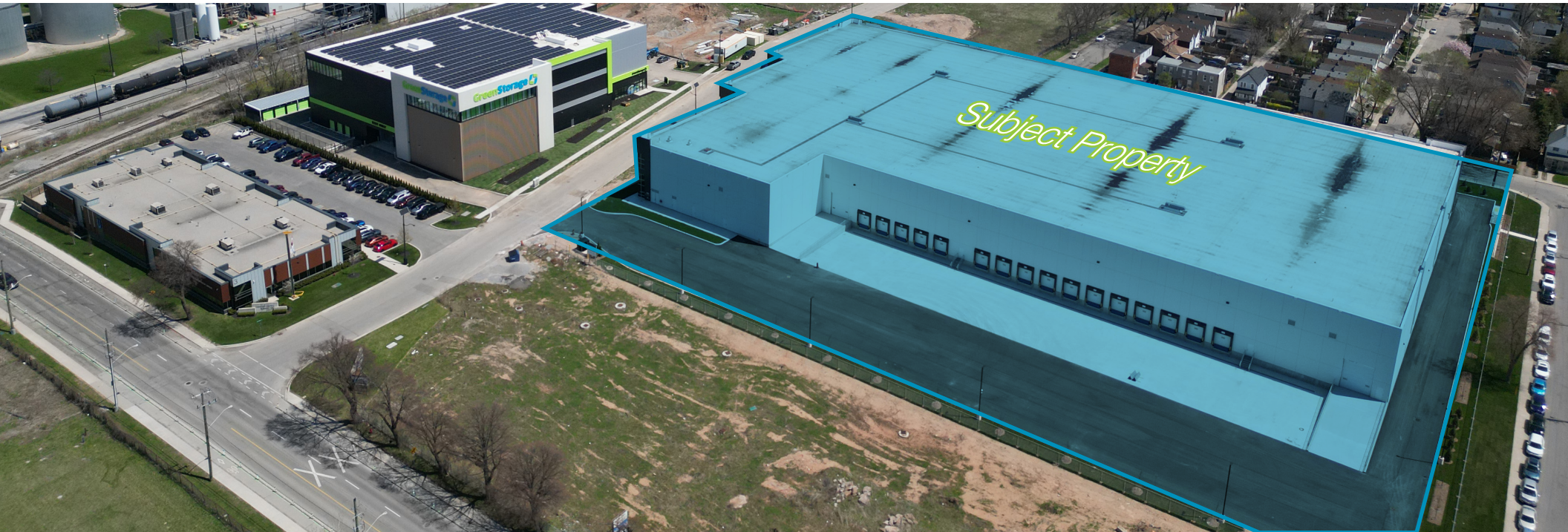

**Lennard:**

Albert Maierhofer\*, Executive Vice President  
905.247.9232 • [amaierhofer@lennard.com](mailto:amaierhofer@lennard.com)

\*Sales Representative

**Green  
Storage**

**HARLO  
CAPITAL**

# 16 Studebaker Place, Hamilton



## Site Plan

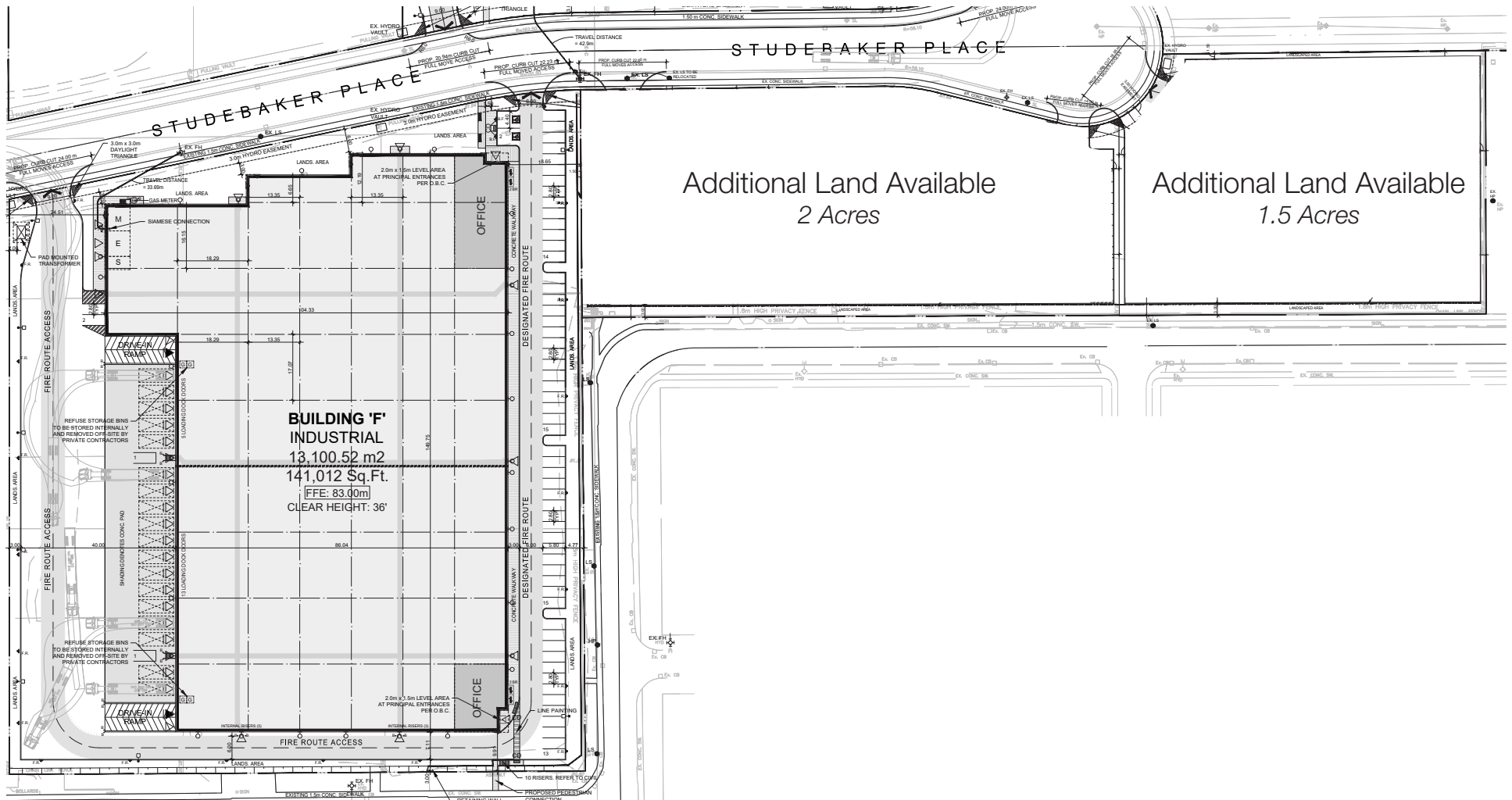

Albert Maierhofer\*, Executive Vice President  
 905.247.9232 • [amaierhofer@lennard.com](mailto:amaierhofer@lennard.com)

\*Sales Representative



# 16 Studebaker Place, Hamilton



## Demising Options

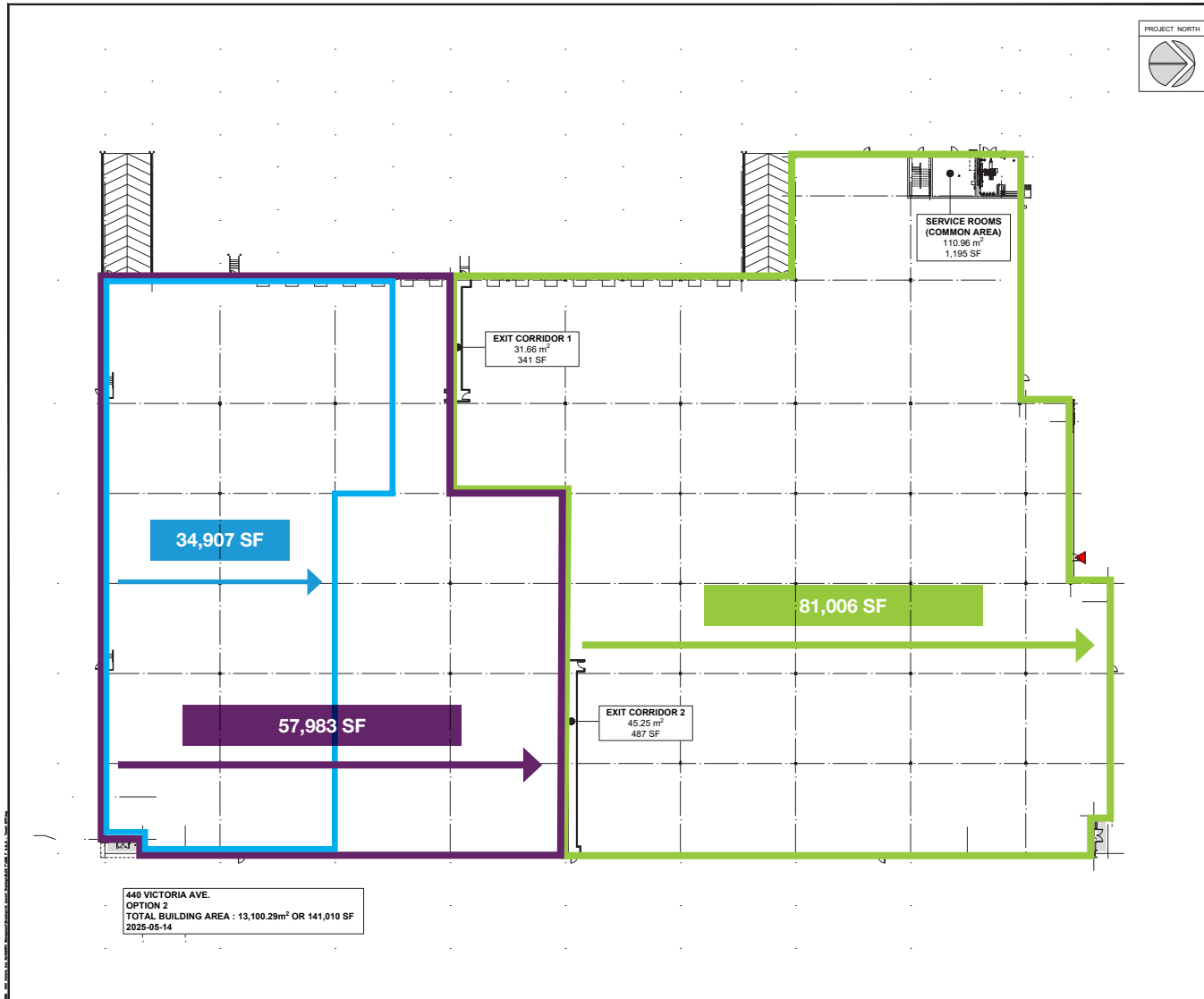

# 16 Studebaker Place, Hamilton



**Lennard:**

Albert Maierhofer\*, Executive Vice President  
905.247.9232 • [amaierhofer@lennard.com](mailto:amaierhofer@lennard.com)

\*Sales Representative



# 16 Studebaker Place, Hamilton



## Zoning Map



# Studebaker Place, Hamilton



## Permitted Uses

- Alcohol Production Facility (By-law No. 18-219, August 17, 2018)
- Aquaponics (By-law No. 14-163, June 25, 2014)
- Artist Studio (By-law No. 17-220, October 25, 2017)
- Building and Lumber Supply Establishment
- Building or Contracting Supply Establishment
- Cannabis Growing and Harvesting Facility (By-law No. 14-163, June 25, 2014) (By-law No. 18-266, September 12, 2018)
- Commercial Motor Vehicle Sales, Rental and Service Establishment
- Commercial Parking Facility
- Communications Establishment
- Conference or Convention Centre
- Contractor's Establishment
- Courier Establishment
- Craftsperson Shop (By-law No. 17-220, October 25, 2017)
- Equipment and Machinery Sales, Rental and Service Establishment
- Financial Establishment
- Greenhouse (By-law No. 14-163, June 25, 2014)
- Hotel
- Industrial Administrative Office
- Laboratory
- Labour Association Hall
- Manufacturing
- Medical Clinic
- Motor Vehicle Collision Repair Establishment
- Motor Vehicle Service Station
- Motor Vehicle Washing Establishment
- Office
- Personal Services Private
- Power Generation Facility
- Production Studio (By-law No. 17-220, October 25, 2017)
- Repair Service
- Research and Development Establishment
- Restaurant
- Surveying, Engineering, Planning or Design Business Trade School
- Tradesperson's Shop
- Transport Terminal
- Transportation Depot
- Warehouse

## Zoning Regulations

Outdoor Storage and Outdoor Assembly of goods, materials or equipment shall be permitted in conjunction with a building and the following regulations shall apply:

- Outdoor Storage and Outdoor Assembly shall not be permitted in a required yard abutting a street;
- In addition to i) above, Outdoor Storage and Outdoor Assembly shall not be permitted in a Front Yard or a Flankage Yard along Barton Street/Barton Street East;
- Outdoor Storage and Outdoor Assembly shall not exceed **85% of the total lot area**;
- Outdoor Storage and Outdoor Assembly shall be set back a minimum of 20.0 metres from any portion of a property lot line abutting a property lot line within a Residential Zone or an Institutional Zone, and shall be screened by a Visual Barrier in accordance with Section 4.19 of this By-law;
- Outdoor Storage and Outdoor Assembly shall be screened from view from any abutting street by a Visual Barrier in accordance with Section 4.19 of this By-law.

## Site Specific Zoning

677. Within the lands zoned Light Industrial (M6) Zone, identified on Maps 870 and 871 of Schedule "A" – Zoning Maps :

The following special provisions shall apply:

- In addition to Subsection 9.6.1, the following uses shall also be permitted:

- Animal Shelter;
- Biotechnical Establishment;
- Commercial Motor Vehicle Washing Establishment;
- Commercial School;
- Commercial Recreation;
- Landscape Contracting Establishment;
- Microbrewery;
- Pharmaceutical and Medical Establishment; and,
- Science and Technology Establishment

# 16 Studebaker Place, Hamilton

## Location Map

