

FOR LEASE RARE JUNIOR BOX END-CAP SPACE

Rivers Edge Plaza: 15 Antrim Road / Route 202, Hillsborough, NH 03244



Highlights:

- Tenant Mix With Strong Traffic Generators
- Rare "Junior Box" Space
- Proximity to Town's Primary Intersection With Direct Access to Route 9
- Ample Parking
- Good Signage

FOR LEASE RARE JUNIOR BOX END-CAP SPACE

Rivers Edge Plaza: 15 Antrim Road / Route 202, Hillsborough, NH 03244



Trade Area:

	1 - Mile	3 - Mile	5 - Mile
Total Population	890	5,480	8,979
Total Households	391	2,257	3,602
Med. HH Income	\$82,173	\$78,322	\$80,747
Owner Occ. Housing	335	1,965	3,138
Renter Occ. Housing	56	291	464
Total Businesses	97	234	323
Total Employees	1,261	2,386	2,978

Property Profile:

GLA:	
Building A:	12,033 SF
Building B:	20,980 SF
Space Available:	10,894 SF
Levels:	1
Parking Ratio:	171+10 Handicap / 9.78/1000
Curb Cuts:	2
Signage:	Pylon (2) and Building
Frontage:	550' (Antrim Road)
Traffic Count:	10,000 ADT
Zoning:	Commercial-WS
Services:	Municipal Water & Sewer

**For Further Information,
Contact:**

Richard Pilla

617-845-5001

rpilla@paramountpartners.com

Brendan Coan

617-845-5243

bcoan@paramountpartners.com

The information contained herein is from sources deemed reliable, however no representation or warranty is made to its accuracy, and is submitted subject to errors, omissions, change of price, rental or other conditions, prior sale or lease, or withdrawal without notice.



FOR LEASE RARE JUNIOR BOX END-CAP SPACE

Rivers Edge Plaza: 15 Antrim Road / Route 202, Hillsborough, NH 03244

RIVERS EDGE PLAZA
Hillsborough, NH

Lease Plan

UNIT	TENANT	SF
A	State Liquor	4,203
B	Subway	1,500
C	Couthouse	4,191
D	Bar Harbor Bank	2,000
E	Concord Hospital	8,086
F	VACANT	10,894

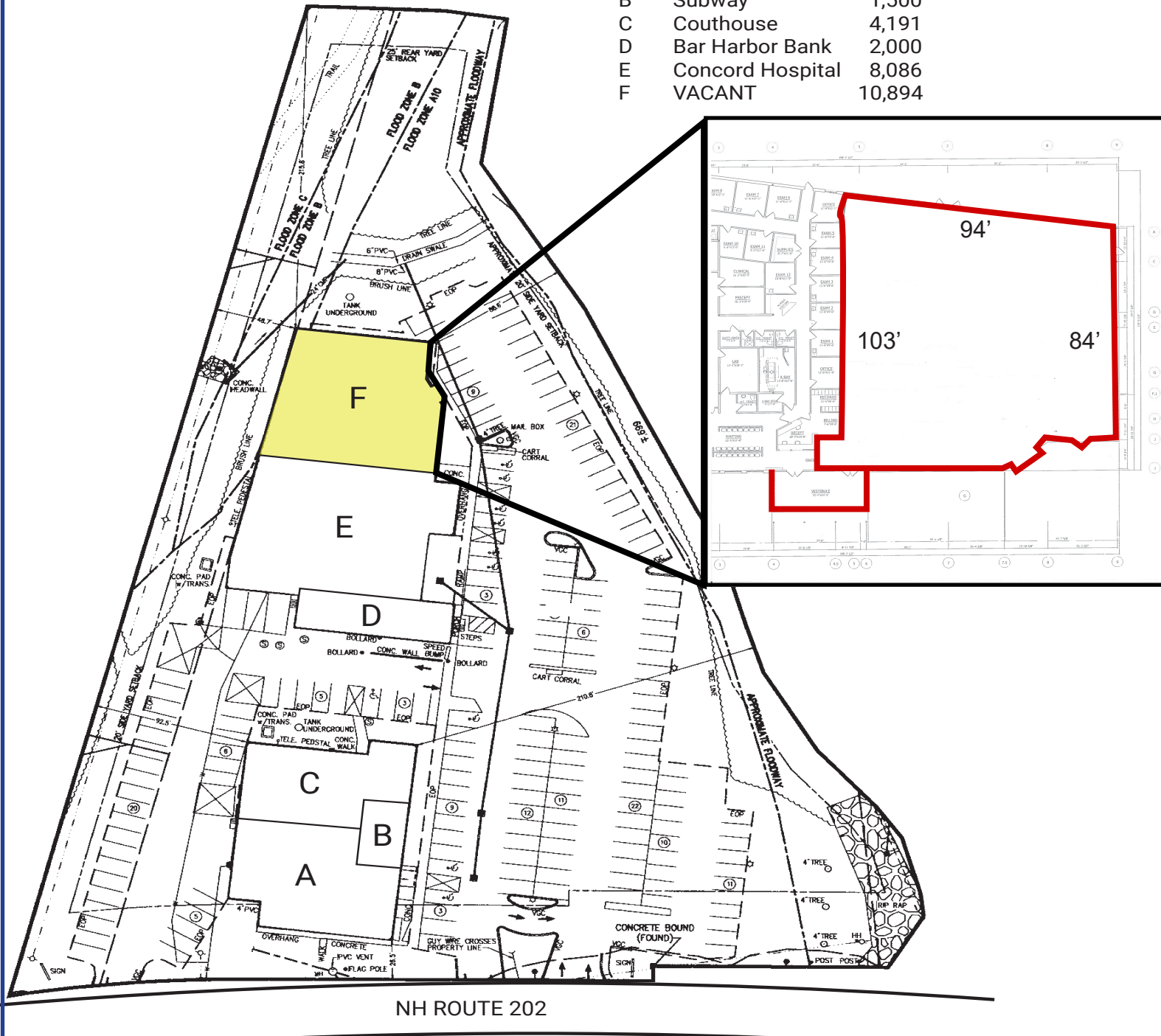

NH ROUTE 202