

320 5TH AVE N | ST. PETERSBURG, FL

# SPACE AVAILABLE

A RETAIL OPPORTUNITY AT THE CROSSROADS OF  
DOWNTOWN AND 4TH STREET



**ARCHER**

REAL ESTATE

# PROPERTY DETAILS

- 682 SF AVAILABLE
- BUILT IN 2018 | CONCRETE BLOCK
- ADJACENT THE CORNER OF 4TH ST N & 5TH AVE N, THE GATEWAY TO DOWNTOWN ST. PETE
- OFFERS EXCELLENT VISIBILITY WITH AN AVG. DAILY TRAFFIC COUNT OF 10,000 CARS ON 5TH AVE AND 29,000 CARS 4TH ST
- WALK SCORE: WALKER'S PARADISE (93)
- CLOSE PROXIMITY TO ST ANTHONY'S HOSPITAL AND 4TH STREET RETAIL CORRIDOR
- BASE RENT: \$3,000/MO NNN





# SITE PLAN

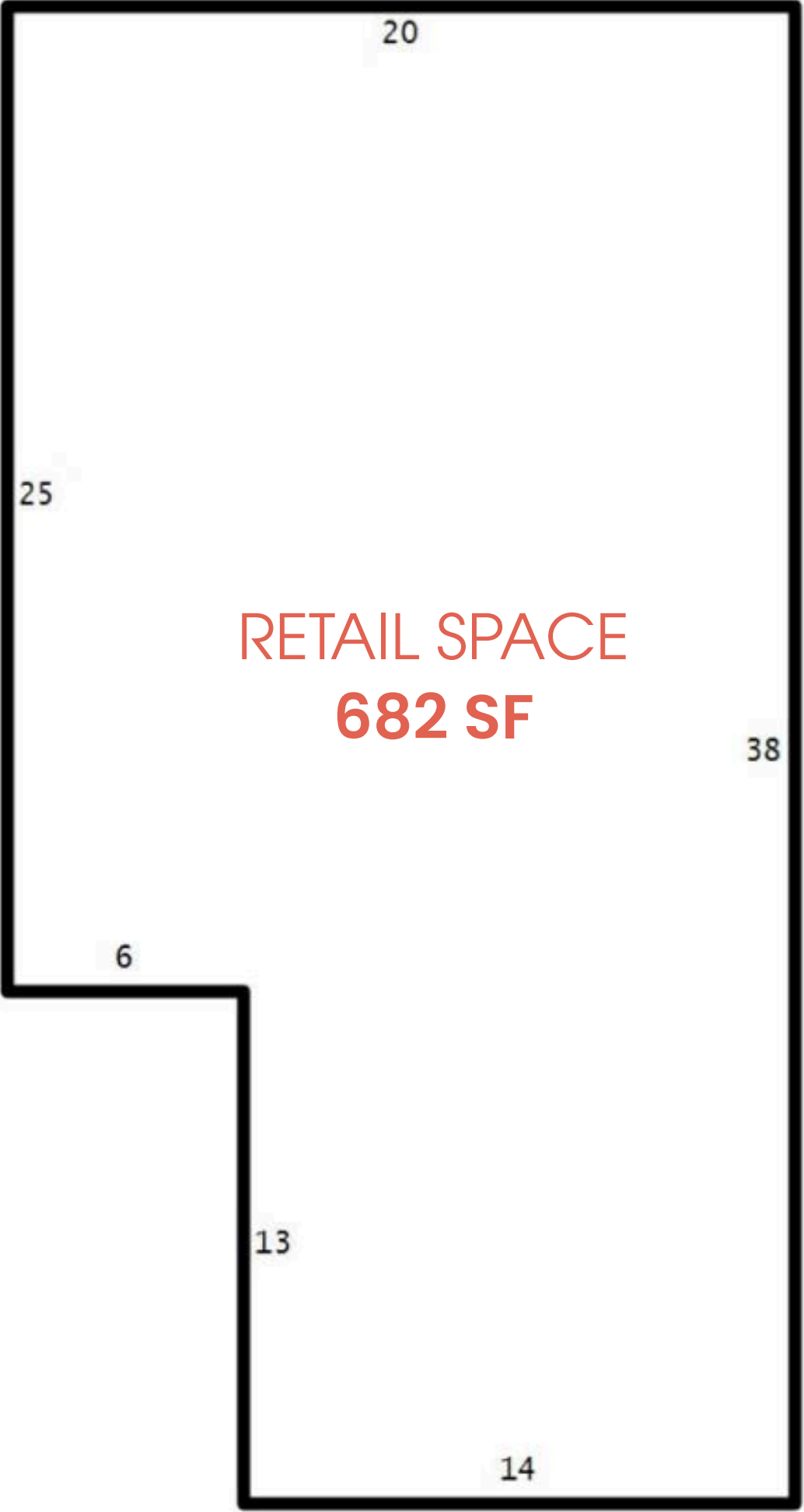
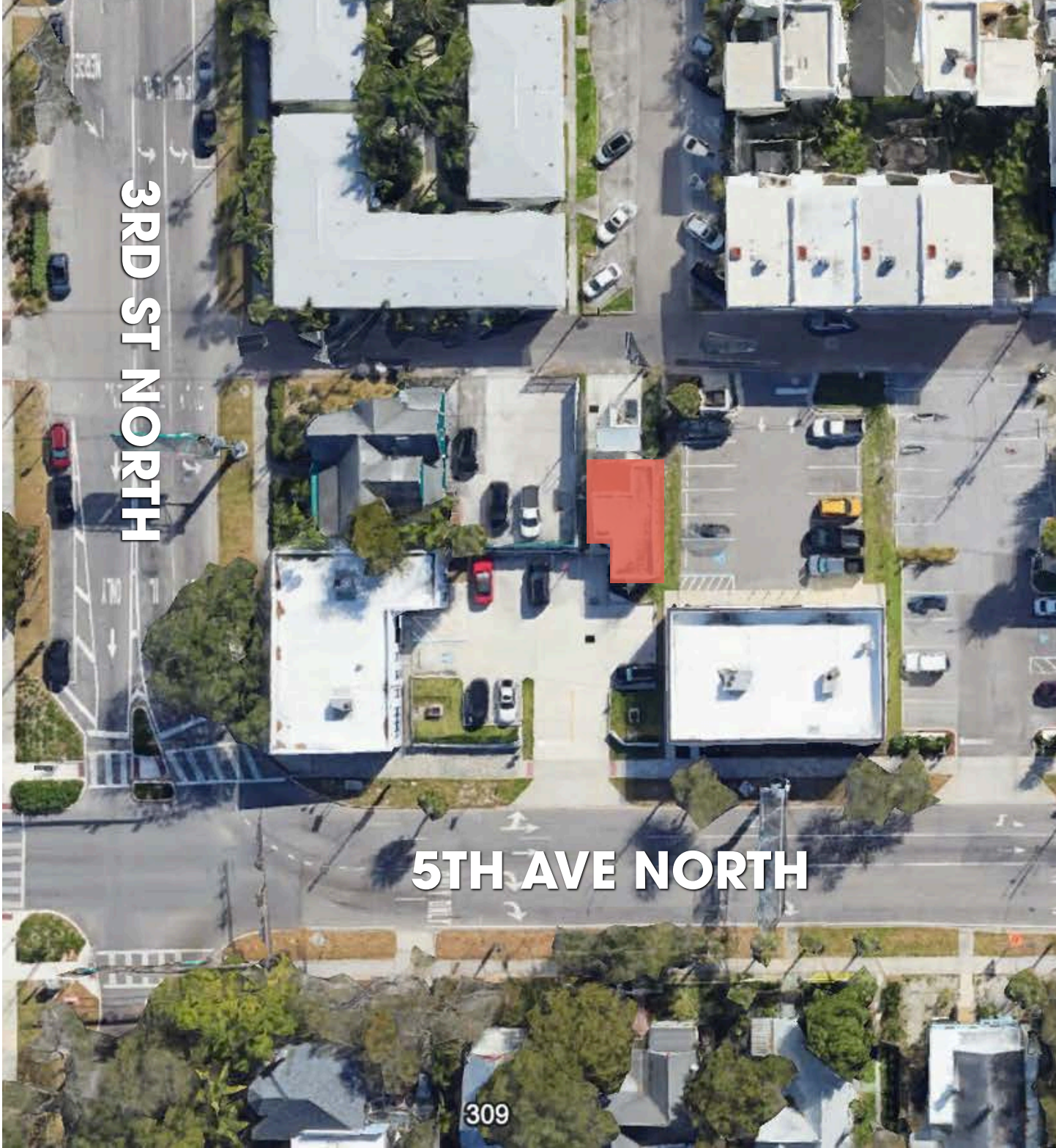

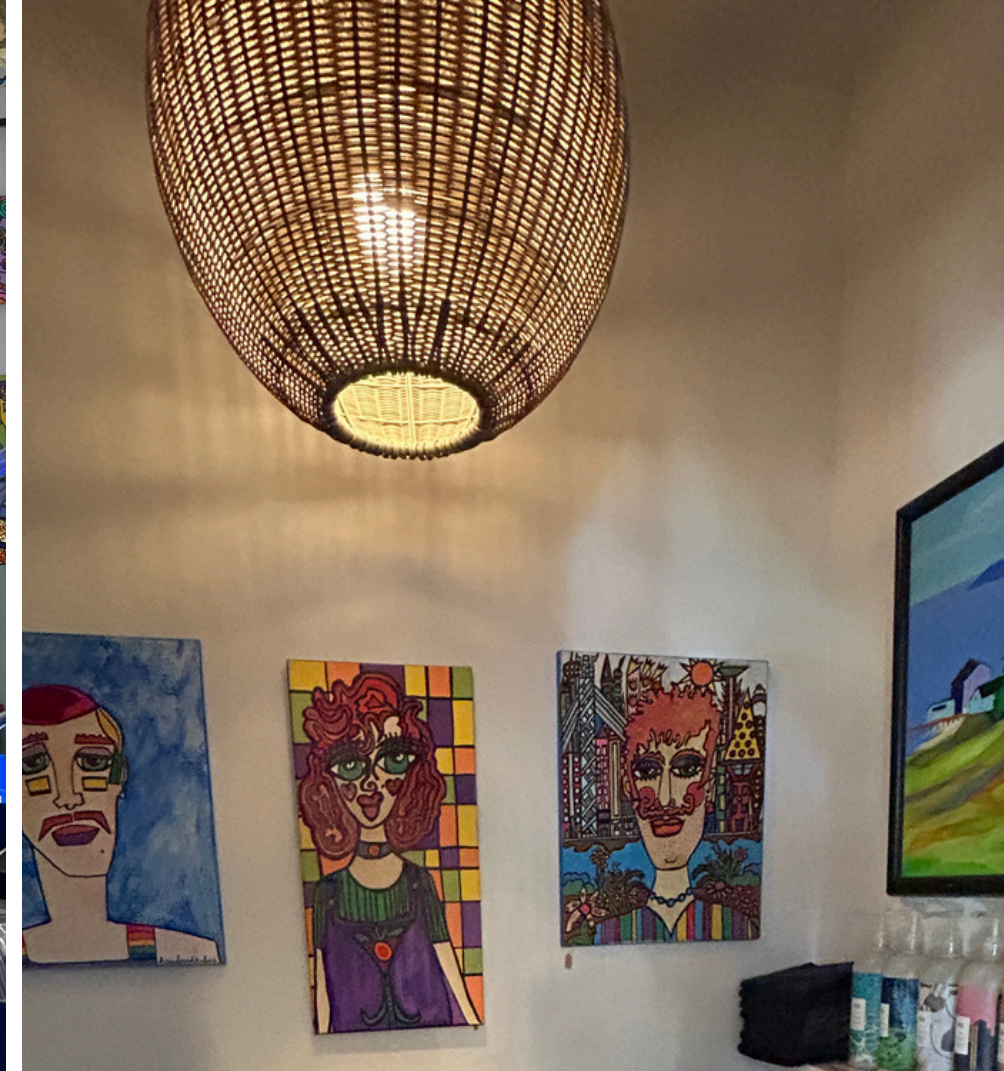



# DEMOGRAPHICS

## TOTAL POPULATION

1 MILE	24,105
3 MILES	101,780
5 MILES	229,525

## AVG HH INCOME

1 MILE	\$119,953
3 MILES	\$117,237
5 MILES	\$108,155

## DAYTIME POPULATION

1 MILE	43,250
3 MILES	115,389
5 MILES	217,647

## MEDIAN AGE

1 MILE	48.0
3 MILES	44.1
5 MILES	45.0

# THE NEIGHBORHOOD

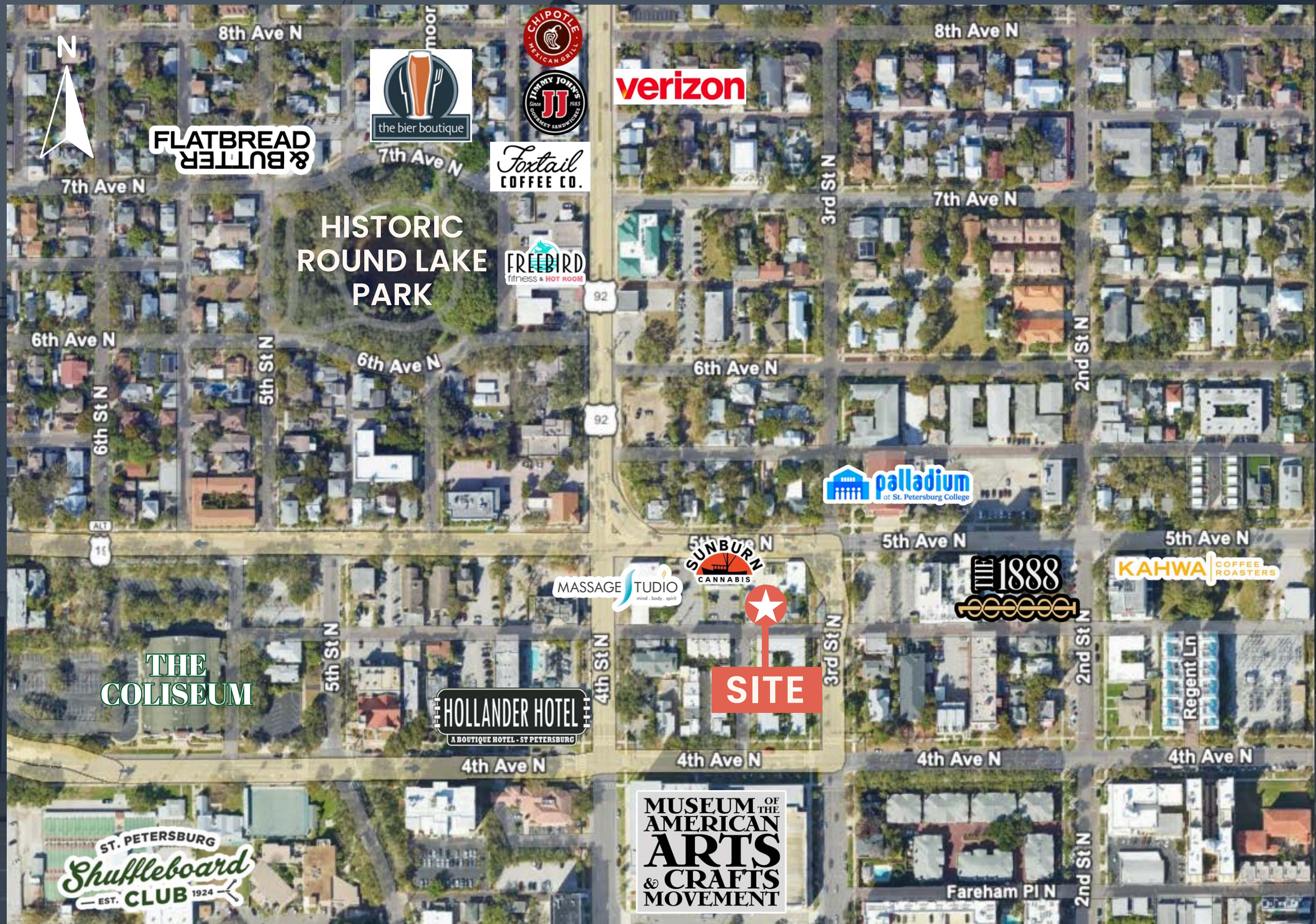

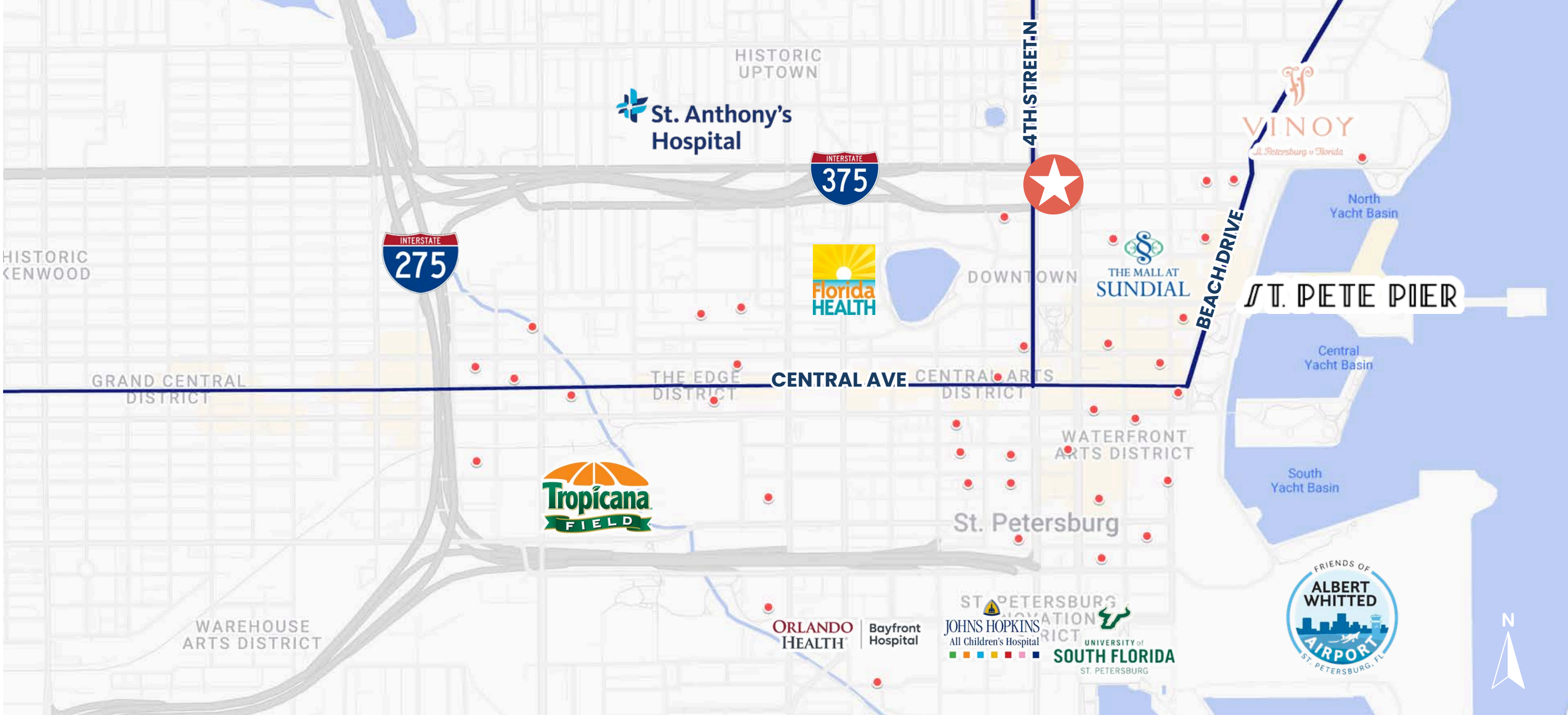

# AREA MAP

CENTRAL AVE .....	0.4 MI
THE SUNDIAL SHOPPING MALL .....	0.6 MI
ST ANTHONY'S HOSPITAL .....	0.8 MI
USF .....	0.9 MI
ALL CHILDREN'S HOSPITAL .....	1.0 MI

ORLANDO HEALTH	
BAYFRONT HOSPITAL .....	1.1 MI
I 275 .....	1.3 MI
EXISTING RESIDENTIAL BUILDINGS WITH OVER 100 UNITS .....	

SUBJECT SITE ..... 



# ARCHER

REAL ESTATE

**LYDIA KRESSEL**

SENIOR ASSOCIATE  
LYDIA@ARCHERGROUPE.COM  
571-882-4712

**KYLE MASTERSON**

CO-FOUNDER + PRINCIPAL  
KYLE@ARCHERGROUPE.COM  
727-656-8337

**WWW.ARCHERGROUPE.COM | INFO@ARCHERGROUPE.COM | 813.463.0163**

This marketing material is intended for informational purposes only and does not constitute an offer or solicitation for the purchase or lease of real estate. All properties, prices, and availability are subject to change without notice. The information provided is believed to be accurate but is not guaranteed. Commercial real estate services are provided by Archer Real Estate, a licensed real estate brokerage.