

# MIMO CITY SQUARE

MIMO

MIAMI  
FL

RKF



# SPACE DETAILS

## LOCATION

West block between NE 55th Terrace and NE 56th Street

## APPROXIMATE SIZE

Ground Floor

Space A 4,597 SF\*

Space B 1,240 SF\*

Total 5,837 SF

*\*can be combined*

## CEILING HEIGHT

Ground Floor

Space A 10 FT

Space B 16 FT

## POSSESSION

Arranged

## TERM

Negotiable

## NEIGHBORS

Andiamo! Brick Oven Pizza, The Federal Food, Drink & Provisions, Soyka, Sullivan Street Bakery and Sushi Siam

## COMMENTS

MiMo City Square is a new retail development situated at the southern entrance of Miami's MiMo District

On-site private parking

Anchored by New York's famous Sullivan Street Bakery, whose Jim Lahey won the 2015 James Beard Award for Outstanding Baker



CONCEPTUAL RENDERING



CONCEPTUAL RENDERING

# FLOOR PLANS

## GROUND FLOOR

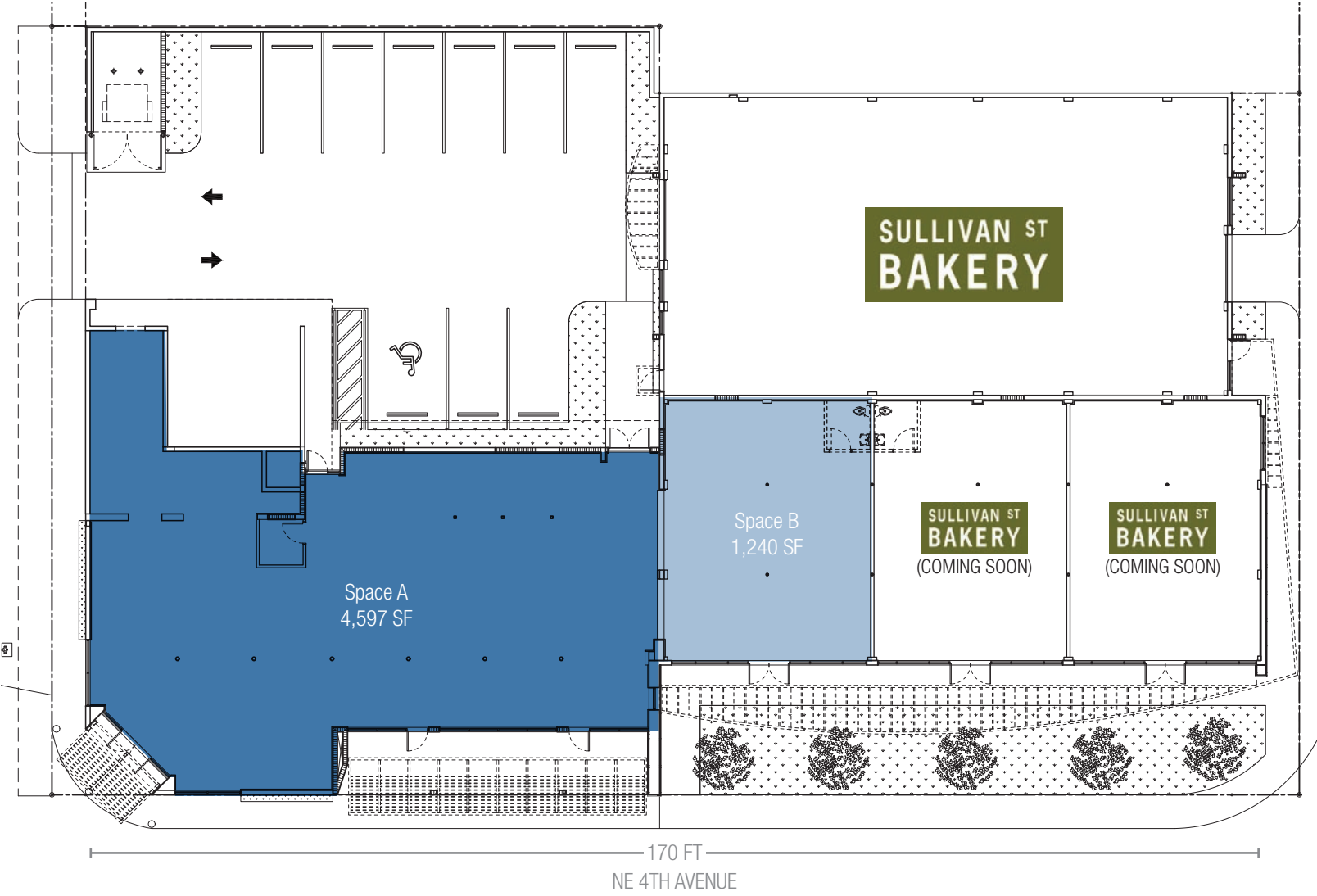

SPACE	CEILING HEIGHT	FRONTAGE
Space A	Space A	Space A
Space B	Space B	Space B
Total		

\*can be combined

\* 120 FT total on NE 4th Avenue



# AREA NEIGHBORS





# SULLIVAN STREET BAKERY

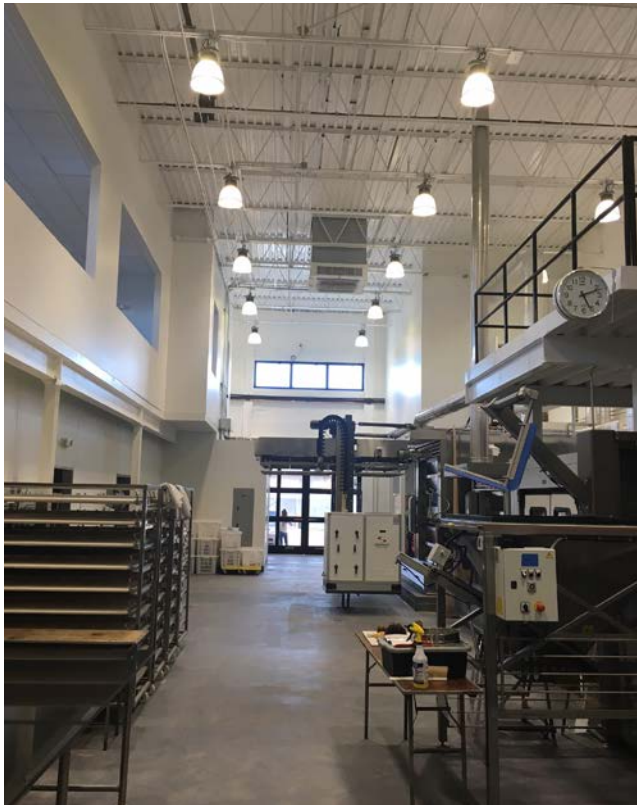



# AREA RETAIL



## MIMO CITY SQUARE MIAMI FL

### CONTACT EXCLUSIVE AGENTS

**JOHN ELLIS**  
305.372.6204  
jellis@rkf.com

**AARON LABOVITZ**  
305.372.6206  
alabovitz@rkf.com



**800 BRICKELL AVENUE, SUITE 502  
MIAMI, FL 33131**

INFO@RKF.COM  
RKF.COM

© 2017 RKF All information is from sources believed reliable, not independently verified, and thus subject to errors, omissions, and modifications such as price, listing, square footage, rates and commissions. All information, estimates and projections subject to change, market assumptions, unknown facts and conditions, and future potentialities. RKF makes no express or implied representations or warranties, as facts and results may vary materially from all information, estimates and projections.

All renderings presented are conceptual.