

FOR LEASE



Prime Clinical Space for Lease Downtown Batesville, MS

SUMMARY

Lease Rate: \$5,000.00 Per Month

Lease Type: Modified Gross

Lot Size: 0.30 Acres

Building SF: 8,800 +/- SF

Parking: Shared Off Street Parking

Zoning: Office



RHODES THOMPSON

Commercial Agent
(662) 892-4000
rhodesthompson@outlook.com
Mississippi

(901) 286-6200 - Main Office
(901) 833-8000 - Cell

AVAILABLE FOR LEASE

Suite	Rate	Size	Type
B	\$5,000 /mo	4,678 +/- SF	Modified Gross

Discover an exceptional leasing opportunity at 109 Eureka Street, ideally located just 2 miles from the I-55 exit in the heart of downtown Batesville.

Whether you're launching a new practice or expanding your footprint, this location offers both convenience and functionality.

Contact us today to schedule a tour or discuss leasing details!

This well-equipped medical clinic includes:

- Reception and checkout areas with a spacious patient waiting area
- Multiple private offices and exam rooms
- Large exam/procedure room
- Dedicated lab, medicine, and x-ray rooms
- Employee break area



PROPERTY PHOTOS

109 Eureka Street, Suite B, Batesville, MS 38606
109 Eureka Street | Batesville, MS 38606



PROPERTY PHOTOS

109 Eureka Street, Suite B, Batesville, MS 38606
109 Eureka Street | Batesville, MS 38606



FLOOR PLAN

109 Eureka Street, Suite B, Batesville, MS 38606
109 Eureka Street | Batesville, MS 38606

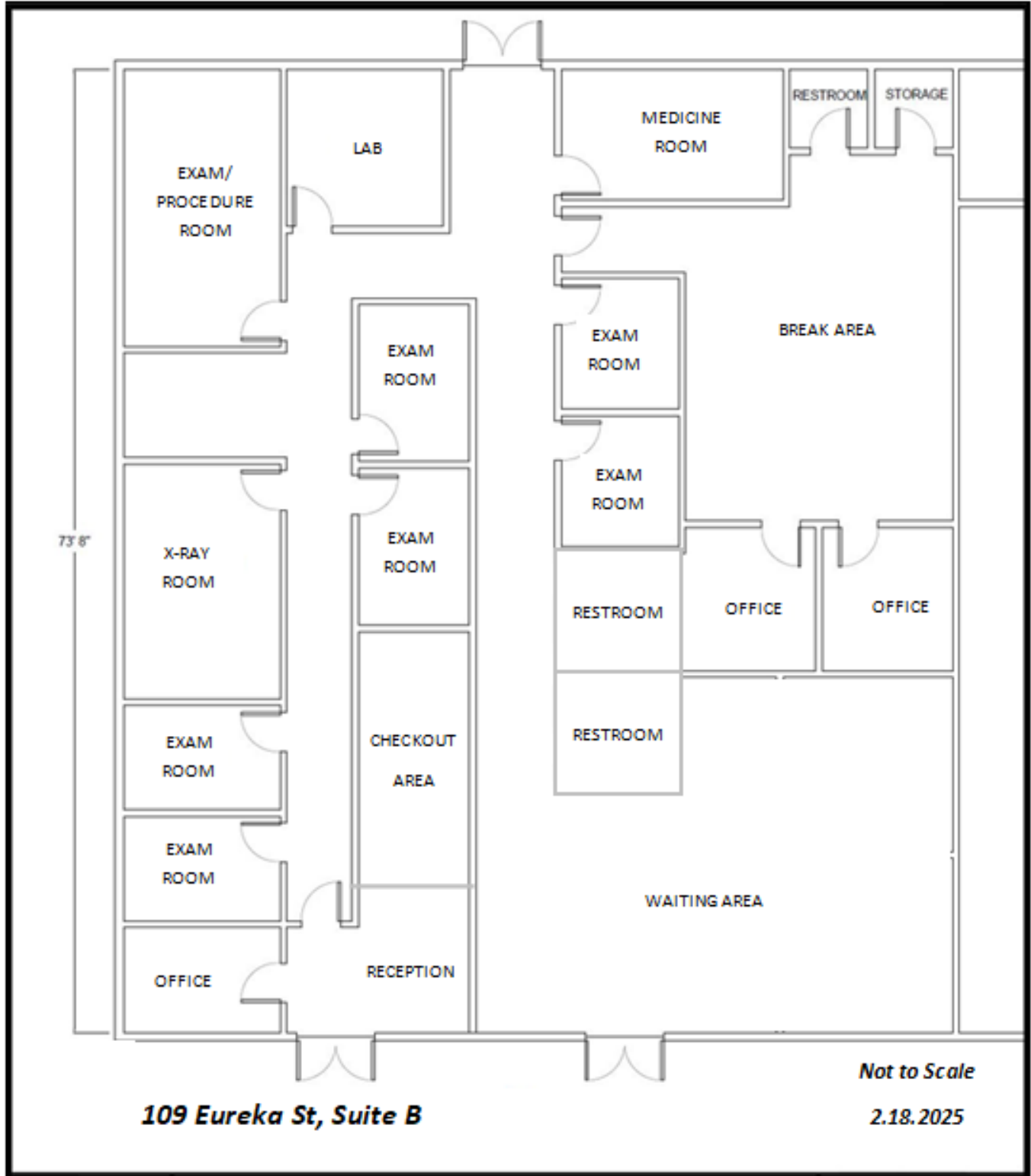

FLOOR PLAN OF CURRENT MEDICAL CLINIC (approximate - not to scale)

BUSINESS MAP

109 Eureka Street, Batesville, MS 38606
109 Eureka Street | Batesville, MS 38606

