

CBRE

# CENTERSTONE PLAZA

4050 BARRANCA, IRVINE, CALIFORNIA 92604



MEDICAL OFFICE FOR LEASE











## Property Description

Centerstone Plaza, in Irvine is a four-building office campus comprised of approximately 158,000 square feet, featuring spacious abundantly landscaped common areas and a striking red brick facade, and includes an on-site management office. Located in a suburban setting in the heart of Irvine, Centerstone Plaza includes two full-service restaurants, and lies within easy walking distance to two major shopping centers. It also affords easy access to and from the San Diego and Santa Ana Freeways. It is a short five-minute drive from the Orange County Airport, Irvine Spectrum, and Newport Beach business districts.

P2 // 4050 BARRANCA, IRVINE, CA, 92604

## Highlights



-  On-site lab and imaging center
-  Parking ratio: 5.5/1,000 SF
-  Free surface parking
-  Institutionally owned and managed
-  Excellent corporate image
-  Easy access to I-405 and I-5
-  Walking distance to numerous nearby amenities
-  Restaurants on site are Mimi's Cafe and 7 Japanese BBQ



# Conceptual Floor Plan

CURRENT AVAILABILITY



1ST FLOOR

## Suite 130



P3 // 4050 BARRANCA, IRVINE, CA 92604

### 1,050 SF

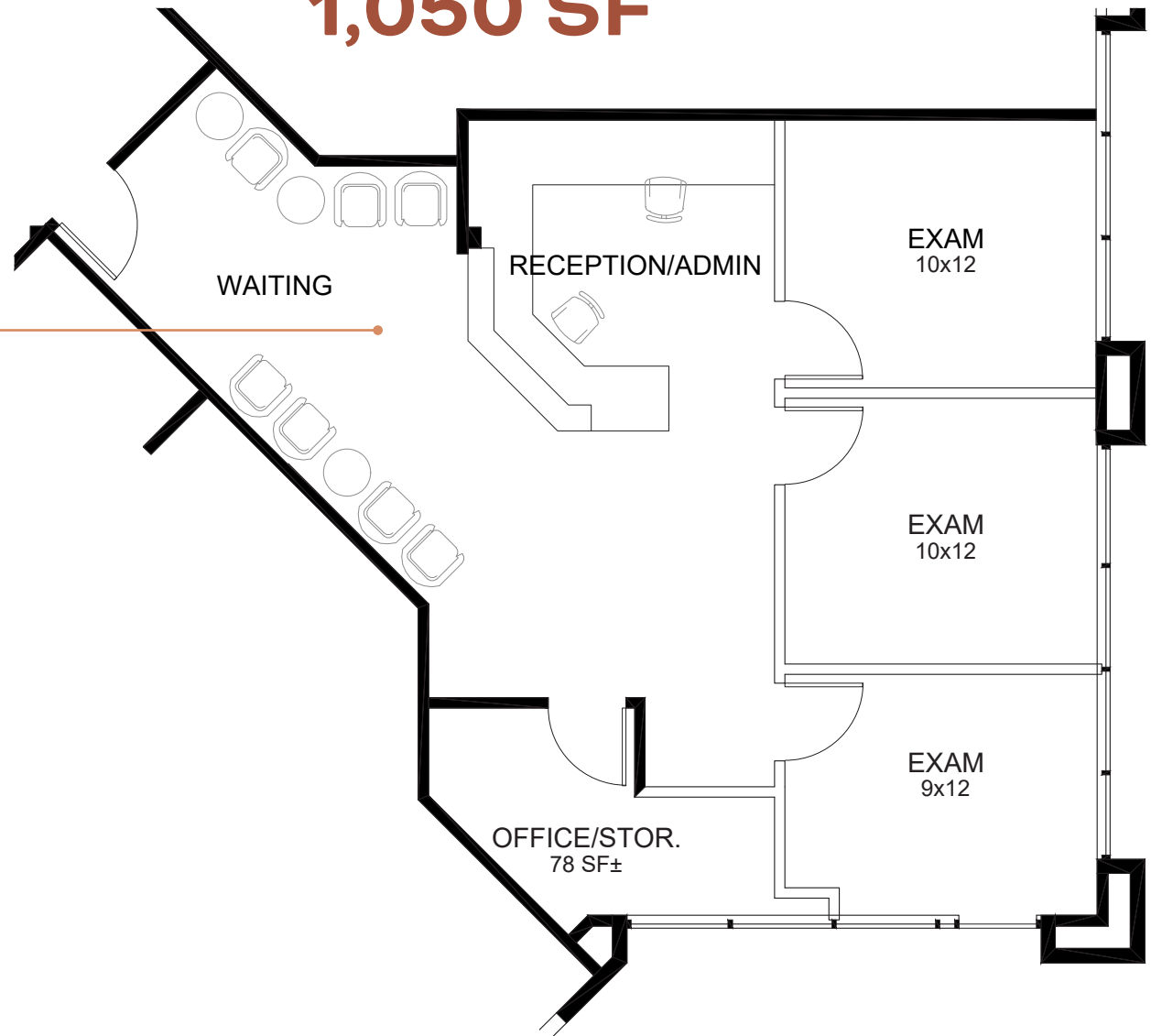



# CENTERSTONE PLAZA

4050 BARRANCA, IRVINE, CA. 92604

## For More Information, Please Contact:

### JOHN SCRUGGS

First Vice President

+1 949 842 5897

John.Scruggs@cbre.com

Lic. 01796826

### ANDREW ROBBEN

+1 949-608-2073

andrew.robben@nrmk.com

Lic. 01372891

©2026 CBRE, Inc. All rights reserved. This information has been obtained from sources believed reliable, but has not been verified for accuracy or completeness. You should conduct a careful, independent investigation of the property and verify all information. Any reliance on this information is solely at your own risk. CBRE and the CBRE logo are service marks of CBRE, Inc. All other marks displayed on this document are the property of their respective owners, and the use of such logos does not imply any affiliation with or endorsement of CBRE. Photos herein are the property of their respective owners. Use of these images without the express written consent of the owner is prohibited.

18401 Von Karman Avenue, Suite 150, Irvine, CA 92612  
(Corporate CA RE License #01355491)

**NEWMARK** **CBRE**