

FOR LEASE



## RENNER BUSINESS CENTER OFFICE SPACE

16825 W 116th Street | Lenexa, KS 66219



### LEASE HIGHLIGHTS

- Up to 7,000 SF Flex/office space in Renner Business Center
- 90 KVA backup generator on site & Fiber internet with backup
- HEPA filtration system, electricity/power sprinklers
- Exterior private entrance to suite
- 6:1,000 Parking ratio
- Monument signage available
- Lease rate: \$17/SF plus share of operating expenses (utilities, trash, janitorial)

**TODD WELTMER**  
tweltmer@Crossroads-KC.com  
M (913) 558-3383

Crossroads Real Estate Group  
O (816) 298-9998  
6200 Mastin Street  
Merriam, KS 66203



**CROSSROADS**  
REAL ESTATE GROUP

# FOR LEASE



## RENNER BUSINESS CENTER OFFICE SPACE

16825 W 116th Street | Lenexa, KS 66219

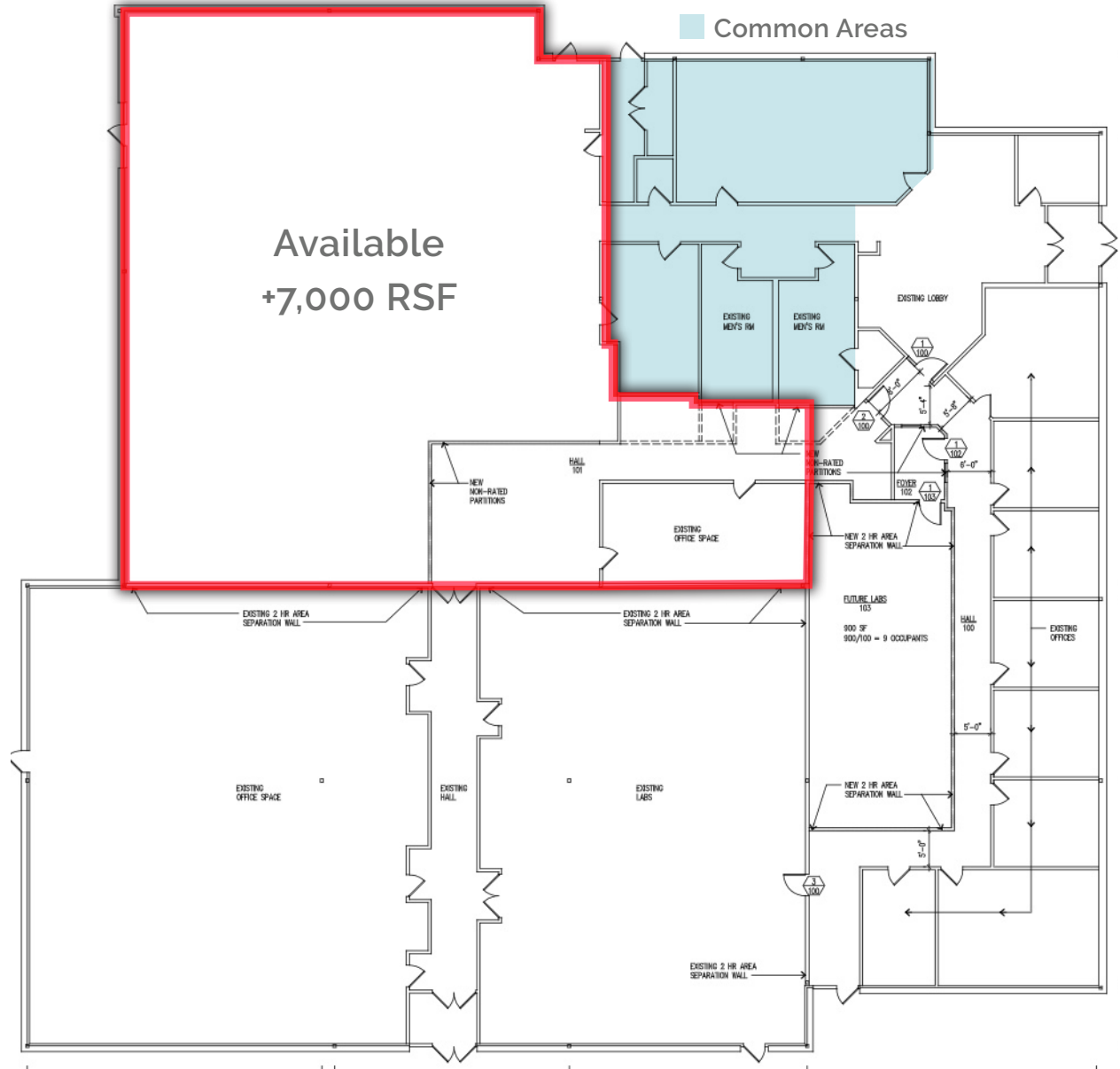

The information contained herein has been obtained through sources deemed reliable by Crossroads Real Estate Group, but cannot be guaranteed for its accuracy. We recommend to the buyer that any information, which is of special interest, should be obtained through independent verification. All measurements are approximate.

Crossroads Real Estate Group  
O (816) 298-9998  
6200 Mastin Street  
Merriam, KS 66203



**CROSSROADS**  
REAL ESTATE GROUP

# FOR LEASE



## RENNER BUSINESS CENTER OFFICE SPACE

16825 W 116th Street | Lenexa, KS 66219

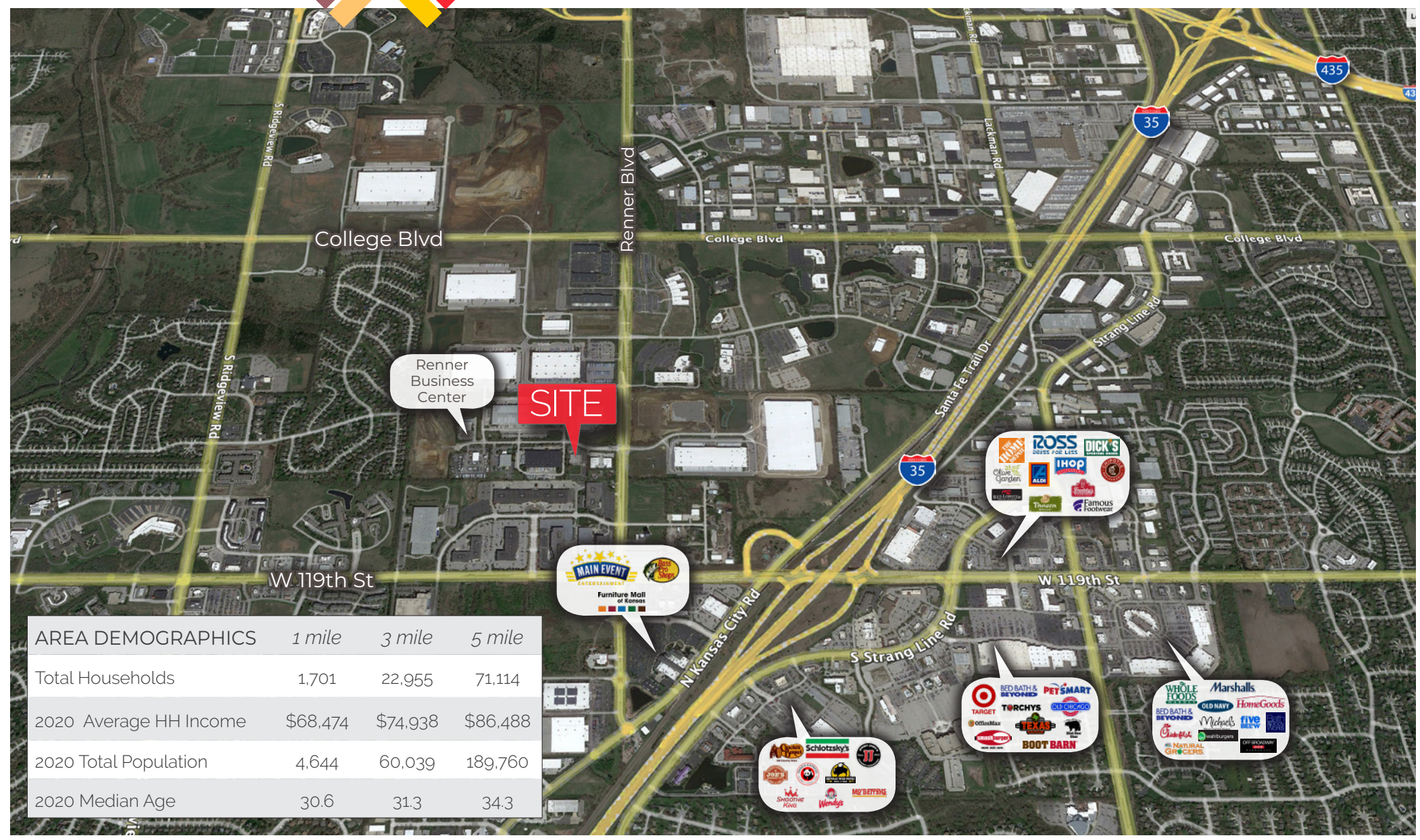

Renner Business Center

**SITE**

| AREA DEMOGRAPHICS      | 1 mile   | 3 mile   | 5 mile   |
|------------------------|----------|----------|----------|
| Total Households       | 1,701    | 22,955   | 71,114   |
| 2020 Average HH Income | \$68,474 | \$74,938 | \$86,488 |
| 2020 Total Population  | 4,644    | 60,039   | 189,760  |
| 2020 Median Age        | 30.6     | 31.3     | 34.3     |

The information contained herein has been obtained through sources deemed reliable by Crossroads Real Estate Group, but cannot be guaranteed for its accuracy. We recommend to the buyer that any information, which is of special interest, should be obtained through independent verification. All measurements are approximate.

Crossroads Real Estate Group  
 O (816) 298-9998  
 6200 Mastin Street  
 Merriam, KS 66203



**CROSSROADS**  
 REAL ESTATE GROUP