

**For Sale**

9,000 SF | Reduced to \$950,000!  
Flex Space



**BROCHURE** | 900 W Chapel Rd Asheville, NC 28803

**For Sale**

9,000 SF | Reduced to \$950,000!  
Flex Space



## 900 W Chapel Rd

Asheville, North Carolina 28803

### Highly Flexible 9,000 SF Building In Prime South Asheville Location

900 West Chapel Road offers a rare opportunity just 150 feet from the signalized intersection at Hendersonville Rd (29,000 VPD) near Biltmore Forest. Formerly a kennel, the building has been cleaned out and reconfigured into a versatile two-level layout, upper level with front parking access and lower level with grade-level rear access and loading. Ideal for a wide range of commercial uses, the property features excellent visibility, strong traffic counts, and easy access to I-40 and I-240. Priced for a quick sale; all offers subject to court approval.

### Offering Summary

Sale Price:	\$950,000
Building Size:	9,000 SF
Zoning:	HB
Lot Size:	0.27 Acres

### For More Information

**Jim Davis, SIOR**

O: 330 718 3311

[jdavis@naibevery-hanks.com](mailto:jdavis@naibevery-hanks.com) | NC #292479

# Nearby Retail

9,000 SF | Reduced to \$950,000!  
Flex Space



**BROCHURE** | 900 W Chapel Rd Asheville, NC 28803

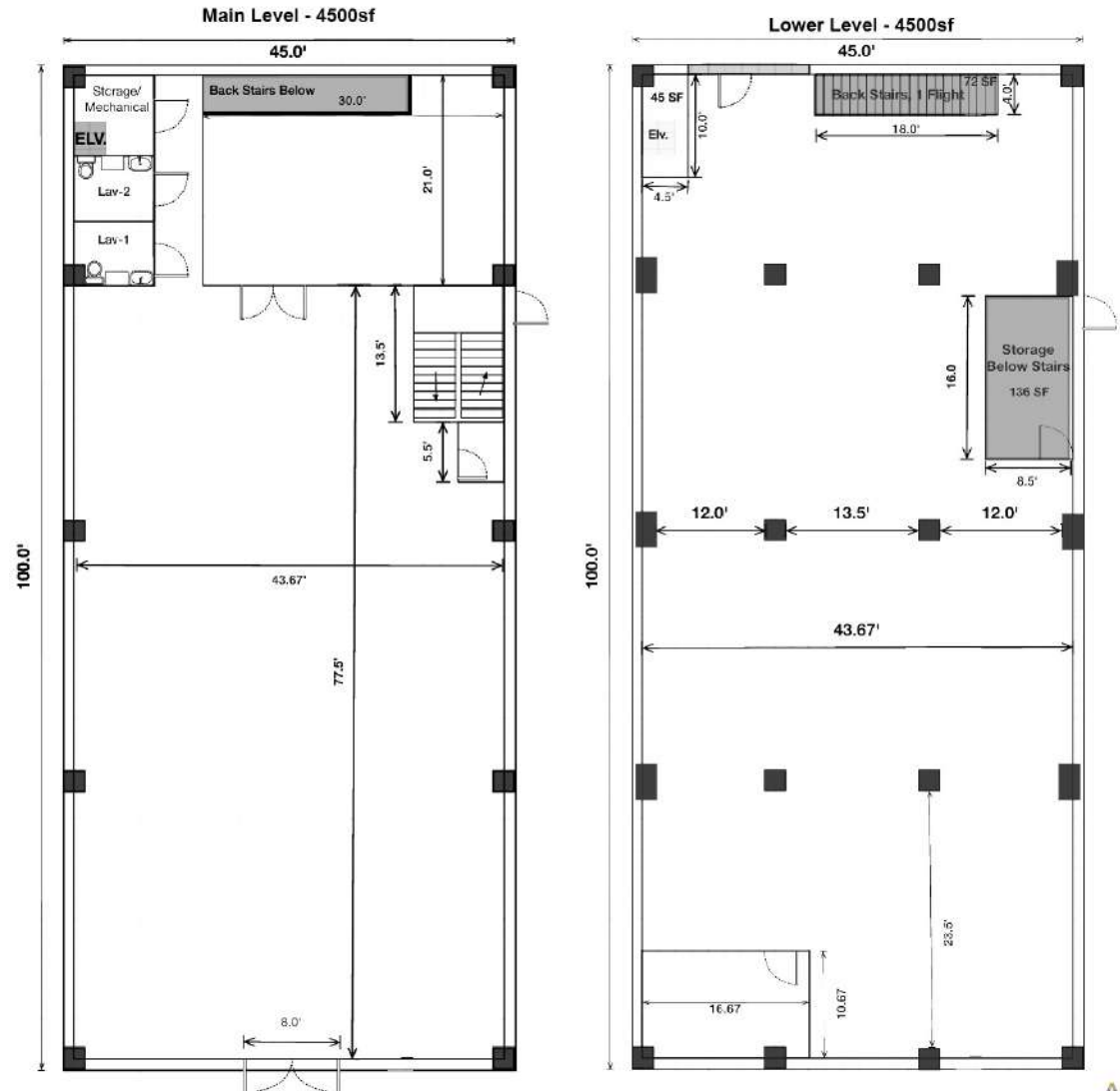

# Exterior Photos

9,000 SF | Reduced to \$950,000!  
Flex Space



**BROCHURE** | 900 W Chapel Rd Asheville, NC 28803

# Interior Photos

9,000 SF | Reduced to \$950,000!  
Flex Space



**BROCHURE** | 900 W Chapel Rd Asheville, NC 28803

Population	0.3 Miles	0.5 Miles	1 Mile
Total Population	647	1,800	4,309
Average Age	43	44	44
Average Age (Male)	42	42	42
Average Age (Female)	45	45	45
Households & Income	0.3 Miles	0.5 Miles	1 Mile
Total Households	304	837	1,859
# of Persons per HH	2.1	2.2	2.3
Average HH Income	\$106,471	\$112,832	\$114,373
Average House Value	\$491,501	\$525,745	\$546,648

Demographics data derived from AlphaMap

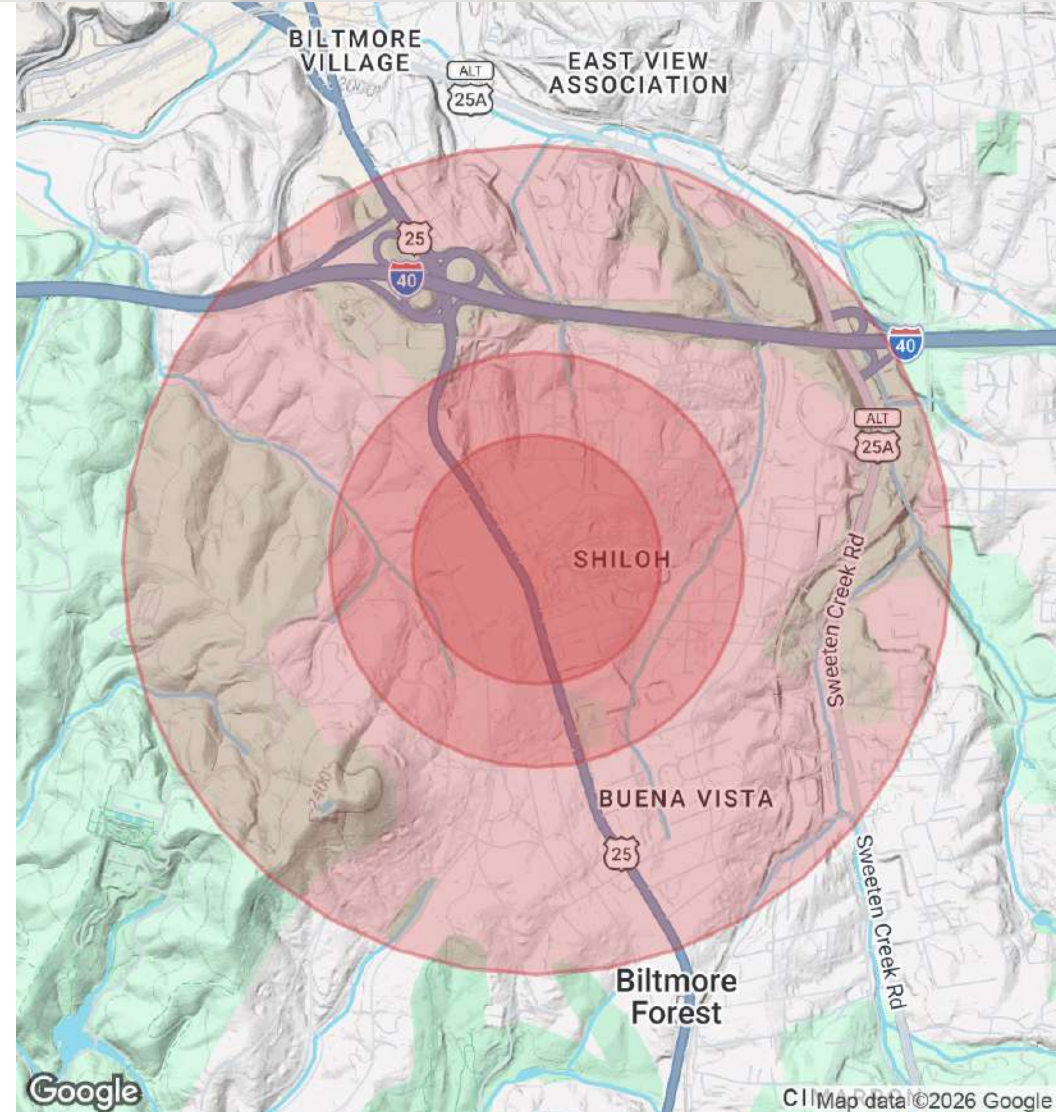

**Jim Davis - Commercial Broker**

NAI Beverly-Hanks | Broad River Capital  
Member Associate, Society Of Industrial and Office Realtors  
North Carolina Economic Development Association Member

Phone: 330-718-3311

Email: [Jdavis@NAIBeverly-Hanks.com](mailto:Jdavis@NAIBeverly-Hanks.com)

