



# THE ROSE GARDEN

@ Intersection of Sycamore Valley Road  
and Camino Ramon in Danville, CA



**km** Kidder  
Mathews

 the econic company®

FOR LEASING  
INFORMATION  
PLEASE CONTACT

**WILL BALLOWE**  
*Vice President*  
T. 925-389-2499  
will.ballowe@kidder.com  
CA RE# 02053125

**MATT SWEENEY**  
*Executive Director*  
T. 925-963-9886  
msweeney@theconiccompany.com  
CA RE# 01746896



# THE ROSE GARDEN



# Amenities & Freeway Access

## DANVILLE





# Highlights



Retail space 982 SF



Numerous on-site amenities including Starbucks, Café Esin, Amici's and Community Bank of the Bay

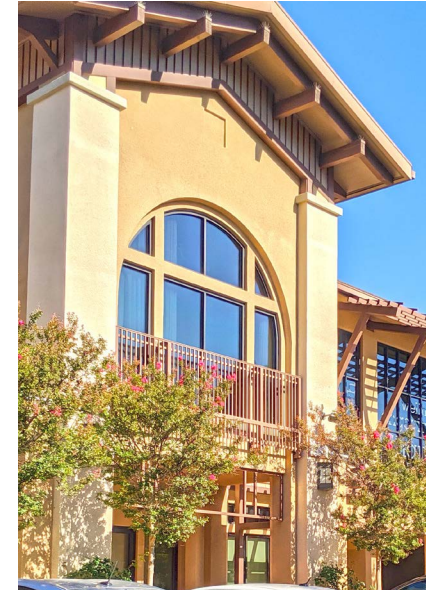



# Floor plan

RETAIL

730 Camino Ramon

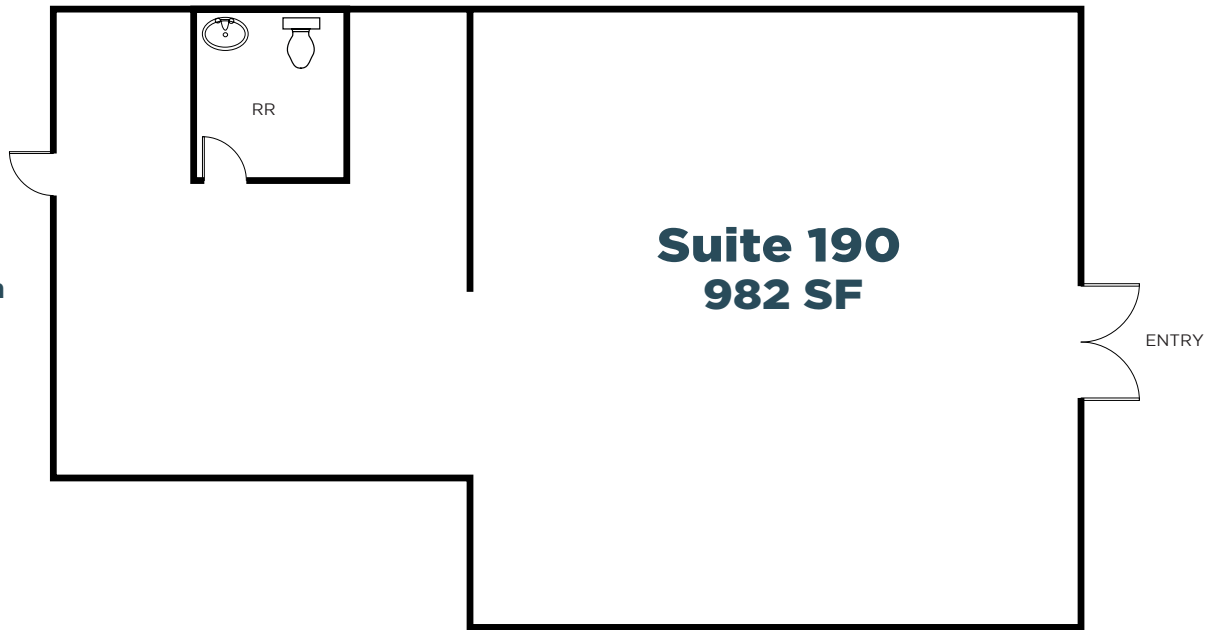

**Suite 190**  
**982 SF**

ENTRY



# Area Demographics

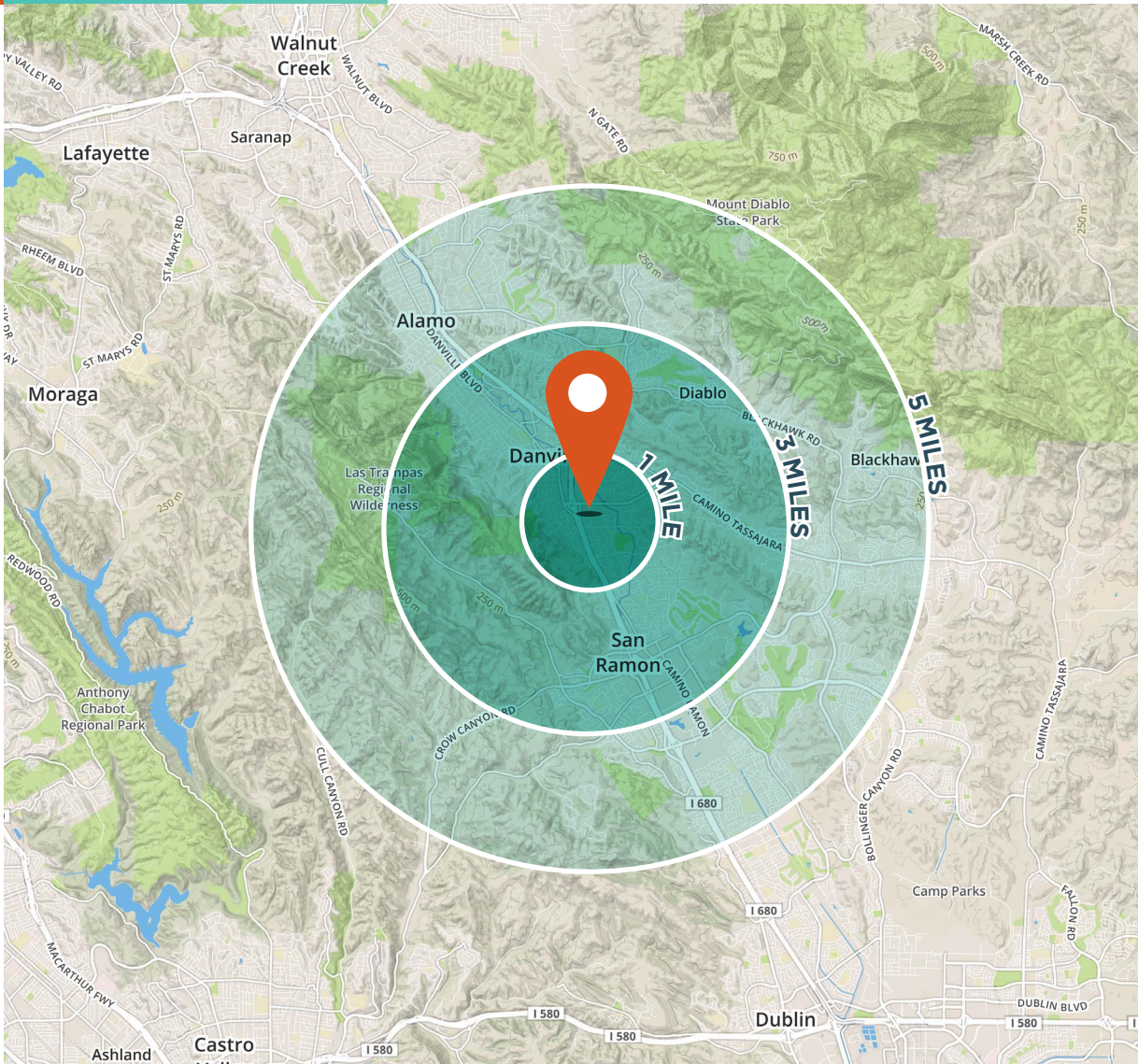

	1 MILE	3 MILES	5 MILES
Population 2024 Estimated	10,812	27,901	51,426

Population 2029 Projected	11,095	28,194	51,523
---------------------------	--------	--------	--------

HH Income 2024 Average	\$265,738	\$281,206	\$291,220
------------------------	-----------	-----------	-----------

HH Income 2029 Projected	\$276,547	\$296,834	\$310,431
--------------------------	-----------	-----------	-----------

### TRAFFIC COUNTS (ADT)

Camino Ramon + Sycamore	7,170
Sycamore + Camino	13,995
I-680	86,137

Source: ©2019 Sites USA

