

# COLISEUM BUSINESS CENTER

FOR LEASE

±3,068 - ±31,084 SF AVAILABLE

READY FOR IMMEDIATE OCCUPANCY

## PROPERTY FEATURES:

- Fully Secured, Light Industrial Business Park
- Functional Existing Office Configurations
- Upgraded Security System in Place
- Dock and Grade Level Loading
- 16'-18' Clear Height
- Quick Access to I-880 via 66th Avenue
- Close Proximity to Coliseum BART Station
- Excellent Parking and Trucking Staging

**ANDREW SCHMIEDER**

Senior Director

+1 510 891 5834

[andrew.schmieder@cushwake.com](mailto:andrew.schmieder@cushwake.com)

LIC #01828740

**TED J. ANDERSON**

Managing Director

+1 510 465 8000

[ted.anderson@cushwake.com](mailto:ted.anderson@cushwake.com)

LIC #01332000

# SPACE HIGHLIGHTS:

6617-6611 SAN LEANDRO STREET

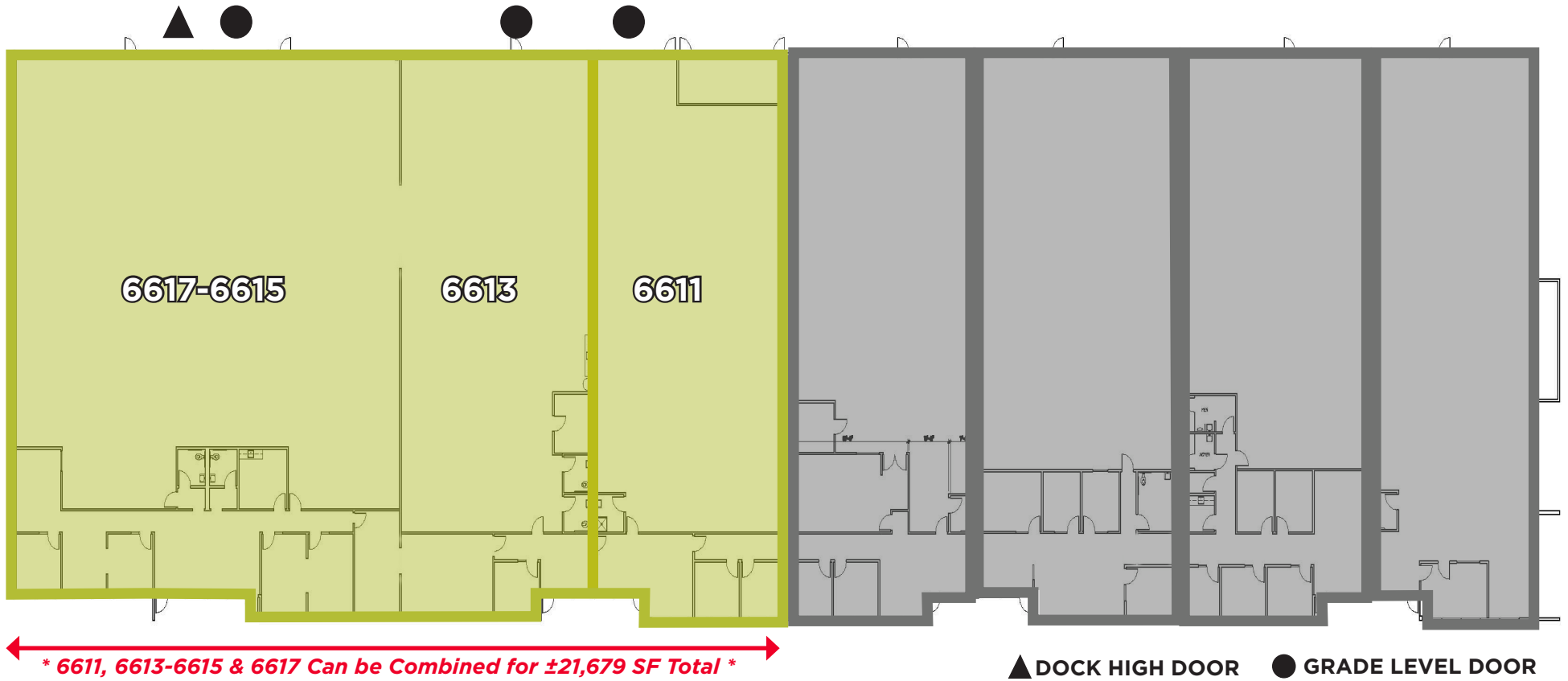

## SPACE HIGHLIGHTS:

UNITS 6617-6615 - \$1.15/SF/MONTH IG + CAM

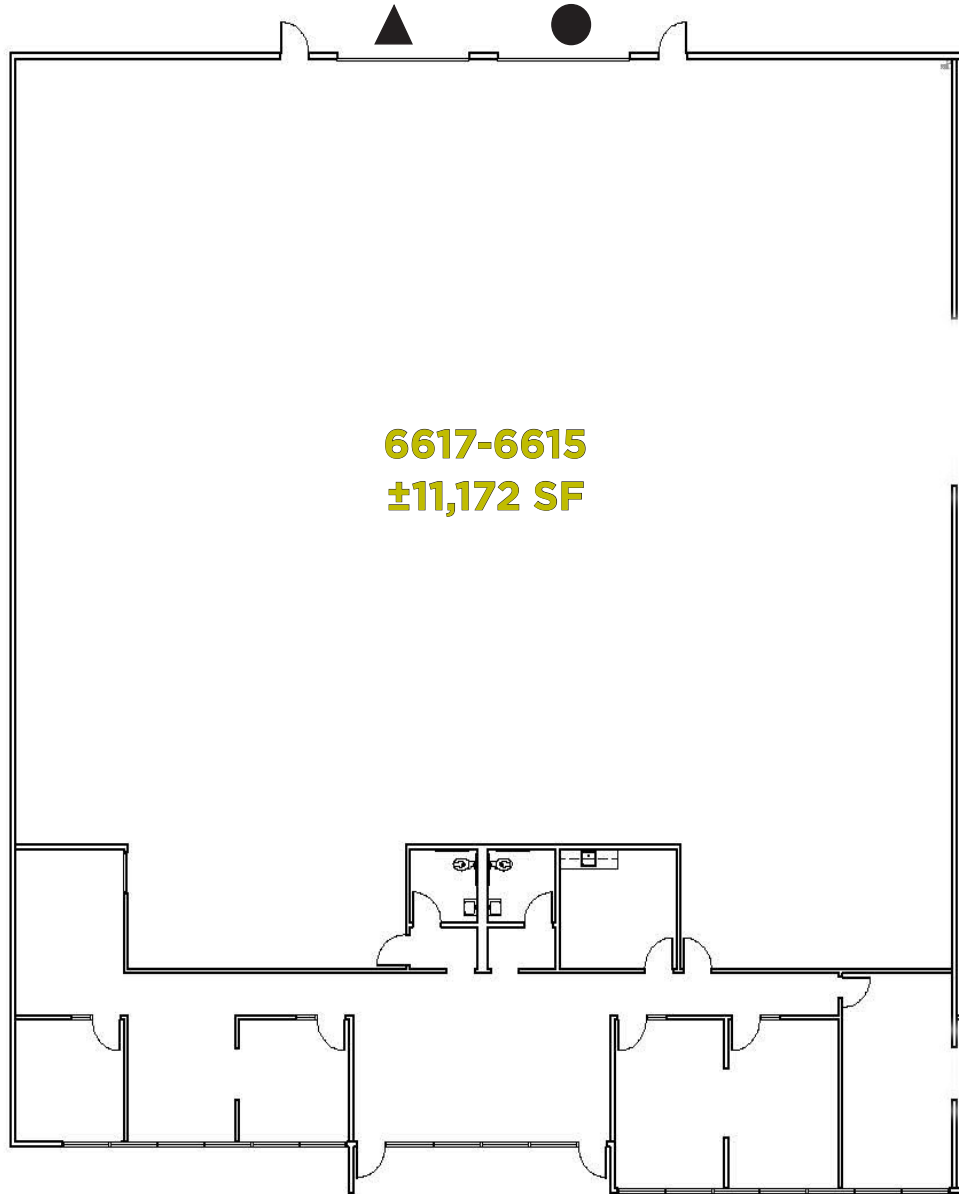

**6617-6615**  
**±11,172 SF**

▲ DOCK HIGH DOOR ● GRADE LEVEL DOOR



UNIT 6617-6615

# SPACE HIGHLIGHTS:

UNITS 6613 & 6611 - \$1.20/SF/MONTH IG + CAM

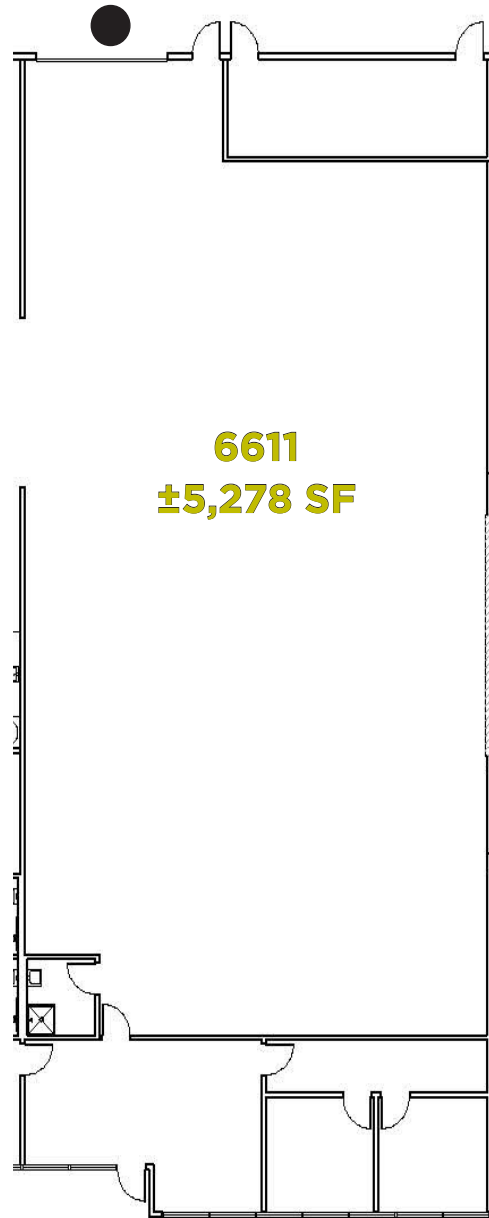

▲ DOCK HIGH DOOR ● GRADE LEVEL DOOR



# SPACE HIGHLIGHTS:

840-852 66TH AVENUE

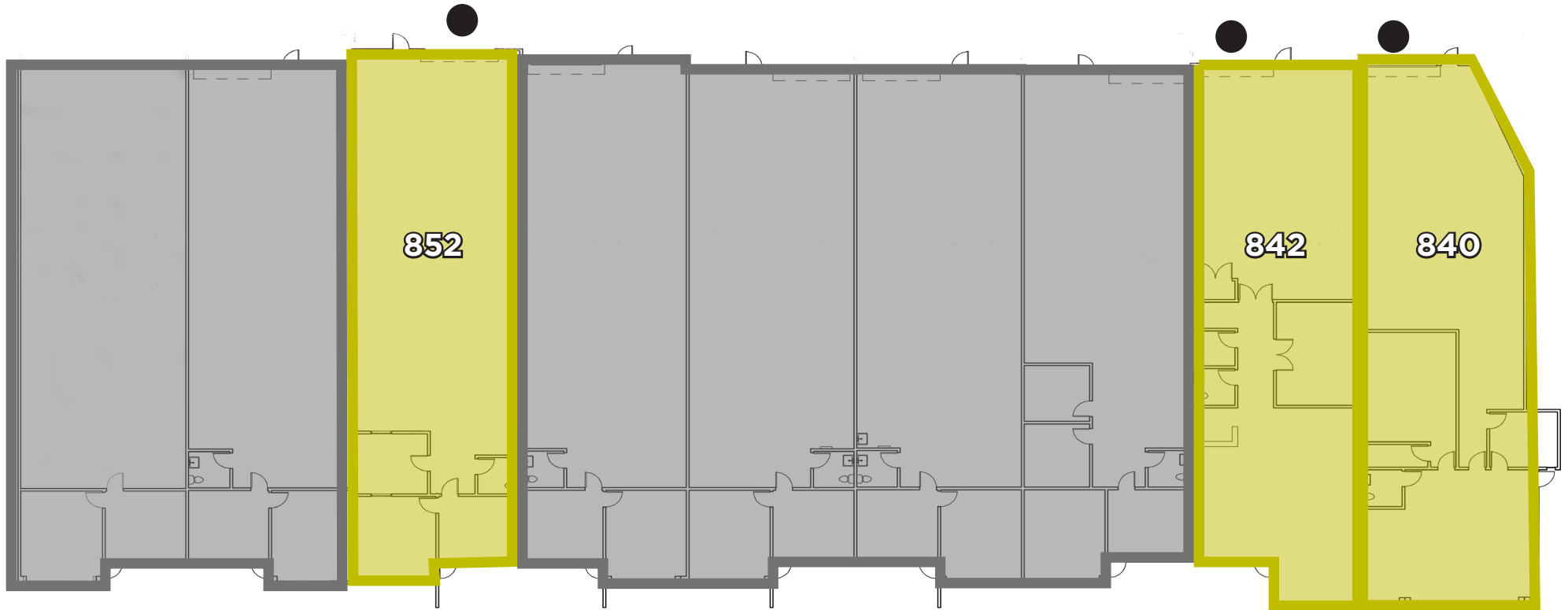

▲ DOCK HIGH DOOR ● GRADE LEVEL DOOR

*\* 840 & 842 66th Ave Can be Combined for ±6,337 SF Total \**

# SPACE HIGHLIGHTS:

UNITS 840-852 - \$1.25/SF/MONTH IG + CAM

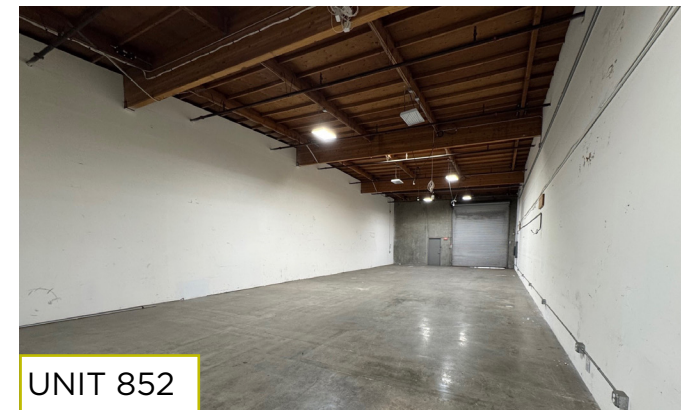
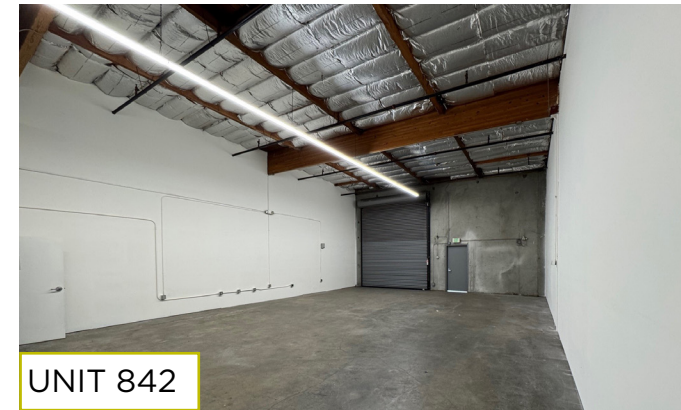

▲ DOCK HIGH DOOR ● GRADE LEVEL DOOR



**FOR MORE INFO CONTACT:**

**Andrew Schmieder**  
Senior Director  
+1 510 891 5834  
andrew.schmieder@cushwake.com  
LIC #01828740

**Ted J. Anderson**  
Managing Director  
+1 510 465 8000  
ted.anderson@cushwake.com  
LIC #01332000

