

101,286 SF AVAILABLE FOR SUBLEASE

# 1675 HOLMES ROAD

ELGIN, ILLINOIS

**FENCED  
&  
SECURED**

**OUTSIDE STORAGE**



1675 HOLMES ROAD  
ELGIN, IL



## PROPERTY HIGHLIGHTS

- Available immediately
- Fenced & secured outside storage
- Immediate access to I-90
- Sublease expiration: July 31, 2026
- Sublease rate: Subject to Offer

### PROPERTY FEATURES

Available Size:	101,286 SF	Power:	1600a @ 480v; 3-Phase
Site Size:	±5.52 AC	Bay Size:	32'X44'
Office Area:	4,177 SF	Heat:	Gas
Clear Height:	26'	Sprinkler:	Wet
Interior Docks:	6	Parking:	129 Stalls
Drive-in Doors:	3	Construction:	Precast

1675 HOLMES ROAD  
ELGIN, IL

SITE  
PLAN

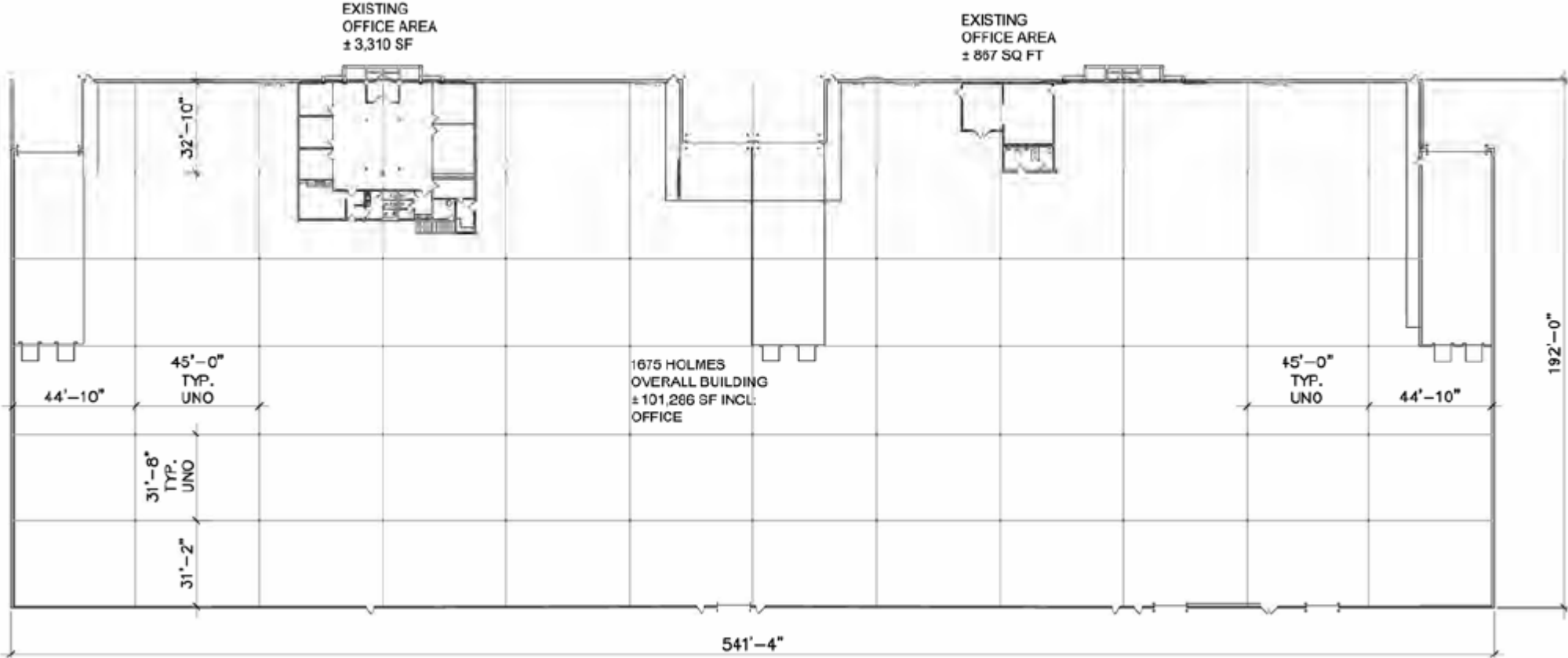

# 1675 HOLMES ROAD ELGIN, IL



6.6 Miles to I-90  
from Randall Road

3.3 Miles to I-90  
from Route 31

N. RANDALL ROAD

BIG TIMBER ROAD





## 1675 HOLMES ROAD ELGIN, IL

**FOR MORE INFORMATION, CONTACT:**

**Doug Pilcher**  
Executive Director  
+ 1 847 518 3285  
[doug.pilcher@cushwake.com](mailto:doug.pilcher@cushwake.com)



©2024 Cushman & Wakefield. All rights reserved. The information contained in this communication is strictly confidential. This information has been obtained from sources believed to be reliable but has not been verified. NO WARRANTY OR REPRESENTATION, EXPRESS OR IMPLIED, IS MADE AS TO THE CONDITION OF THE PROPERTY (OR PROPERTIES) REFERENCED HEREIN OR AS TO THE ACCURACY OR COMPLETENESS OF THE INFORMATION CONTAINED HEREIN, AND SAME IS SUBMITTED SUBJECT TO ERRORS, OMISSIONS, CHANGE OF PRICE, RENTAL OR OTHER CONDITIONS, WITHDRAWAL WITHOUT NOTICE, AND TO ANY SPECIAL LISTING CONDITIONS IMPOSED BY THE PROPERTY OWNER(S). ANY PROJECTIONS, OPINIONS OR ESTIMATES ARE SUBJECT TO UNCERTAINTY AND DO NOT SIGNIFY CURRENT OR FUTURE PROPERTY PERFORMANCE.