

FOR LEASE

1723 George Washington Memorial Hwy

Yorktown, VA 23693



CONTACT

CLAY CULBRETH

Senior Vice President

757 407 2424

clay.culbreth@thalhimer.com



THALHIMER

PROPERTY FEATURES



BUILDING

- Warehouse C
 - 7,500 SF
 - One (1) ADA restroom
 - Fully insulated
 - New LED lights recently installed
 - Wall fans
 - Large grade level door (10' w x 14' h)
 - 16' - 18' 5" clear
 - Free span

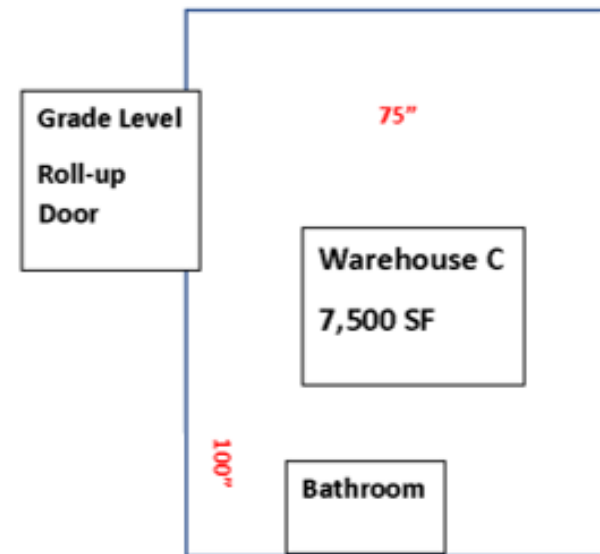

PROPERTY HIGHLIGHTS

SITE

- Total Acres: 2.66
- Direct exposure to George Washington Memorial Highway (Route 17)
- Zoned GB - General Business
 - Permitted use information provided upon request
- Utilities to the site – water (included in rent), electric, no gas, septic
- Fenced yard – 8' chain link fence, 40' x 100", 20' opening, cleared and graded

LEASING INFORMATION

- \$8 PSF, NNN for warehouse space
- First month's rent and security deposit equal to first month's rent are due upon lease signature
- 5-year lease preferred
- Operating expenses estimated at \$0.60 PSF



EXTERIOR



Ample Laydown Yard

Independently Owned and Operated / A Member of the Cushman & Wakefield Alliance

Cushman Wakefield | Thalhimer © 2025. No warranty or representation, express or implied, is made to the accuracy or completeness of the information contained herein, and same is submitted subject to errors, omissions, change of price, rental or other conditions, withdrawal without notice, and to any special listing conditions, imposed by the property owner(s). As applicable, we make no representation as to the condition of the property (or properties) in question.