

Westpark Pavilion Land For Sale



Executive Summary

WestPark is a mixed-use project consisting of land and space available for most commercial uses located on West Main St, a primary commercial development corridor in Tupelo. Featuring over ¼ mile of frontage, the traffic volume at the site averages 16,000 to 18,000 vehicles per day. Controlled access is provided by a traffic signal located at the project's primary drive. Current occupants include Lost Pizza Company, El Agave Restaurant, Ford Physical Therapy, ExpressCare, and Huey Magoo's Restaurant (currently under construction). The property is ideally located directly across Main Street from Tupelo's busiest gathering place and sports-plex, Ballard Park. The park hosts multiple regional sporting events each year and is host to the majority of youth sports played in the area. It is undeniably one of the most consistent traffic drivers in NE MS. In addition to the park and occupants already operating in the project, noteworthy neighbors include an elementary school, Tupelo Airport, and several bank branches. The land is divided into 3 tracts which can be divided further, sold in tracts as depicted on the site plan, or combined and sold as one tract.



Tract Key	Size	Price
A, B, and C	8.6 +/- acres	TBD
A	3.1 +/- acres	\$8.00 / SF
B	1.6 +/- acres	\$6.00 / SF
C	3.9 +/- acres	\$6.00 / SF

Aerial View



Existing Businesses

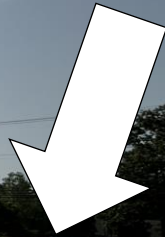

COMING SOON!

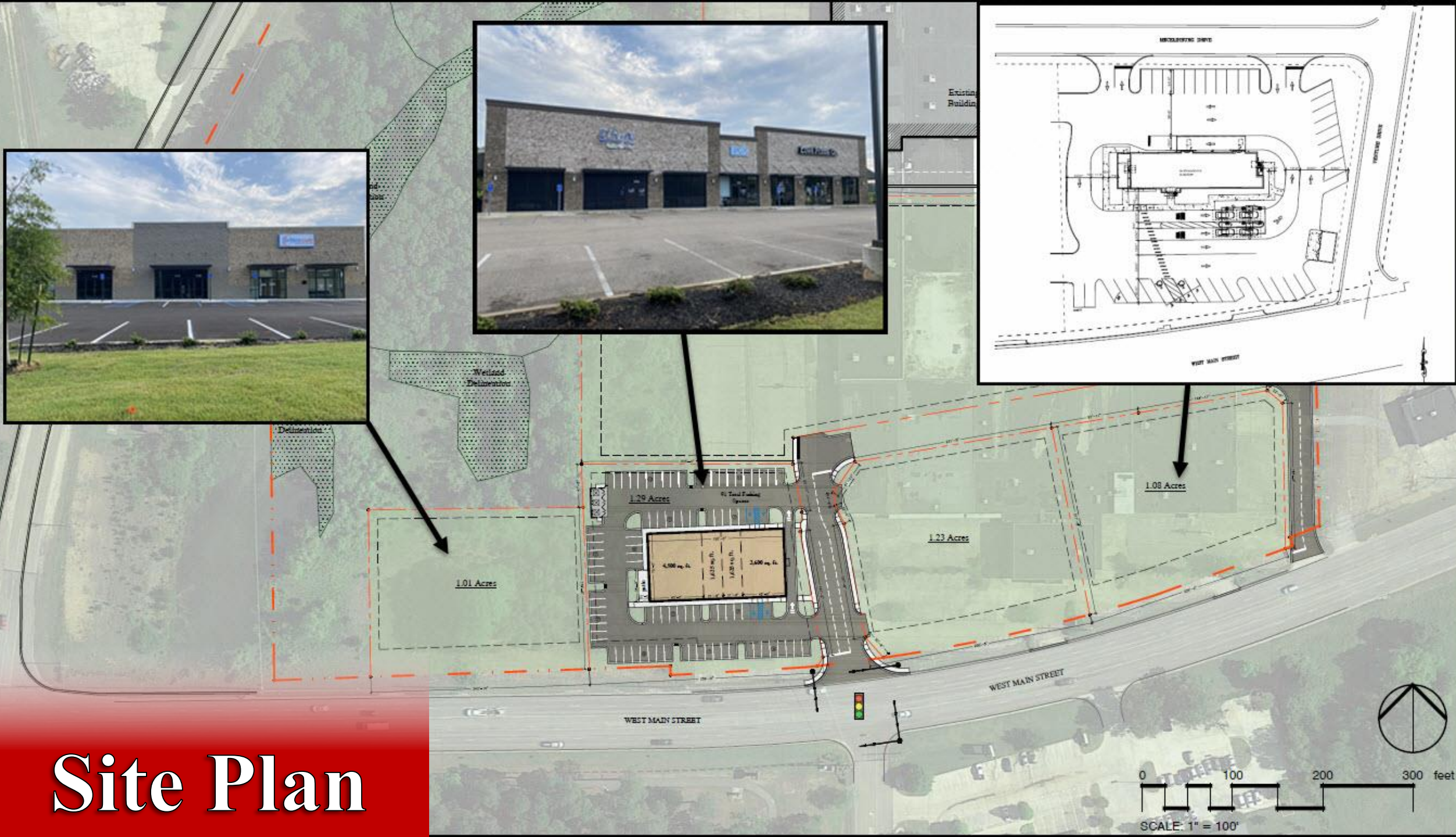
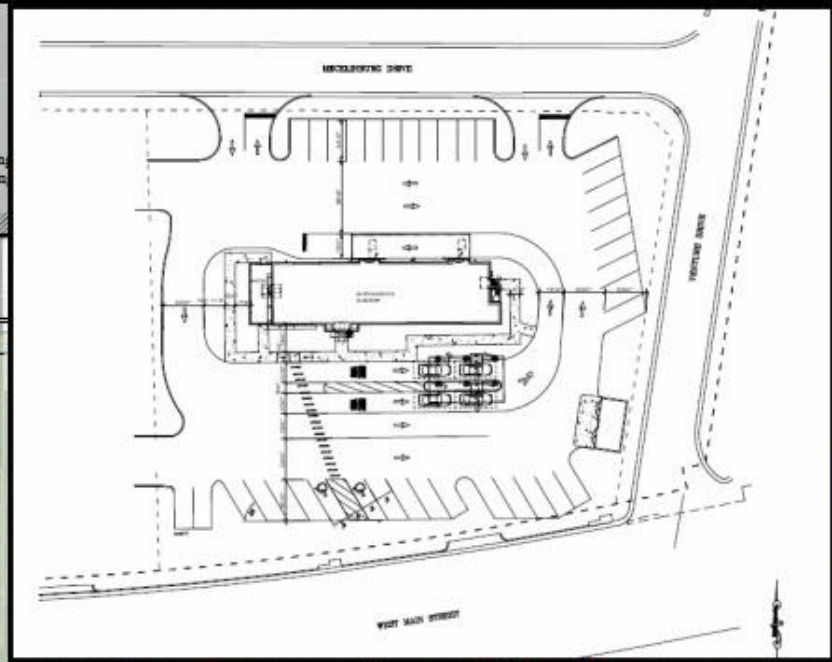

Site Plan

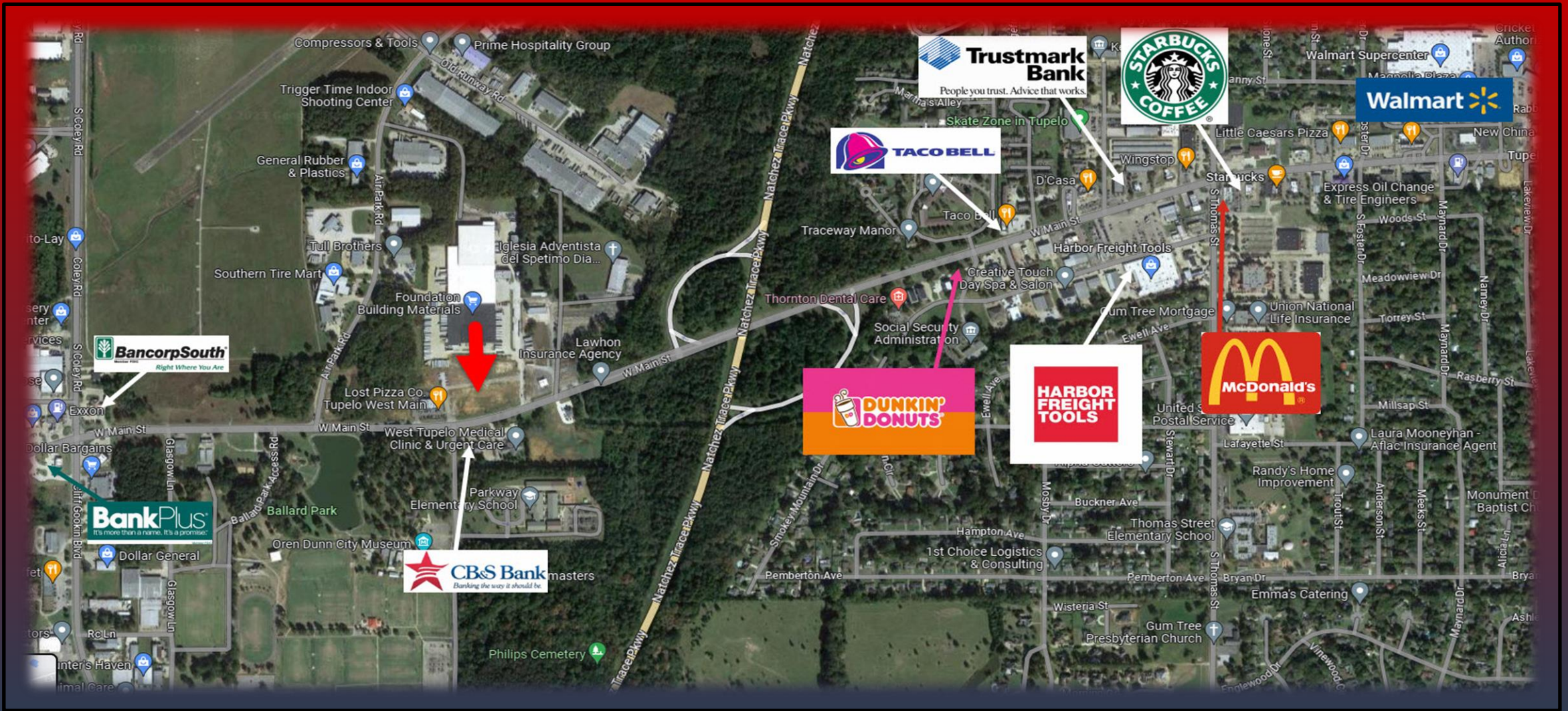

Contact Information

CLAY SHORT
662-842-8283 o
662-231-4262 m
cshort@trirealestate.net

CHRIS WINDERS
662-842-8283 o
662-255-4404 m
chris@trirealestate.net

