



2141 EAST HIGHLAND AVENUE

PHOENIX, ARIZONA 85016

+/- 19,239 Square Feet, Suite A-200

\$38.25 Per Square Foot

Sublease Term: 60 Months (Beginning 1/1/2027)

Class A Office Building

Abundant On Site Amenities

Covered Parking

Monument Signage Available

Close Proximity to SR-51

Full 5% Commission to Buyer's Broker

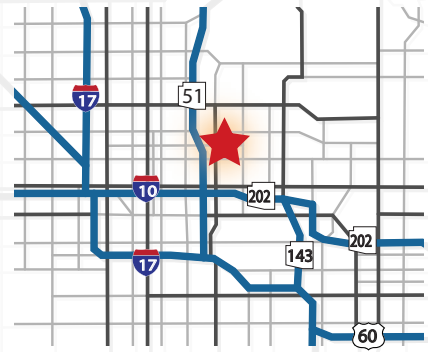

Bo Sederstrom

Executive Vice President
602.330.1917
bo@citywidecre.com

2122 East Highland Avenue, Suite 225 • Phoenix, Arizona 85016 • 602.313.1000 • citywidecre.com

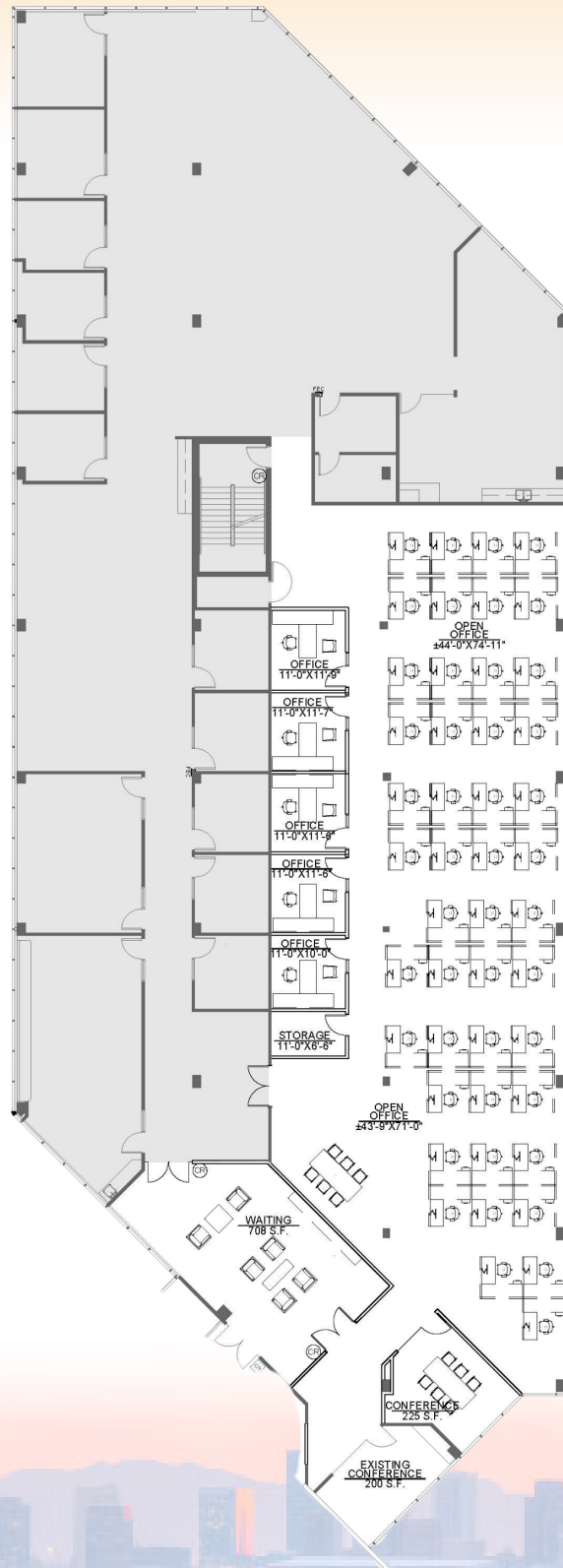

Bo Sederstrom

Executive Vice President
602.330.1917
bo@citywidecre.com

2122 East Highland Avenue, Suite 225 • Phoenix, Arizona 85016 • 602.313.1000 • citywidecre.com