

22 Battery

Retail For Lease

977 Sq Ft Available

Join...

Flywheel Coffee Roasters
& Boichik Bagels!

URBANGROUP

RETAIL

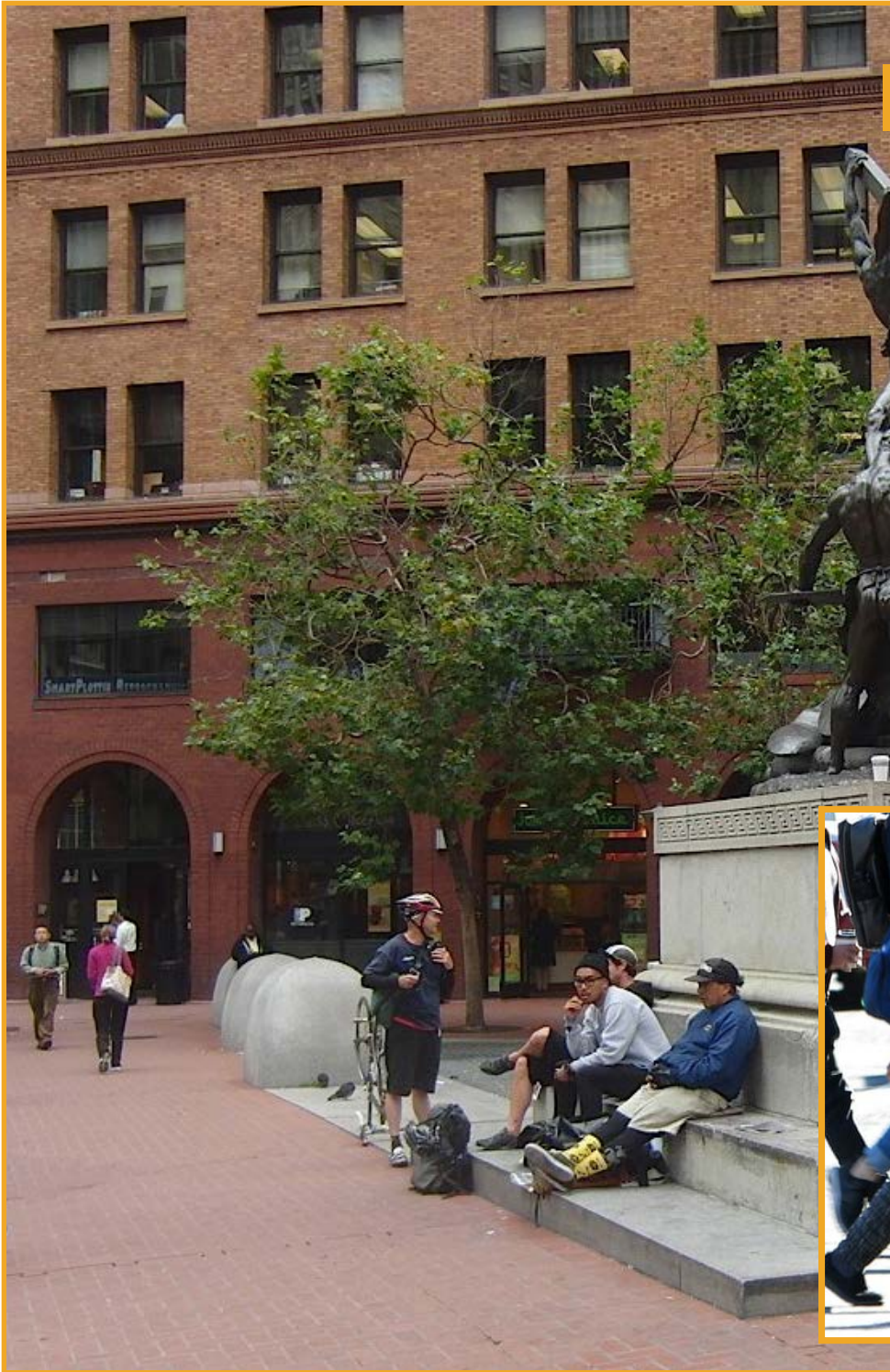

THE PERKS

- ✓ C-3-O Zoning – Formula retail is welcomed
- ✓ Massive exposure on high-traffic block on Market Street
- ✓ Easy walk to BART, MUNI
- ✓ 1 block from Salesforce Tower & Salesforce Park
- ✓ Opportunity for outdoor seating

Neighborhood Tenants Include:

The Melt, Philz Coffee, Joe & the Juice, Noah's Bagel, Chipotle, First Republic Bank, Chase Bank, SoulCycle



FLOOR PLAN

Suite B
977 Sq Ft
\$3.00 PSF NNN

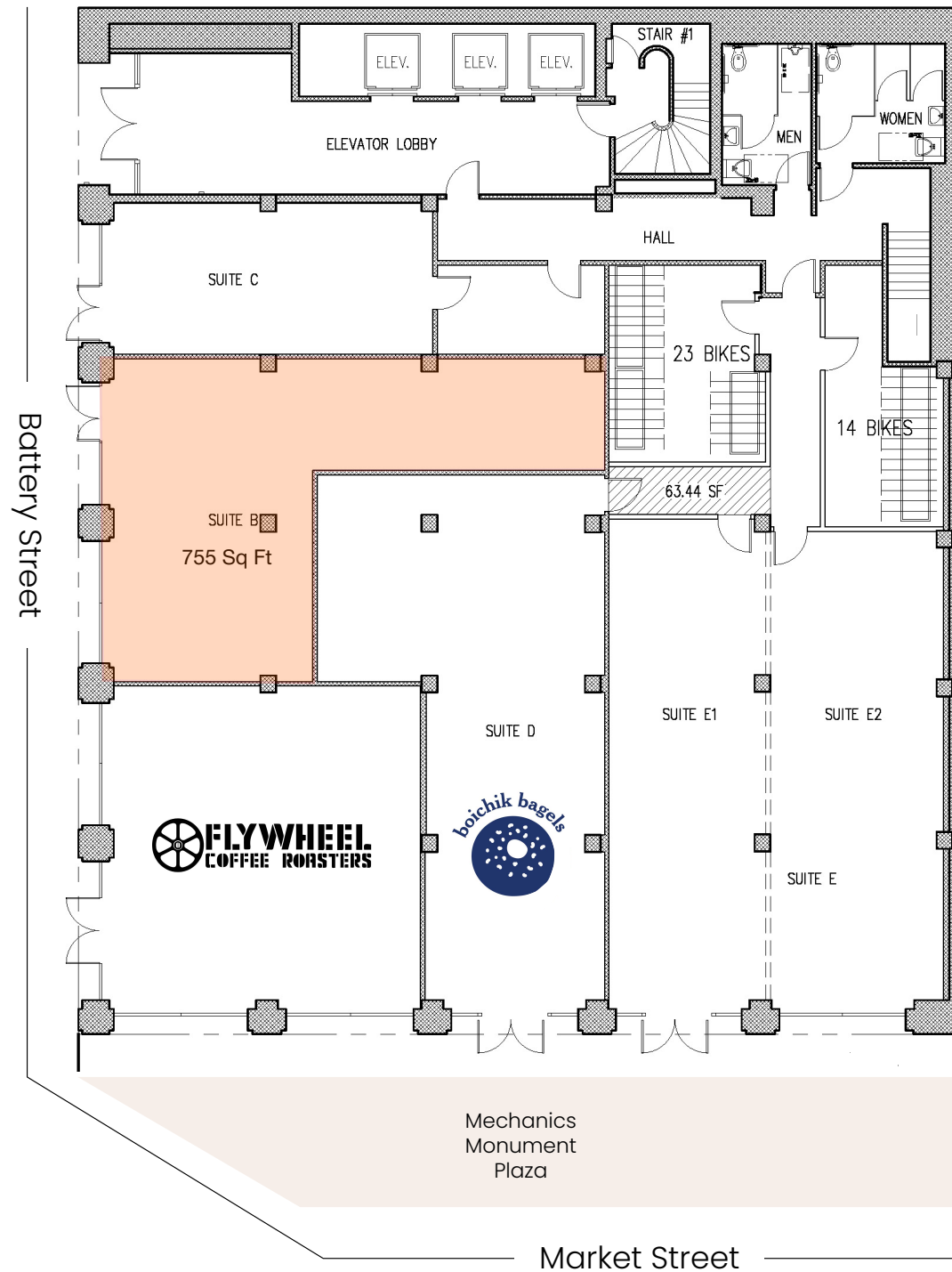

The floor plans shown should not be relied on as representation, expressed or implied. Floor plans and square footage are approximate and may be more or less than the actual size or design. Prospective buyers are advised to verify all measurements in field using their own professionals.

AREA MAP



URBANGROUP

RETAIL

DRE# 01885834

LOUIS CORNEJO

C: 415.786.3662

O: 415.863.1775

louis@urbangroupsf.com

DRE# 01518102

The information contained herein has been secured from sources believed to be reliable. It is not guaranteed, however, and should be verified prior to consummating any transaction.