

VICINITY MAP  
(NOT TO SCALE)

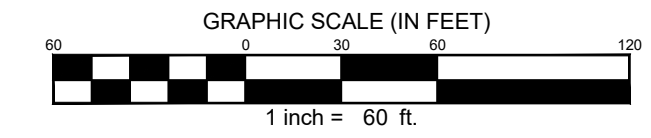
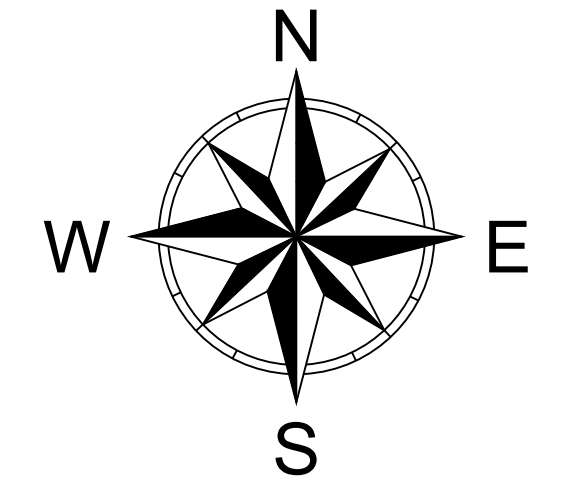

**GENERAL SITE INFORMATION:**

OWNER:  
IRELAND M LLC  
860 CHERRY ROAD  
CLARKSVILLE, TN 37042

CURRENT ZONING: C-5  
DEED REF. # VOL. 2101, PG. 2079  
TAX MAP NO. 53, PARCEL NO. 148.01, 148.04, 148.06

TOTAL ACREAGE: 489,154 SF (11.22 ± ACRES)

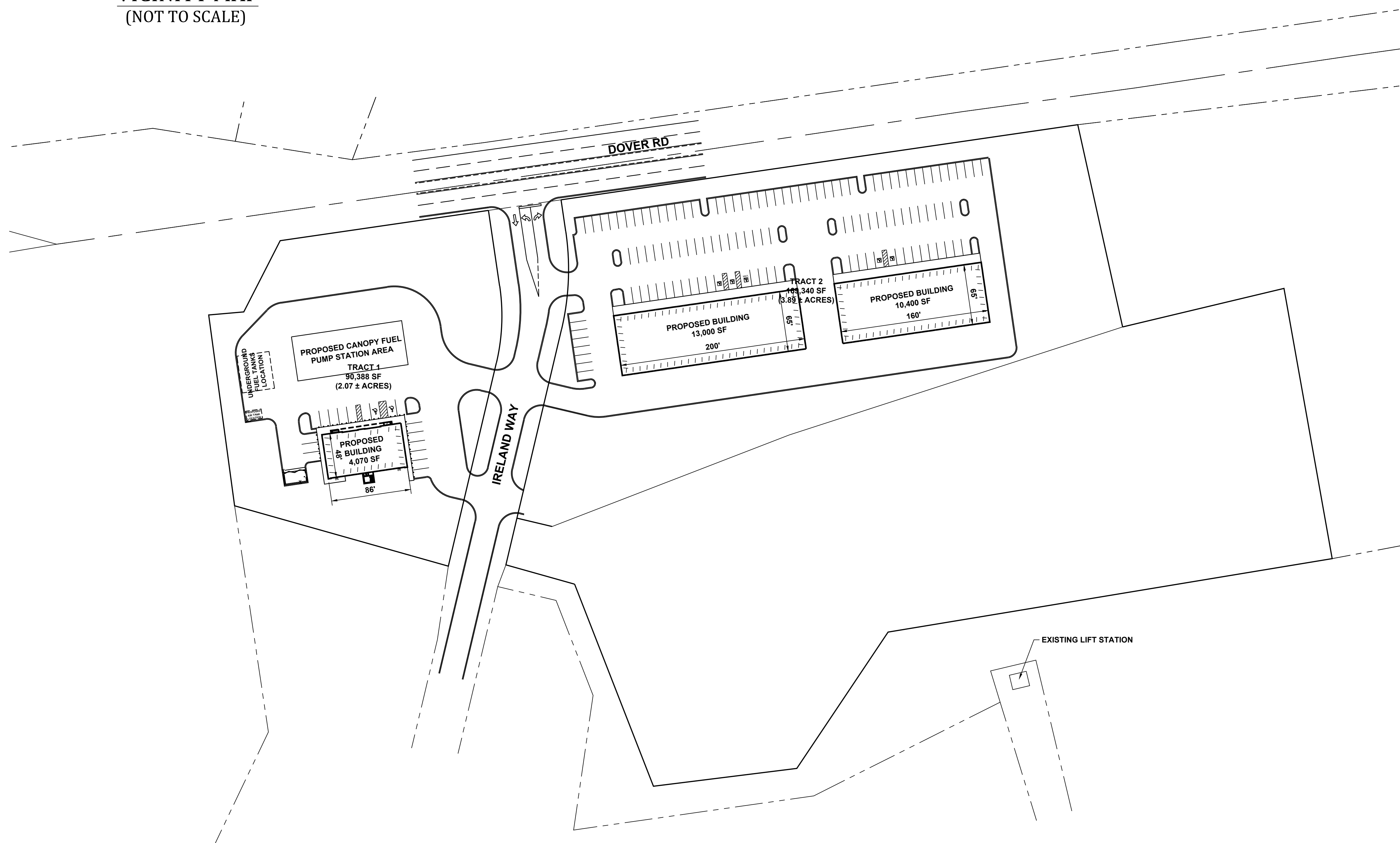

**SITE LEGEND**

- LOT LINE
- - - PROPERTY LINE
- - - BOUNDARY LINE
- - - TREE LINE
- - - ROADWAY CENTERLINE
- G — GAS MAIN & SERVICE LINE
- UE — UNDERGROUND ELECTRIC
- W — WATER MAIN & SERVICE LINE
- SA — SANITARY SEWER MAIN & SERVICE
- STORM SEWER LINE
- P — OVERHEAD POWER LINE
- E — UNDERGROUND ELECTRIC
- PUDE
- MBSL
- X — FENCELINE
- STREAM LINE
- SF — SILT FENCE
- - - EXISTING CURB
- T — UNDERGROUND TELEPHONE
- W — PROPOSED WATER MAIN (SIZE TBD)
- SA — PROPOSED SANITARY SEWER
- EXISTING IRON PIN
- PROPOSED IRON PIN
- \* STREET LIGHT
- ⊙ UTILITY POLE
- ⊙ POWER POLE
- ⊙ SANITARY SEWER MANHOLE
- ⊙ STORM SEWER INLET
- ⊕ BENCHMARK
- ⊕ WATER VALVE
- ⊕ WATER METER
- ⊕ FIRE HYDRANT
- ⊕ ELECTRICAL TRANSFORMER
- ⊕ TELEPHONE BOX

**GENERAL NOTES:**  
1. All utility locations based on location of utilities by local utility authorities and visible field location by others. There is no guarantee that no other utilities either public or private are not displayed on this survey.  
2. All site lighting shall be directed inward with shielded hoods. No light shall spill on adjacent property.

ISSUED FOR:  PERMITTING  BID PURPOSES  CONSTRUCTION

REVISIONS

COMMENTS

DATE

IRELAND COMMERCIAL PROPERTY

PRELIMINARY SITE LAYOUT

DOVER ROAD, CLARKSVILLE  
MONTGOMERY COUNTY, TENNESSEE  
November 29, 2022

1545 Madison Street  
Clarksville, TN 37040  
Ph # 931-245-3095

**MCKAY-BURCHETT**  
& COMPANY  
ENGINEERS

FILE: 2019080318  
(Ireland Property)\Ireland  
Commercial.dwg

DRAWN BY: K.COOK  
CHECKED BY: C.BURCHETT

SHEET: PRE. 1.00