

**RETAIL/RESTAURANT
AVAILABLE**

DUNLAP ROAD (43,743 CPD)

INTERSTATE 17 (23,113 CPD)

Denny's

Conn's

Taco Boy's
Tacos al Carbon

Chevron

Jack
in the box

U-HAUL

MIDAS

**extended
STAY AMERICA**

Shell

**JOIN ONO HAWAIIAN BBQ
4,433 SF AVAILABLE**

**8941 N. BLACK
CANYON HWY
PHOENIX, AZ**

Andy Kroot
602.430.8580
Andy@CRE8Advisors.com

Eddie Gonzalez
602.510.2204
Eddie@CRE8Advisors.com

PROPERTY SUMMARY

8941 N. BLACK CANYON HWY
PHOENIX, AZ

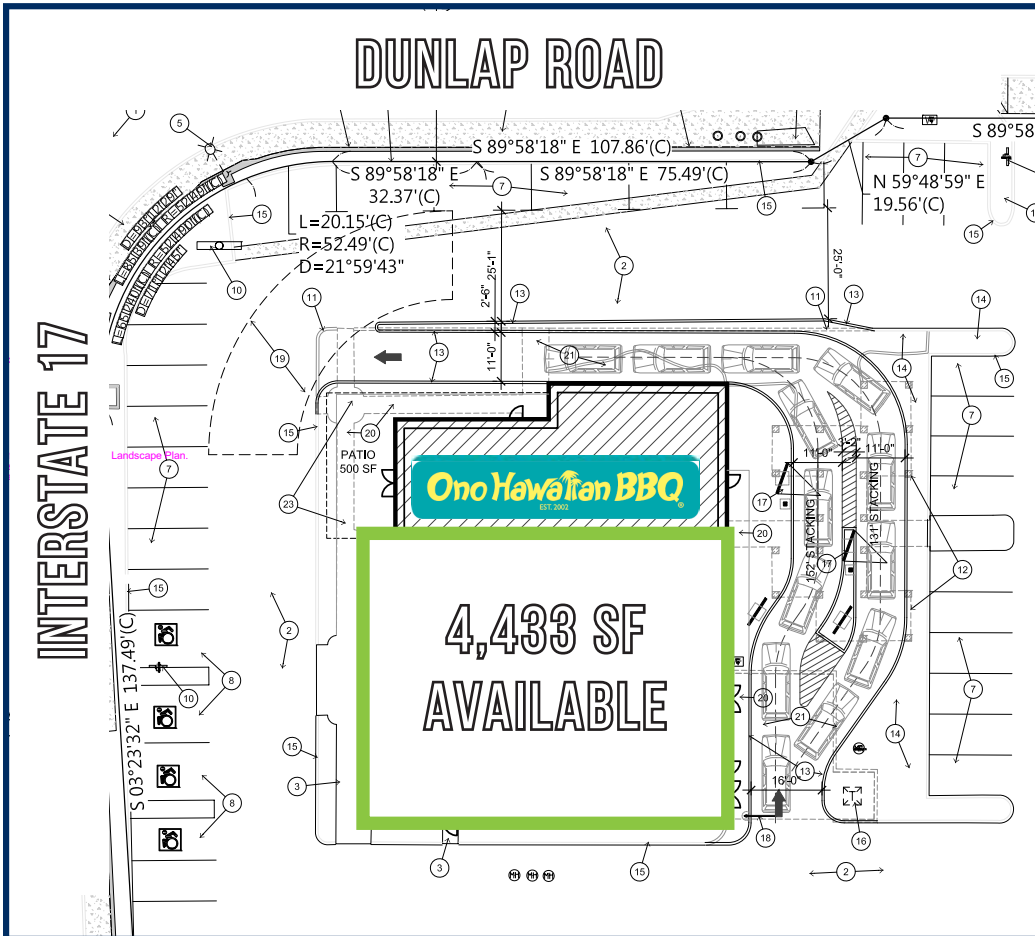

PROPERTY SUMMARY

ASKING RENT:	CALL FOR PRICING
LAND AREA:	1.74 ACRES
BUILDING SF:	7,458 SF
AVAILABLE SF:	4,433 SF
APN:	158-01-001A

PROPERTY HIGHLIGHTS

- Join Ono Hawaiian BBQ
- Call for Pricing
- 4,433 SF Available
- Located on Dunlap Road immediately off I-17 which sees over 188,963 CPD
- The 65-acre property includes a majority of the former 1.4 million-square-foot mall, except for the Walmart Supercenter and self-storage facility, both of which will remain in place.
- The \$850 million redevelopment, to be called the Village, will feature a multifamily hub with 2,600 units around central gathering spaces and 150,000 square feet of commercial space including ground-floor retail and a hotel.
- Situated in a highly dense area more than 459,000 people within 5 miles

PROPERTY DEMOGRAPHICS

	1 MILE	3 MILE	5 MILE
2024 Population:	17,908	183,723	459,639
2029 Population:	19,354	198,392	495,728
2024 Total Households:	6,992	67,736	170,347
Average Household Income:	\$57,397	\$71,445	\$77,519

8941 N. BLACK CANYON HWY
PHOENIX, AZ

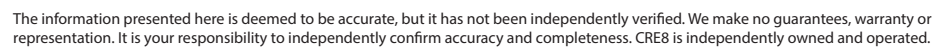

LOCATION AERIALS

8941 N. BLACK CANYON HWY
PHOENIX, AZ

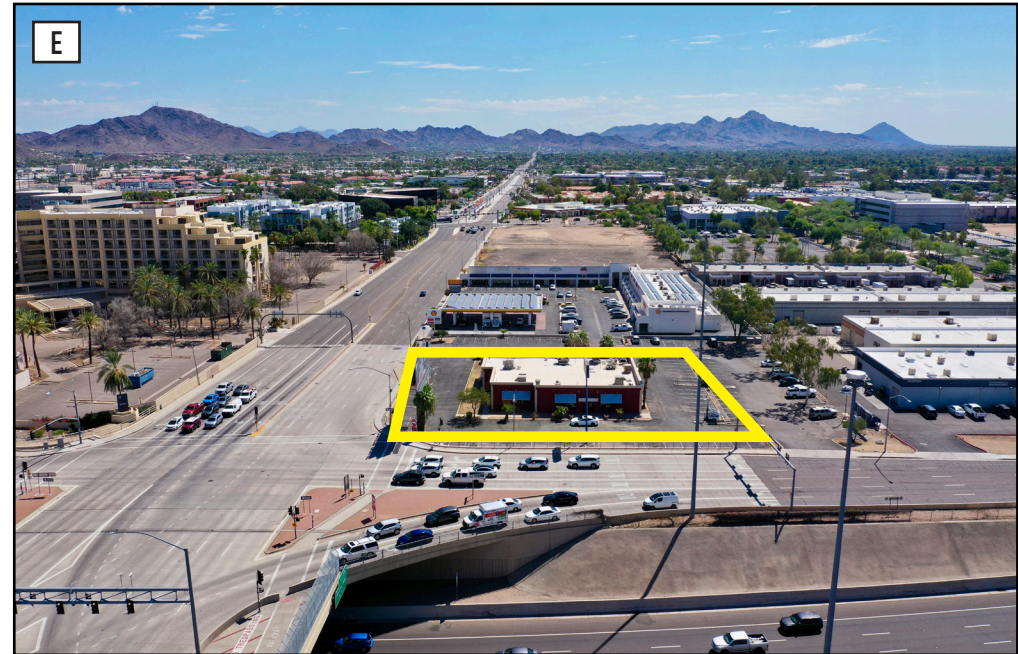

Potential Monument
Signage Available

AERIAL MAP

8941 N. BLACK CANYON HWY
PHOENIX, AZ





For Additional details contact the team
by phone at: (602) 888. CRE8
or by email: Lindsey@CRE8Advisors.com