

1355 Lawrence Drive Newbury Park, CA 91320

Industrial Suite for Lease



WESTCORD

951 S. WESTLAKE BLVD., SUITE 101
WESTLAKE VILLAGE, CA. 91361
WWW.WESTCORD.COM

JIM HENNESSY
805.497.4557 X243
jimh@westcord.com
DRE# 01893383

This information has been furnished from sources which we deem reliable, but for which we assume no liability. The information contained herein is given, in confidence, with the understanding that all negotiations pertaining to this property be handled through the submitting office. All measurements are approximate.

1355 Lawrence Dr., Suite 104 Newbury Park, CA 91320

FOR LEASE

- **Suite #104 +/- 900 SF**
- **Available Now**
- **Modified Gross Lease—NO CAM**
- **Rent: \$1,400/Month (\$1.56/SF)**
- **10X10 roll-up door**
- **Newly painted, private restroom and office**
- **+/- 12.5' ceiling height**
- **Tenant responsible for metered utilities- water and trash included in rent.**
- **NO automotive uses permitted**
- **Parking: 2 reserved**

Please call broker to show



**Ideal Location in Conejo Valley—
Newbury Park.**

**Near: Amgen, banks and
restaurants, Lowes, and many other
convenient businesses.**



951 S. WESTLAKE BLVD., SUITE 101
WESTLAKE VILLAGE, CA. 91361
WWW.WESTCORD.COM

JIM HENNESSY
805.497.4557 X243
jimh@westcord.com
DRE# 01893383

1355 Lawrence Dr., Suite 104
Newbury Park, CA 91320

FLOORPLAN

SUITE 104

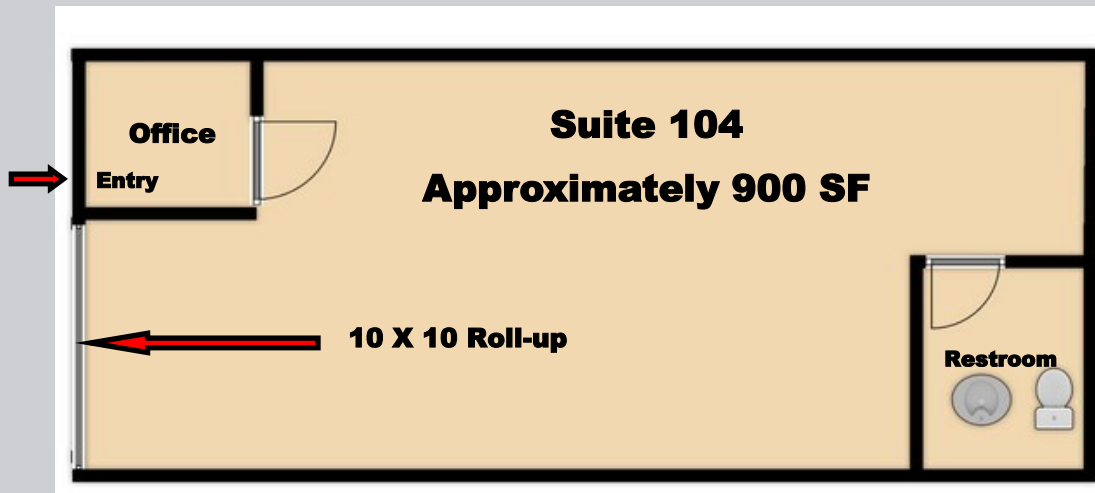

WESTCORD

951 S. WESTLAKE BLVD., SUITE 101
WESTLAKE VILLAGE, CA. 91361
WWW.WESTCORD.COM

JIM HENNESSY
805.497.4557 X243
jimh@westcord.com
DRE# 01893383

This information has been furnished from sources which we deem reliable, but for which we assume no liability. The information contained herein is given, in confidence, with the understanding that all negotiations pertaining to this property be handled through the submitting office. All measurements are approximate.