

FOR LEASE

1,006 - 2,702 SF

Remodeled Northeast Office Space

2524 NE Division St., Bend, OR 97703



SUITE 150



SUITE 250



SUITE 250

PROPERTY DETAILS

Suite 150: 1,006 SF | \$1.65/SF/Mo. NNN

Suite 250: 1,696 SF | \$1.65/SF/Mo. NNN

Suite 150 & 250: 2,702 SF | \$1.55/SF/Mo. NNN

NNNs: Est. at \$0.58/SF/Mo.

Zoning: Commercial Limited (CL)

Parking: Ample Parking

HIGHLIGHTS

- Suite 150 consists of a reception/open work area and a conference room
- Suite 250 consists of a reception area, two open work areas, a conference room and a kitchenette
- Excellent visibility on NE Division Street
- Monument signage available
- Located across the street from Riverview Park
- Easy access to Downtown, SE 3rd Street and Highway 97

Grant Schultz, SIOR, CCIM | Russell Huntamer, CCIM
Eli Harrison, Broker

600 SW Columbia St., Ste. 6100 | Bend, OR 97702

541.383.2444 | www.CompassCommercial.com

COMPASS
COMMERCIAL

REAL
ESTATE
SERVICES

FOR LEASE

1,006 - 2,702 SF

Remodeled Northeast Office Space

2524 NE Division St., Bend, OR 97703



SUITE 150



SUITE 150



SUITE 250



SUITE 250

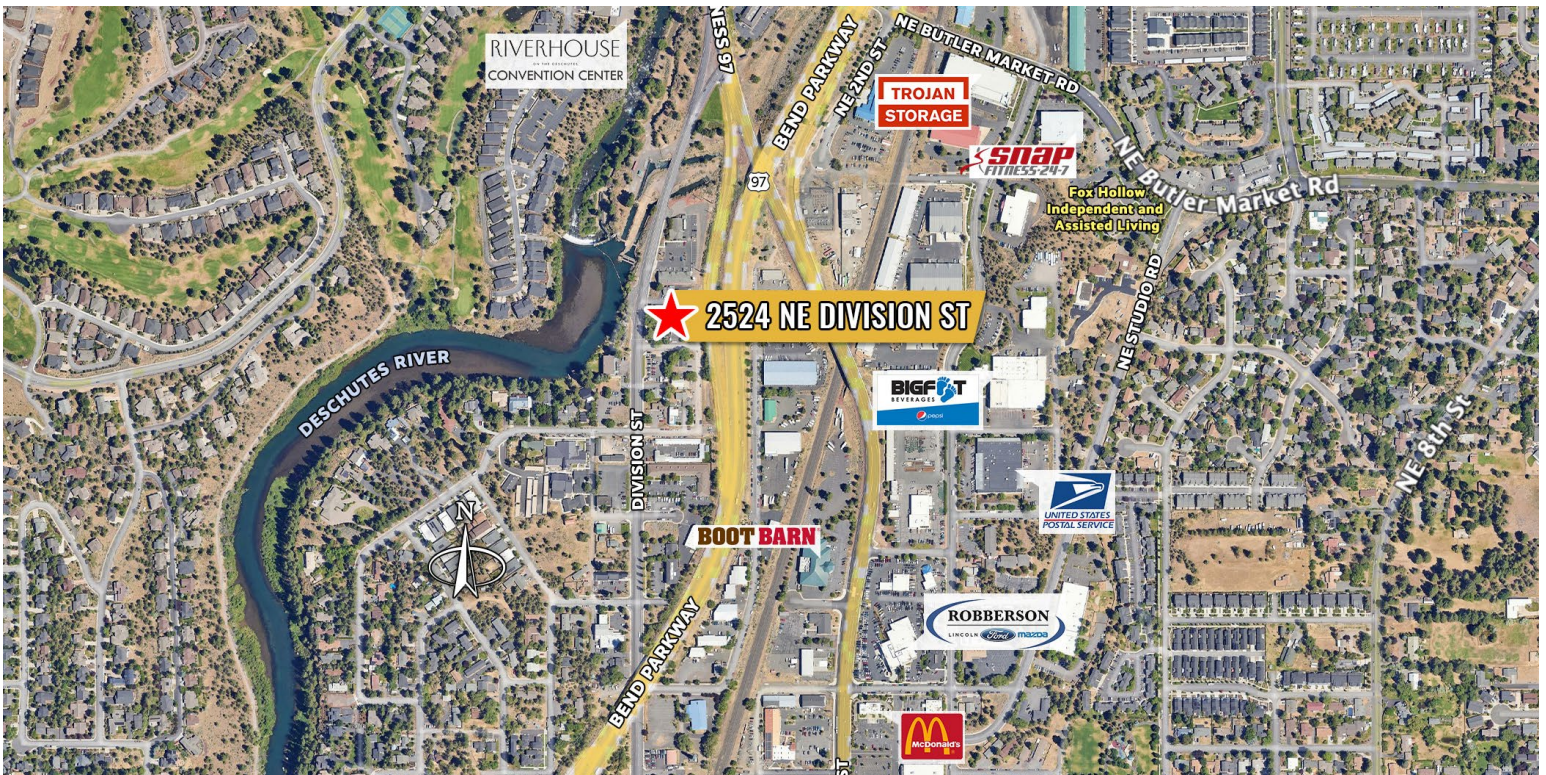

Brokers are licensed in the state of Oregon. This information has been furnished from sources we deem reliable, but for which we assume no liability. This is an exclusive listing. The information contained herein is given in confidence with the understanding that all negotiations pertaining to this property be handled through Compass Commercial Real Estate Services. All measurements are approximate.



Grant Schultz, SIOR, CCIM
Broker
Cell 541.480.9873
gschultz@compasscommercial.com



Russell Huntamer, CCIM
Partner, Principal Broker
Cell 541.419.2634
rh@compasscommercial.com



Eli Harrison
Broker
Cell 541.977.2890
eharrison@compasscommercial.com

COMPASS
COMMERCIAL
REAL ESTATE
SERVICES