

# 88,098 SF

Industrial Space For Lease



## Prologis Bloomingdale



280 Madsen Drive, Suite 100  
Bloomingdale, IL 60108 USA

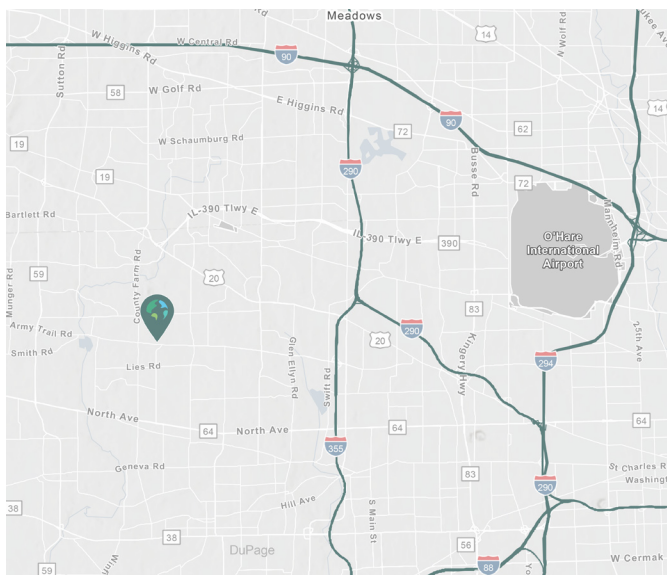

### LOCATION

- Professional Business Park setting located within Prologis' Bloomingdale Business Center
- Close proximity to I-390, I-355 and I-290

### FACILITY

- 148,413 sf building
- 88,098 sf available
- 9,240 SF - east office | 6,998 SF mezzanine office
- 2,150 SF - west office area
- 576 SF - warehouse office area
- 29' clear height
- 22 exterior docks (7 with levelers)
- 2 drive-in doors
- 140 auto parking
- 48' x 40' typical bay
- 1,200 amp @ 277/480 volt, 3-phase, 4-wire service

### ADVANTAGES AND AMENITIES

- High image facility
- Prominent front unit / visibility
- DuPage County taxes

**Prologis Essentials: your single-source service for efficient move-in and operations at [prologisessentials.com](https://www.prologisessentials.com)**

[www.prologis.com](https://www.prologis.com)

# 88,098 SF

Industrial Space For Lease



## Prologis Bloomingdale

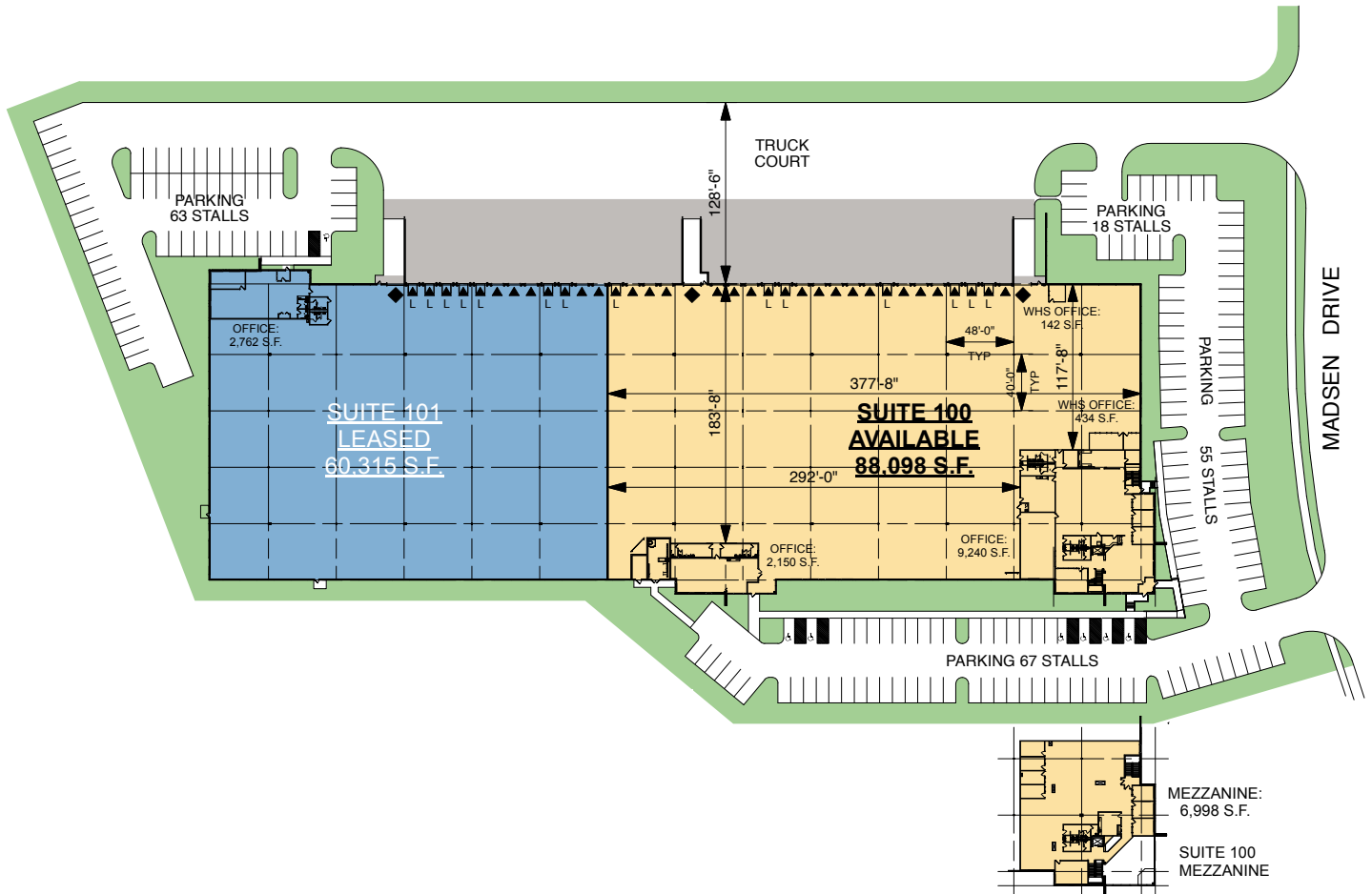

**Cushman & Wakefield**  
Britt Casey  
britt.casey@cushwake.com  
ph +1 847 518 3280  
cell +1 847 456 7545  
9500 W Bryn Mawr  
Suite 600  
Rosemont, IL 60018 USA

**Cushman & Wakefield**  
Al Caruana  
al.caruana@cushwake.com  
ph +1 847 720 1326  
cell +1 847 456 8417  
9500 W Bryn Mawr  
Suite 600  
Rosemont, IL 60018 USA

**Cushman & Wakefield**  
Jeffrey Matella  
jeff.matella@cushwake.com  
ph +1 847 720 1349  
cell +1 847 997 2878  
9500 W Bryn Mawr  
Suite 600  
Rosemont, IL 60018 USA

**Prologis**  
Matthew Mannina  
mmannina@prologis.com  
ph +1 847 292 3939  
cell +1 847 791 3827  
6250 N River Road  
Suite 1100  
Rosemont, IL 60018 USA

**Prologis Essentials: your single-source service for efficient move-in and operations at [prologisessentials.com](http://prologisessentials.com)**

No warranty or representation, expressed or implied, is made as to the accuracy of the information contained herein, and same is submitted subject to error and omissions.