

Raleigh Crossings

5641 Raleigh Street, Orlando, FL 32811



EQUITY
INVESTMENT
SERVICES

PROPERTY SUMMARY



PROPERTY HIGHLIGHTS

- Join Fatburger, Smoothie King, and Foxtail Coffee
- 35 Parking Spots
- 1,500 - 3,300 SF Available
- Delivery June 1, 2025
- Access from both Raleigh Street and S Kirkman
- Located in the Heart of Metrowest
- Situated at the Signalized Corner of Kirkman Road & Raleigh Street
- Direct Frontage and Visibility on Raleigh Street
- 114,700+ combined cars per day on S Kirkman, Raleigh St, and at the intersection

OFFERING SUMMARY

Lease Rate:	Negotiable
Available SF:	3,100 SF
Lot Size:	1.1 Acres
Building Size:	8,000 SF

DEMOGRAPHICS

	1 MILE	3 MILES	5 MILES
Total Households	5,928	43,445	96,770
Total Population	16,776	119,646	273,700
Average HH Income	\$43,224	\$50,990	\$54,939

Nick Barbato

954.579.2672

nbarbato@eisre.com

Eric Portnoy

954.242.2010

eportnoy@eisre.com



7575 Dr. Phillips Blvd, Ste 390

Orlando, FL 32819

www.eisre.com

Raleigh Crossings

5641 Raleigh Street, Orlando, FL 32811

SITE PLAN



EQUITY
INVESTMENT
SERVICES

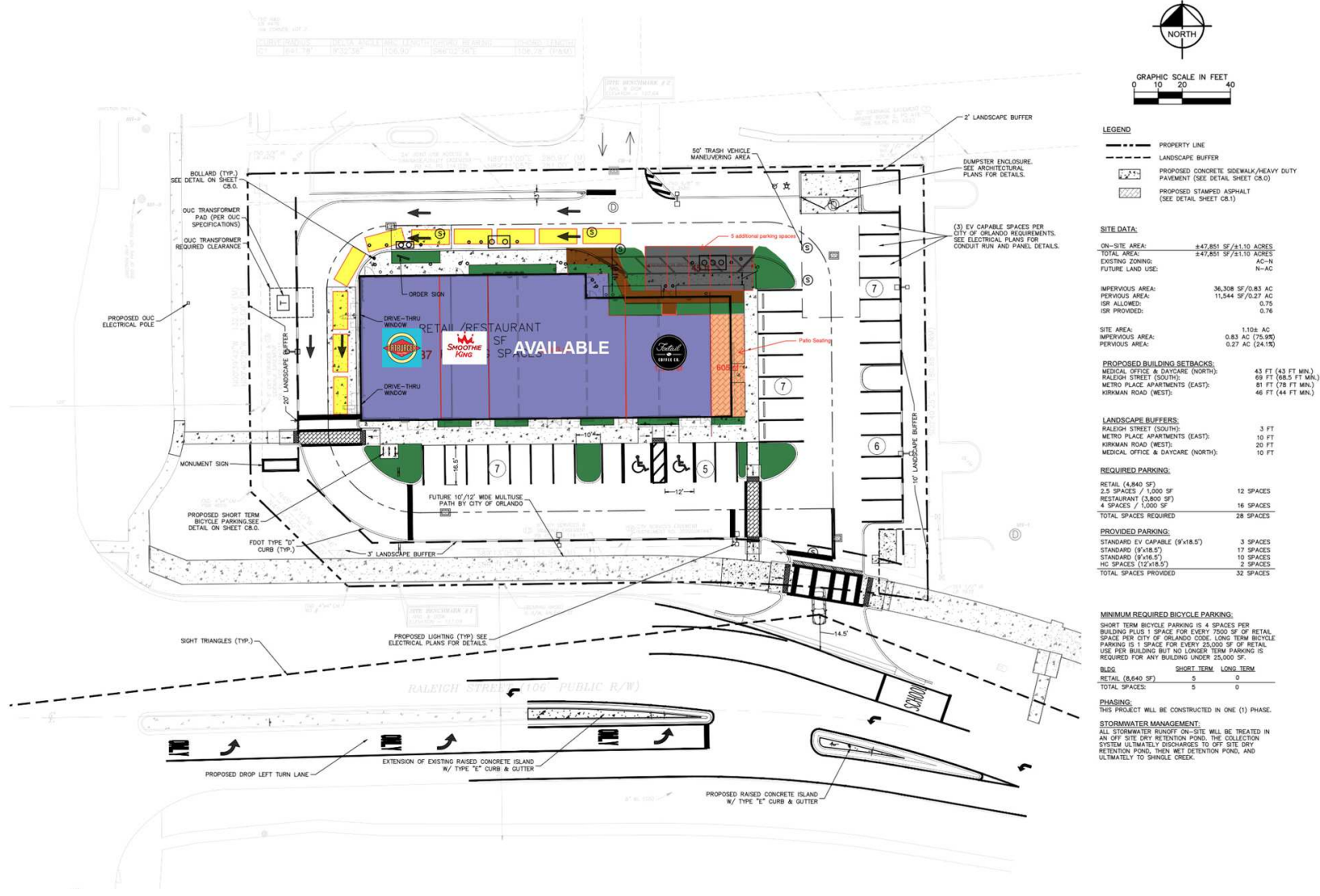

Nick Barbato
954.579.2672
nbarbato@eisre.com

Eric Portnoy
954.242.2010
eportnoy@eisre.com



7575 Dr. Phillips Blvd, Ste 390
Orlando, FL 32819
www.eisre.com

Raleigh Crossings

5641 Raleigh Street, Orlando, FL 32811



EQUITY
INVESTMENT
SERVICES

RETAILER MAP



Nick Barbato

954.579.2672

nbarbato@eisre.com

Eric Portnoy

954.242.2010

eportnoy@eisre.com



7575 Dr. Phillips Blvd, Ste 390

Orlando, FL 32819

www.eisre.com

Raleigh Crossings

5641 Raleigh Street, Orlando, FL 32811



SIGNAGE

SIGNAGE



EQUITY
INVESTMENT
SERVICES

DEMOGRAPHICS MAP & REPORT



POPULATION	1 MILE	3 MILES	5 MILES
Total Population	16,776	119,646	273,700
Average age	28.0	30.5	32.0
Average age (Male)	26.6	29.2	30.8
Average age (Female)	29.4	31.7	33.3
HOUSEHOLDS & INCOME	1 MILE	3 MILES	5 MILES
Total households	5,928	43,445	96,770
# of persons per HH	2.8	2.8	2.8
Average HH income	\$43,224	\$50,990	\$54,939
Average house value	\$151,615	\$231,387	\$263,204

Nick Barbato

954.579.2672

nbarbato@eisre.com

Eric Portnoy

954.242.2010

eportnoy@eisre.com



7575 Dr. Phillips Blvd, Ste 390

Orlando, FL 32819

www.eisre.com