





-  Lab 1 - 2,762 sf
2 Offices
-  Lab 2 - 1,520 sf
1 Office
-  Lab 3 - 1,330 sf
1 Office
-  Lab 4 - 1,629 sf
1 Office
-  Lab 5 - 2,999 sf
2 Offices
-  Common Area

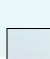

Ready-to-Go Wet Lab & Office Space from 1,330 - 10,240 sf

SGDP BUILDING 9 | 15800-15810 GAITHER DRIVE | GAITHERSBURG, MD

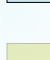
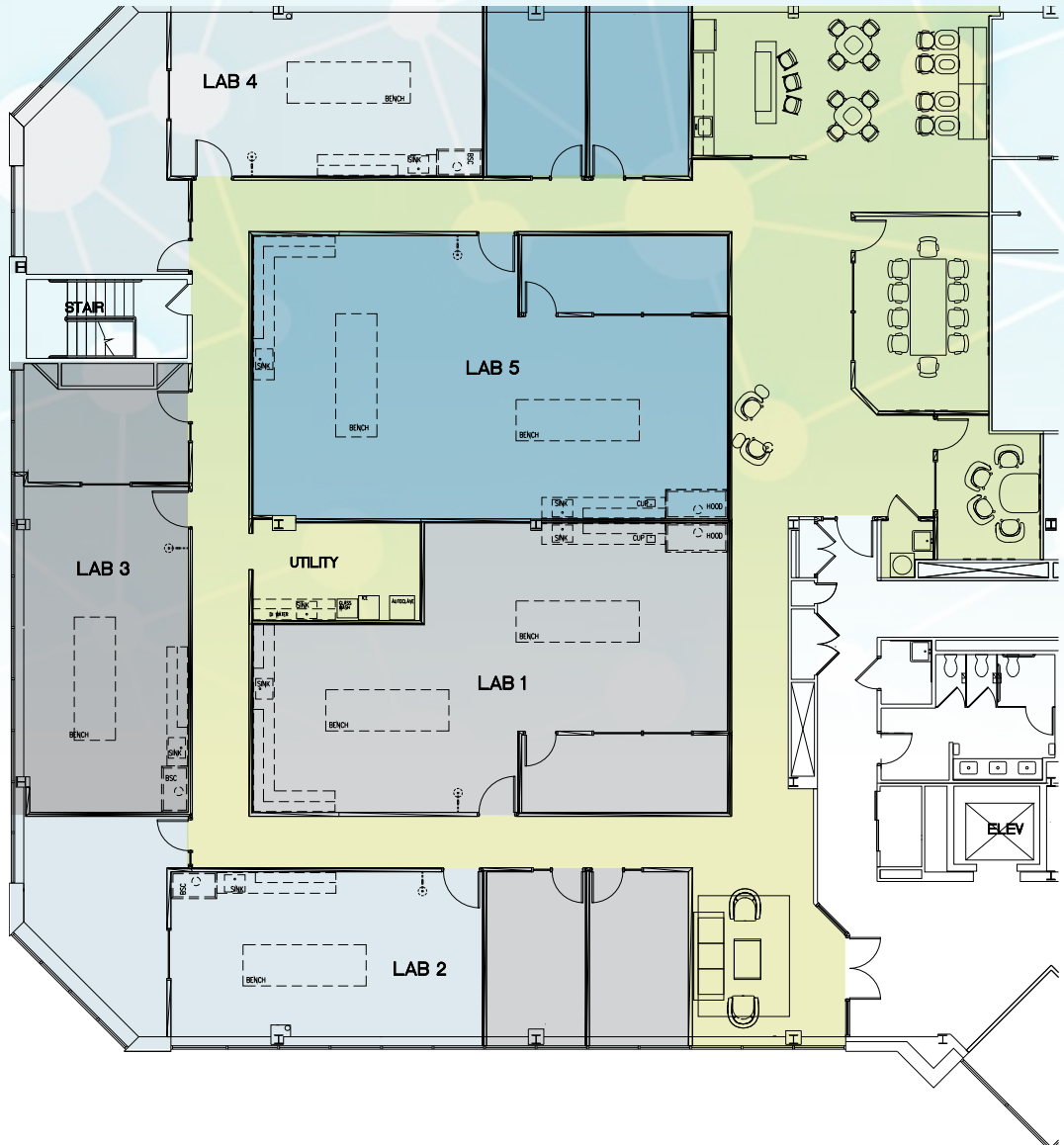
- Five separately demised BSL2 laboratories with adjacent private offices and/or co-working space
- Laboratories equipped with sink, casework, Chemical Fume Hood or Bio Safety Cabinet, and Generator backed up electric outlets
- Labs include area for additional equipment needed including incubator stacks and refrigerators/freezers
- Shared Laboratory spaces equipped with point of use DI Water system, Ice Maker, Glassware washer and Autoclave
- Shared Conference, cafe/lounge area, and Huddle areas
- Free WiFi and high-speed Internet Connections
- Flexible Terms