

Copyright (c) 2020 Pixel Design Collaborative
All reports, plans, specifications, computer files, field data, notes and other documents and instruments prepared by Pixel Design Collaborative shall retain all common law, statutory and other reserved rights, including copyright thereto.
This drawing may not be reproduced in whole or in part without written permission of Pixel Design Collaborative. It is to be returned upon request. Scales as noted are valid on the original drawings.

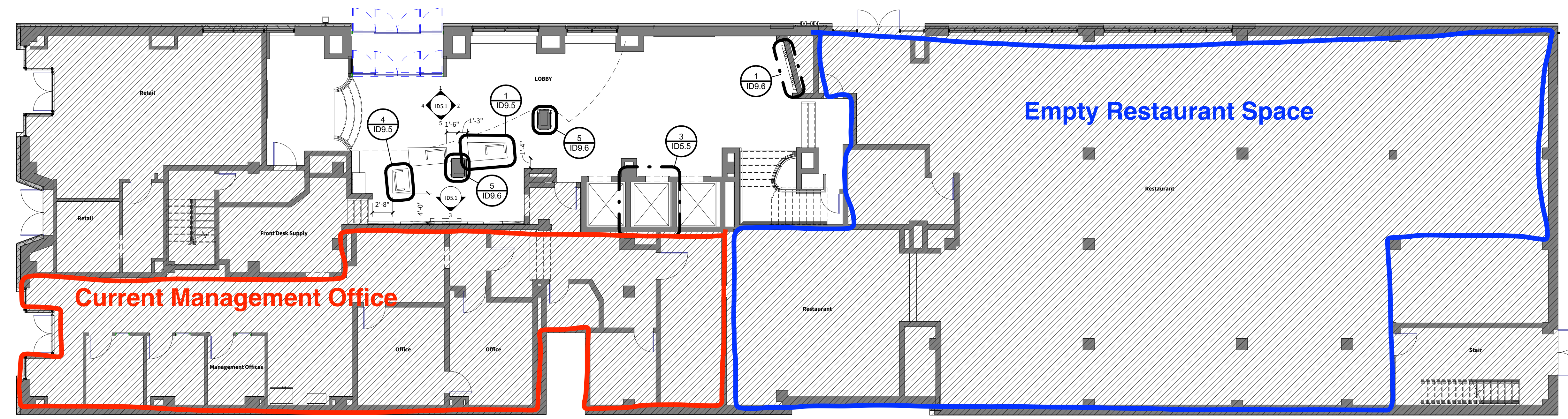

1 Reference Plan Level 1
1/8" = 1'-0"

Holiday Inn Express
100% Construction Documents
111 Cone Street NW
Atlanta, GA 30303

ISSUE
04.15.20 50% CD
06.09.20 100% CD

SHEET TITLE
**Reference Plan
Level 1**

SHEET NO.
2001
ID1.1

Released For Construction

7/6/2020 12:21:12 PM

REFERENCE PLAN LEGEND	REFERENCE PLAN GENERAL NOTES
<p>ELEVATION # SHEET #</p> <p>View Name 1/8" = 1'-0"</p> <p>AREA OUT OF SCOPE</p> <p>REFER TO ENLARGED GUESTROOM PLANS FOR THESE AREAS</p> <p>FLOOR POWER/ DATA OUTLET</p> <p>FLOOR QUADRAPLEX OUTLET</p> <p>KEY NOTE</p> <p>KEY NOTE LEGEND: K01 - GUESTROOM NOTE P01 - PUBLIC SPACE NOTE</p>	<ol style="list-style-type: none"> REFER TO ID0.0 FOR GENERAL NOTES AND SYMBOLS REFER TO ARCHITECTURAL DRAWINGS FOR PARTITION TYPES AND DIMENSIONED PARTITION PLANS REFER TO ARCHITECTURAL DRAWINGS FOR DOOR SCHEDULE AND ADDITIONAL DOOR INFORMATION REFER TO ELEVATIONS, DETAILS, AND PLANS FOR MILLWORK DIMENSIONS ACCESS PANELS AND ALL MEP DEVICES SHOWN FOR LOCATION ONLY. REFER TO MEP DRAWINGS AND SPECIFICATIONS FOR ALL TECHNICAL INFORMATION, SPECIFICATIONS, OVERALL SIZE, AND CODE REQUIREMENTS. REFER TO ELEVATIONS FOR LOCATIONS OF WALL-MOUNTED MEP DEVICES. PROVIDE POWER OUTLETS FOR APPLIANCES (OUTLETS NOT SHOWN ON PLAN). CONFIRM REQUIREMENTS WITH APPLIANCE CUTSHEETS. REFER TO ELEVATIONS. REFER TO GUESTROOM PLANS ON ID7.0 SERIES FOR GUESTROOM KEY REFERENCES. ARCHITECT TO CONFIRM ALL ADA REQUIREMENTS PRIOR TO CONSTRUCTION.