

# FOR LEASE | PRIME RETAIL SPACE

611 Main Street | South Portland, ME



## 1,500-3,344± SF PRIME RETAIL SPACE

- Building signage and ample on-site parking
- Walkable residential neighborhood directly behind and surrounding. Close to new South Portland school campus and Scarborough businesses
- Space delivered in vanilla-shell finish
- Venting for kitchen hood and grease trap available

**LEASE RATE: \$19.00/SF NNN**



**BRANDON MITCHELL**

207.358.7057 D

207.415.7982 C

brandon@malonecb.com

**MALONE COMMERCIAL BROKERS**

5 Moulton Street • Suite 3

Portland, ME 04101

207.772.2422 • malonecb.com

# PROPERTY SUMMARY

611 Main Street | South Portland, ME



**OWNER:** South Portland Housing Development Corporation

**DEED:** Book 36879, Page 188

**ASSESSOR:** Map 53, Block E, Lot 302

**LOT SIZE:** 1.81± AC

**BUILDING SIZE:** 46,542± SF

**SPACE SIZE:** 1,500-3,344± SF

**STORIES:** Four (4)

**YEAR BUILT:** 2020

**CONSTRUCTION:** Wood frame

**SIDING:** Metal, aluminum storefront

**HVAC:** Natural gas; Central A/C

**INTERNET:** Fiber optic

**UTILITIES:** Municipal water & sewer

**SPRINKLER:** Wet

**SIGNAGE:** On building

**PARKING:** 27± on-site spaces

**ROAD FRONTAGE:** 200' on Main Street  
327' on Thirlmere Avenue  
460' on Aspen Avenue

**ZONING:** DZ

## AREA BUSINESSES

Town & Country FCU, Embers Stoves, Hour Glass Company, Waterman's Service Center, Merry Manor Hotel, Coppersmith Tavern, Deb's Sandwich Shop, Veranda Thai, among others



# PLANS

611 Main Street | South Portland, ME



## SITE PLAN



## FLOOR PLAN

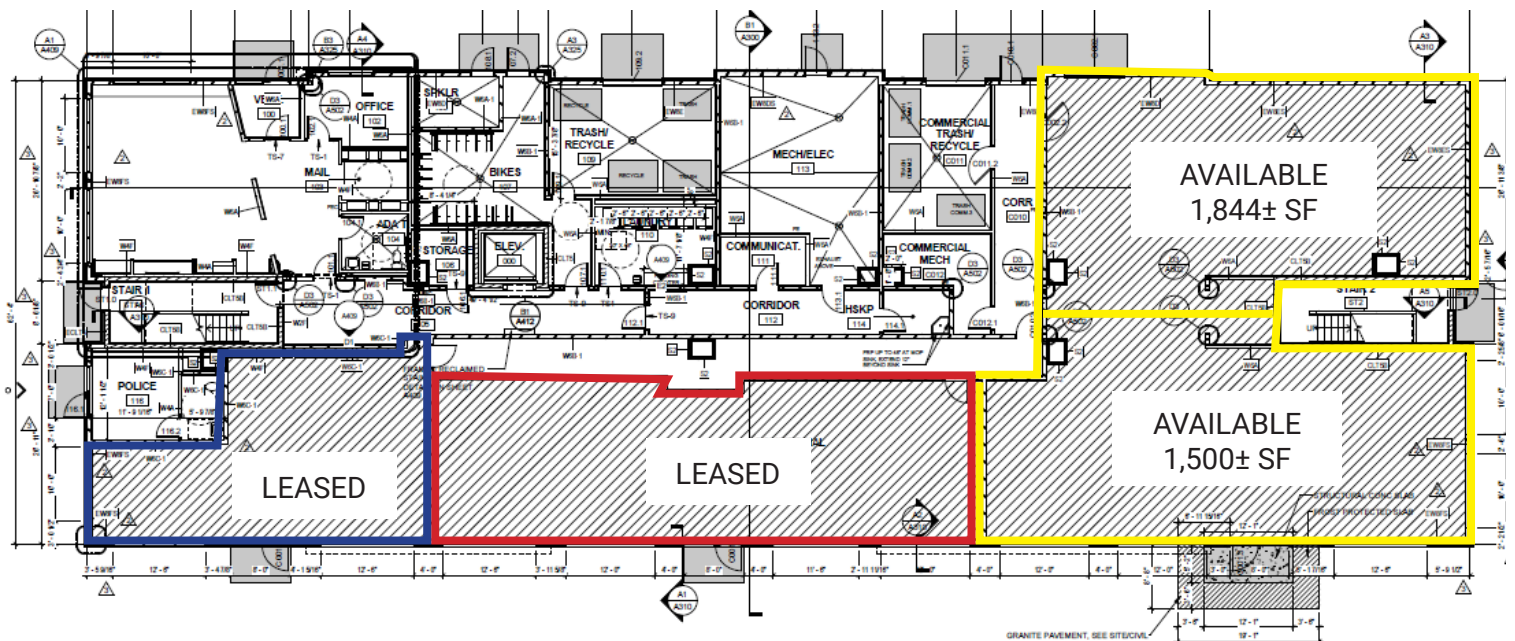

# FOR LEASE | PRIME RETAIL SPACE

611 Main Street | South Portland, ME



Data SIO, NOAA, U.S. Navy, NGA, GEBCO

This document has been prepared by Malone Commercial Brokers for advertising and general information only. Malone Commercial Brokers makes no guarantees, representations or warranties of any kind, expressed or implied, regarding, but not limited to, warranties of content, accuracy, and reliability. Any interested party should undertake their own inquiries as to the accuracy of the information. Malone Commercial Brokers excludes unequivocally all informed or implied terms, conditions and warranties arising out of this document and excludes all liability for loss and damages there from. All data is subject to change of price, error, omissions, other conditions or withdrawal without notice. Malone Commercial Brokers is acting as the Seller's/Lessor's agent in the marketing of this property.



**BRANDON MITCHELL**

207.358.7057 D

207.415.7982 C

[brandon@malonecb.com](mailto:brandon@malonecb.com)

**MALONE COMMERCIAL BROKERS**

5 Moulton Street • Suite 3

Portland, ME 04101

207.772.2422 • [malonecb.com](http://malonecb.com)