

NEWMARK

AVAILABLE FOR LEASE

145 MARCUS BOULEVARD, HAUPPAUGE

NEW TO MARKET



BUILDING SIZE:

20,600 SF

AVAILABLE SPACE:

1st Floor: 5,967 RSF

1st Floor: 4,529 RSF

LOT SIZE:

2.50 Acres

RENTAL RATE:

\$19.75 PSF + Utilities & Cleaning

POSSESSION:

May 1, 2025

PROPERTY OVERVIEW:

- Signage
- Excellent Parking / Fenced Yard
- Located close to the Long Island Expressway, Northern State Parkway, the Sagtikos Parkway & Veterans Memorial Highway
- Minutes from Suffolk County Government & Court Complex
- 100 Surface Parking Spaces

FOR MORE INFORMATION, PLEASE CONTACT EXCLUSIVE BROKER:

Dan Marcus

Director

t 631-673-0821

dan.marcus@nmrk.com

Brian Lee

Principal / Executive Managing Director

t 631-673-0888

brian.lee@nmrk.com

nmrk.com

290 Broadhollow Road, Suite 103E, Melville, NY 11747



All information contained in this publication is derived from sources that are deemed to be reliable. However, Newmark has not verified any such information, and the same constitutes the statements and representations only of the source thereof, and not of Newmark. Any recipient of this publication should independently verify such information and all other information that may be material to any decision that recipient may make in response to this publication, and should consult with professionals of the recipient's choice with regard to all aspects of that decision, including its legal, financial, and tax aspects and implications. Any recipient of this publication may not, without the prior written approval of Newmark, distribute, disseminate, publish, transmit, copy, broadcast, upload, download, or in any other way reproduce this publication or any of the information it contains. This document is intended for informational purposes only and none of the content is intended to advise or otherwise recommend a specific strategy. It is not to be relied upon in any way to predict market movement, investment in securities, transactions, investment strategies or any other matter.

©2020 Newmark. All Rights Reserved.

NEWMARK

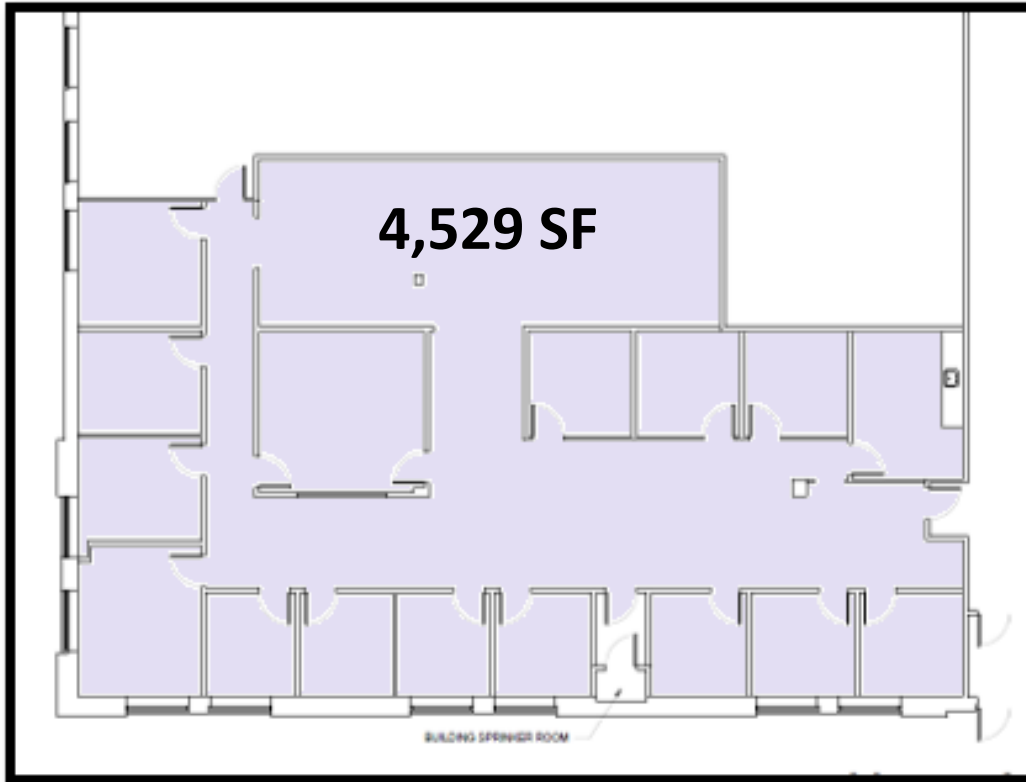

NEWMARK

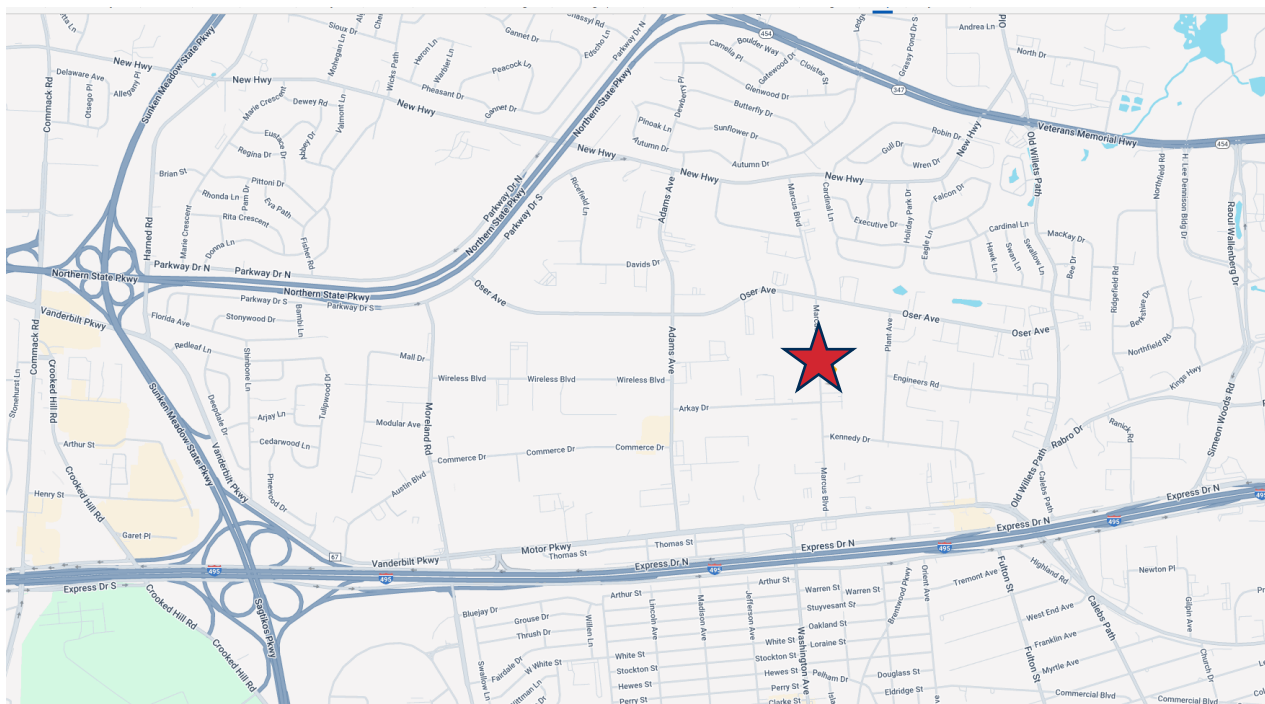

FOR MORE INFORMATION, PLEASE CONTACT EXCLUSIVE BROKER:

Dan Marcus

Director

t 631-673-0821

dan.marcus@nmrk.com

Brian Lee

Principal / Executive Managing Director

t 631-673-0888

brian.lee@nmrk.com

nmrk.com

290 Broadhollow Road, Suite 103E, Melville, NY 11747



All information contained in this publication is derived from sources that are deemed to be reliable. However, Newmark has not verified any such information, and the same constitutes the statements and representations only of the source thereof, and not of Newmark. Any recipient of this publication should independently verify such information and all other information that may be material to any decision that recipient may make in response to this publication, and should consult with professionals of the recipient's choice with regard to all aspects of that decision, including its legal, financial, and tax aspects and implications. Any recipient of this publication may not, without the prior written approval of Newmark, distribute, disseminate, publish, transmit, copy, broadcast, upload, download, or in any other way reproduce this publication or any of the information it contains. This document is intended for informational purposes only and none of the content is intended to advise or otherwise recommend a specific strategy. It is not to be relied upon in any way to predict market movement, investment in securities, transactions, investment strategies or any other matter.

©2020 Newmark. All Rights Reserved.