

AVAILABLE

NORTHSIDE DRIVE & W. 19TH ST.,
PANAMA CITY, FL

PROPERTY OVERVIEW

- Offering build-to-suit opportunities for up to 20,000 SF of Class A medical space, including surgery center.
- Direct frontage on W. 19th St., approximately 1 mile from the Gulf Coast Hospital.
- In the heart of Panama City's main medical & commercial corridor.



MEDICAL SPACE AVAILABLE PANAMA CITY, FL



OPTIMAL OUTCOMES, LLC
Planning, Design, Development
727.895.8902 | www.optimal-outcomes.com

For More Information:
Anthony Frogameni
c: 407-284-7257
afrogameni@optimal-outcomes.com

SITE PLAN & HIGHLIGHTS

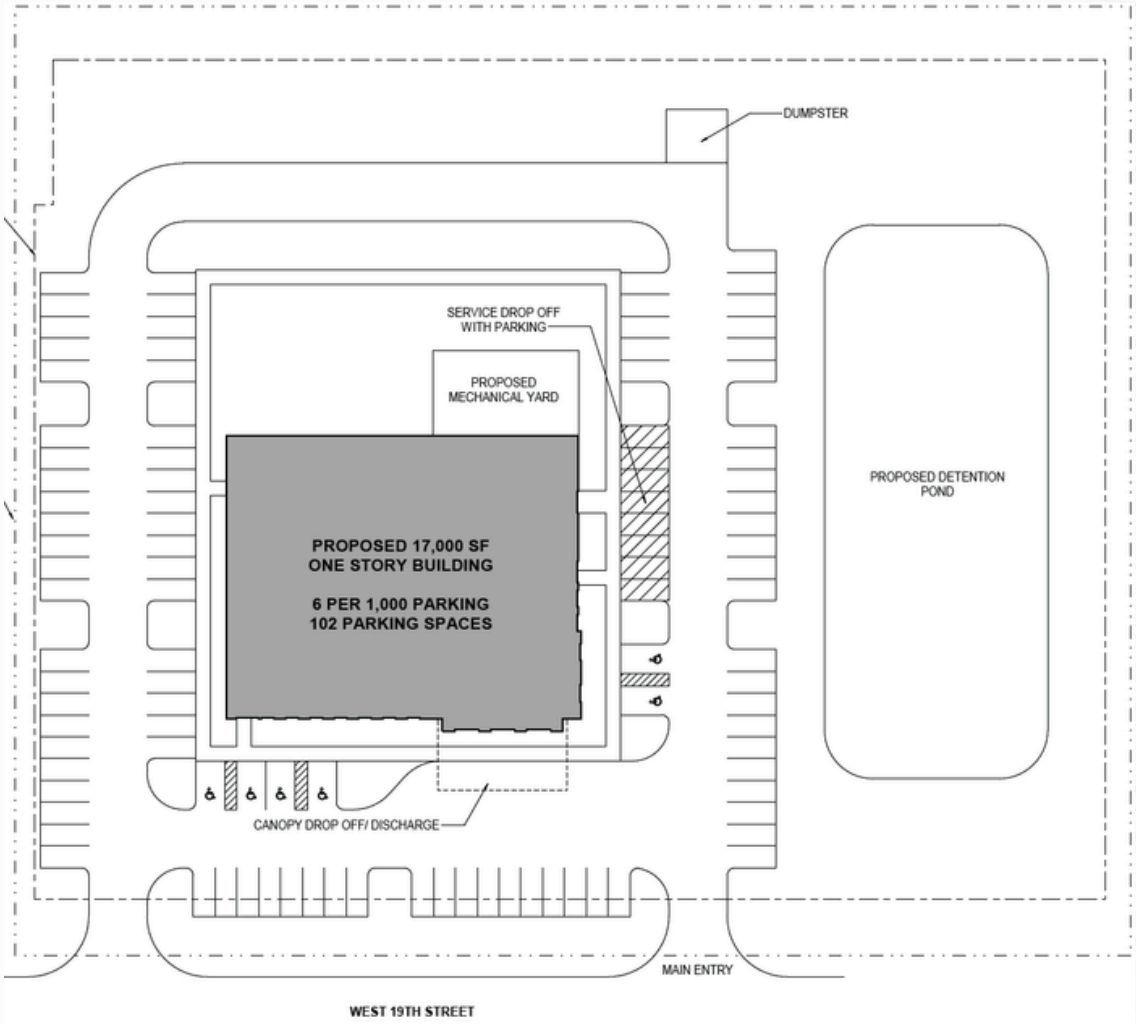

- Up to 20,000 SF of Class A medical space available
- Circular access with 2 points for ingress/egress from W. 19th St.
- Ample surface parking with approximately 6 per thousand parking
- Zoned GC-2
- Rectilinear footprint for design efficiency
- Canopy drop-off and discharge
- Equipment yard contiguous to building



	2024 General Population	2024 Number of Households	2024 Avg. Household Income
1-MILE	5,333	2,166	\$59,274
3-MILE	33,809	13,749	\$69,165
5-MILE	68,373	27,004	\$74,710

OPTIMAL OUTCOMES, LLC
Planning, Design, Development
727.895.8902 | www.optimal-outcomes.com

For More Information:
Anthony Frogameni
c: 407-284-7257
afrogameni@optimal-outcomes.com