

Diamond Gowan Industrial

3513 - 3591 JOHN PETER LEE AVENUE

NORTH LAS VEGAS, NV 89032

BLDG. 3513
±14,758 SF

BLDG. 3559
±14,758 SF

BLDG. 3563
±12,757 SF

BLDG. 3591
±13,097 SF

FOR LEASE

±55,370 SF CLASS A INDUSTRIAL PROJECT

DIVISIBLE TO ±12,757 SF

MIKE DE LEW, 

(702) 469-6496

MDelew@rcadvs.com

NV-RE License: S.0025952

PAUL HOYT, 

(702) 782-3306

PHoyt@rcadvs.com

NV-RE License: BS.0144760

REALCOMM ADVISORS

770 E. Warm Springs Road

Suite 120

Las Vegas, NV 89119

(702) 515-1010

www.realcommadvisors.com



PROPERTY DETAILS

- ±55,370 SF Total - Class "A" Industrial Project
- Available From ±12,757 SF up to ±29,516 SF
Four (4) Buildings - CAN BE COMBINED
- Three (3) - 9' x 10' Dock High Loading Doors (Per Building)
- One (1) - 14' x 16' Grade Level Loading Door (Per Building)
- ESFR Fire Sprinklers
- 600 Amps, 277480 Volt, 3-Phase Power (Per Building)
- High-Bay LED Warehouse Lighting
- Warehouse Skylights (4' x 8')
- Zoned M-2 (General Industrial)

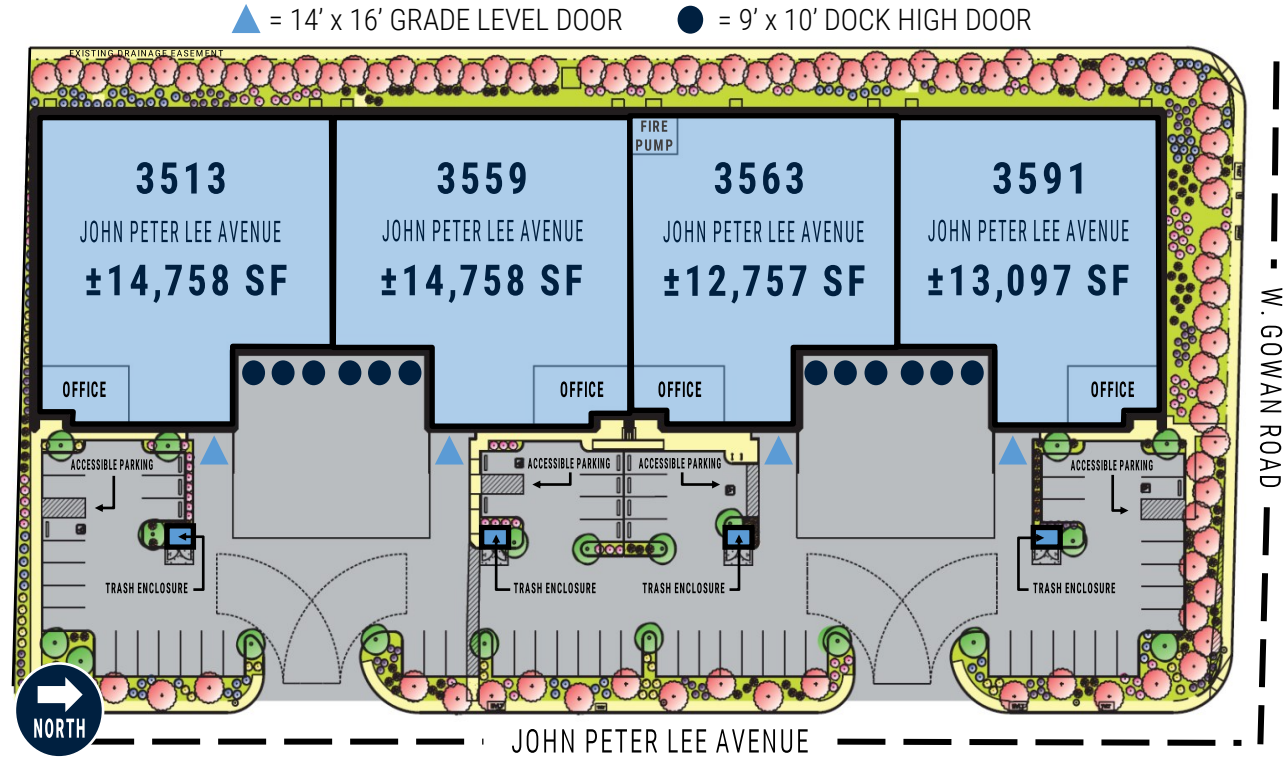

BUILDING(S)	TOTAL SF	OFFICE SF	CLEAR HEIGHT	DOCK	GRADE	PARKING SPACES	MONTHLY (\$) BASE RENT (NNN)	MONTHLY (\$) NNN	TOTAL (\$) MONTHLY
3513	±14,758 SF	±1,000 SF	±28'	3	1	17	\$1.25/SF	\$0.23/SF	\$21,842
3559	±14,758 SF	±1,000 SF	±28'	3	1	16	\$1.25/SF	\$0.23/SF	\$21,842
3563	±12,757 SF	±1,000 SF	±24'	3	1	15	\$1.25/SF	\$0.23/SF	\$18,880
3591	±13,097 SF	±1,000 SF	±24'	3	1	15	\$1.25/SF	\$0.23/SF	\$19,384
3513 & 3559	±29,516 SF	±2,000 SF	±28'	6	2	33	\$1.20/SF	\$0.23/SF	\$42,208
3563 & 3591	±25,854 SF	±2,000 SF	±24'	6	2	30	\$1.20/SF	\$0.23/SF	\$36,971

MIKE DE LEW, 
 (702) 469-6496
 MDelew@rcadvs.com
 NV-RE License: S.0025952

PAUL HOYT, 
 (702) 782-3306
 PHoyt@rcadvs.com
 NV-RE License: BS.0144760

REALCOMM ADVISORS
 770 E. Warm Springs Road
 Suite 120
 Las Vegas, NV 89119
 (702) 515-1010
 www.realcommadvisors.com



3513 - 3591 JOHN PETER LEE AVENUE | NORTH LAS VEGAS, NV 89032

Diamond Gowan Industrial

FOR LEASE

3513 JOHN PETER LEE AVENUE

±14,758 TOTAL SF*

*AN ADDITIONAL ±14,758 SF CAN BE COMBINED = ±29,516 SF TOTAL
(3559 JOHN PETER LEE AVENUE)

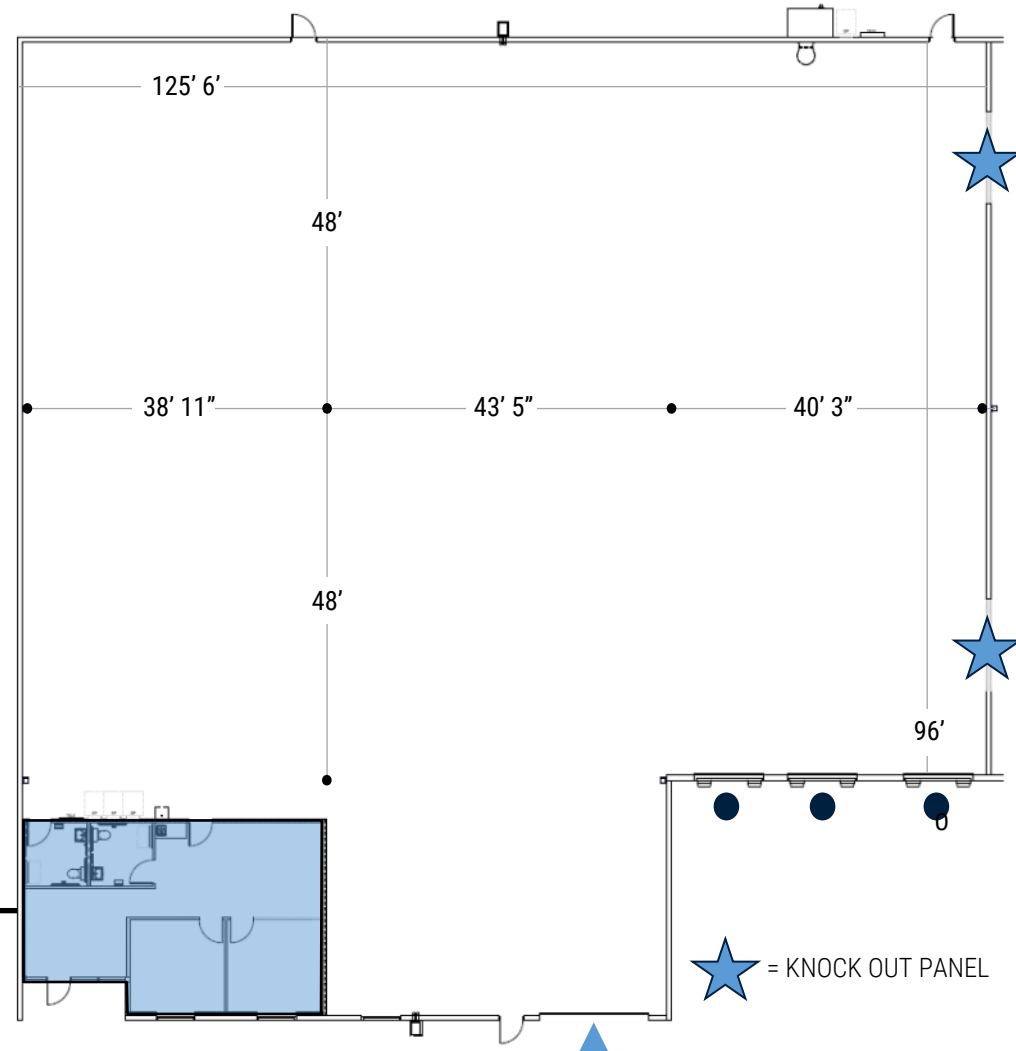
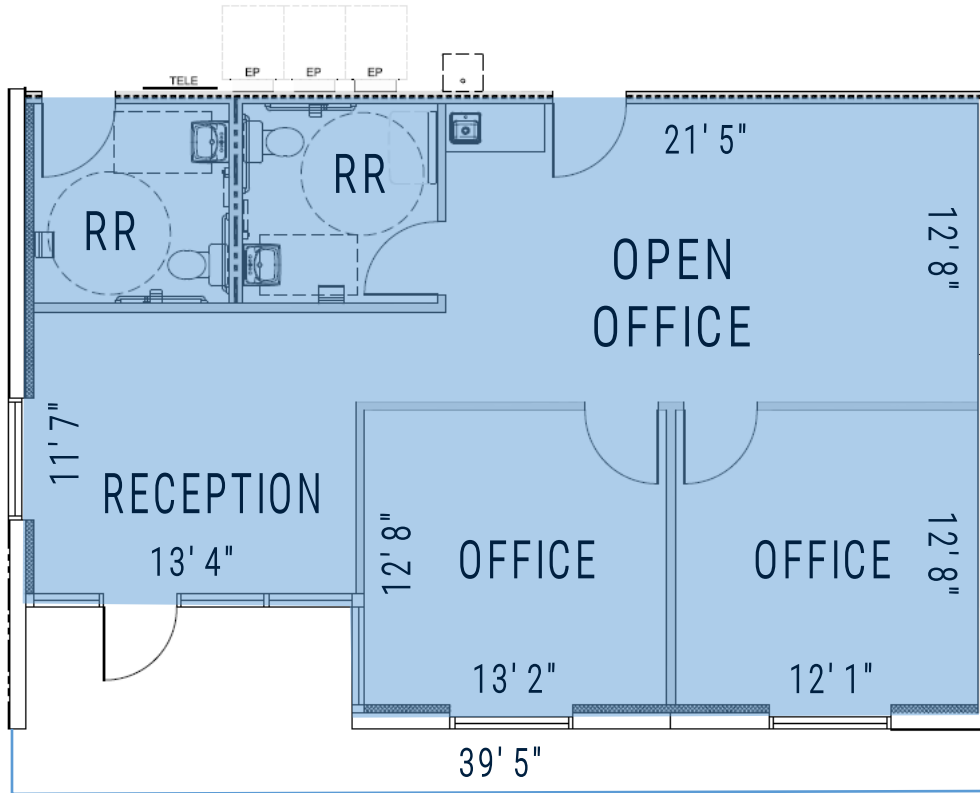

▲ = 14' x 16' GRADE DOOR

● = 9' x 10' DOCK DOOR

★ = KNOCK OUT PANEL

MIKE DE LEW, SIOR®

(702) 469-6496

MDelew@rcadvs.com

NV-RE License: S.0025952

PAUL HOYT, SIOR®

(702) 782-3306

PHoyt@rcadvs.com

NV-RE License: BS.0144760

REALCOMM ADVISORS

770 E. Warm Springs Road

Suite 120

Las Vegas, NV 89119

(702) 515-1010

www.realcommadvisors.com



3513 - 3591 JOHN PETER LEE AVENUE | NORTH LAS VEGAS, NV 89032

Diamond Gowan Industrial

FOR LEASE

3559 JOHN PETER LEE AVENUE

±14,758 TOTAL SF*

*AN ADDITIONAL ±14,758 SF CAN BE COMBINED = ±29,516 SF TOTAL
(3513 JOHN PETER LEE AVENUE)

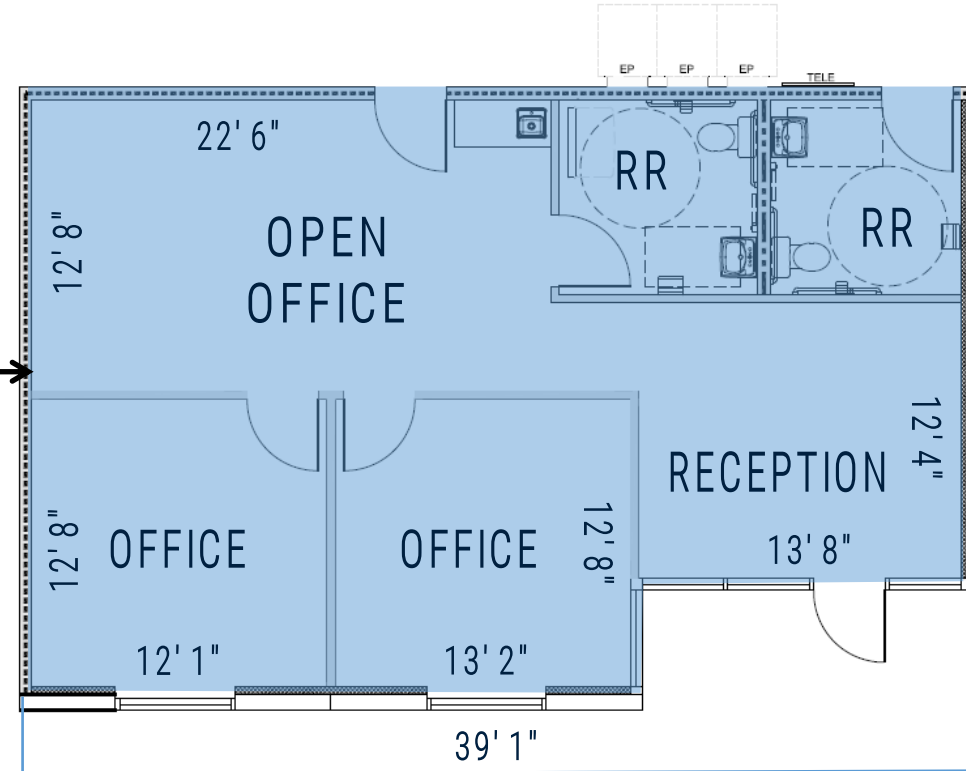
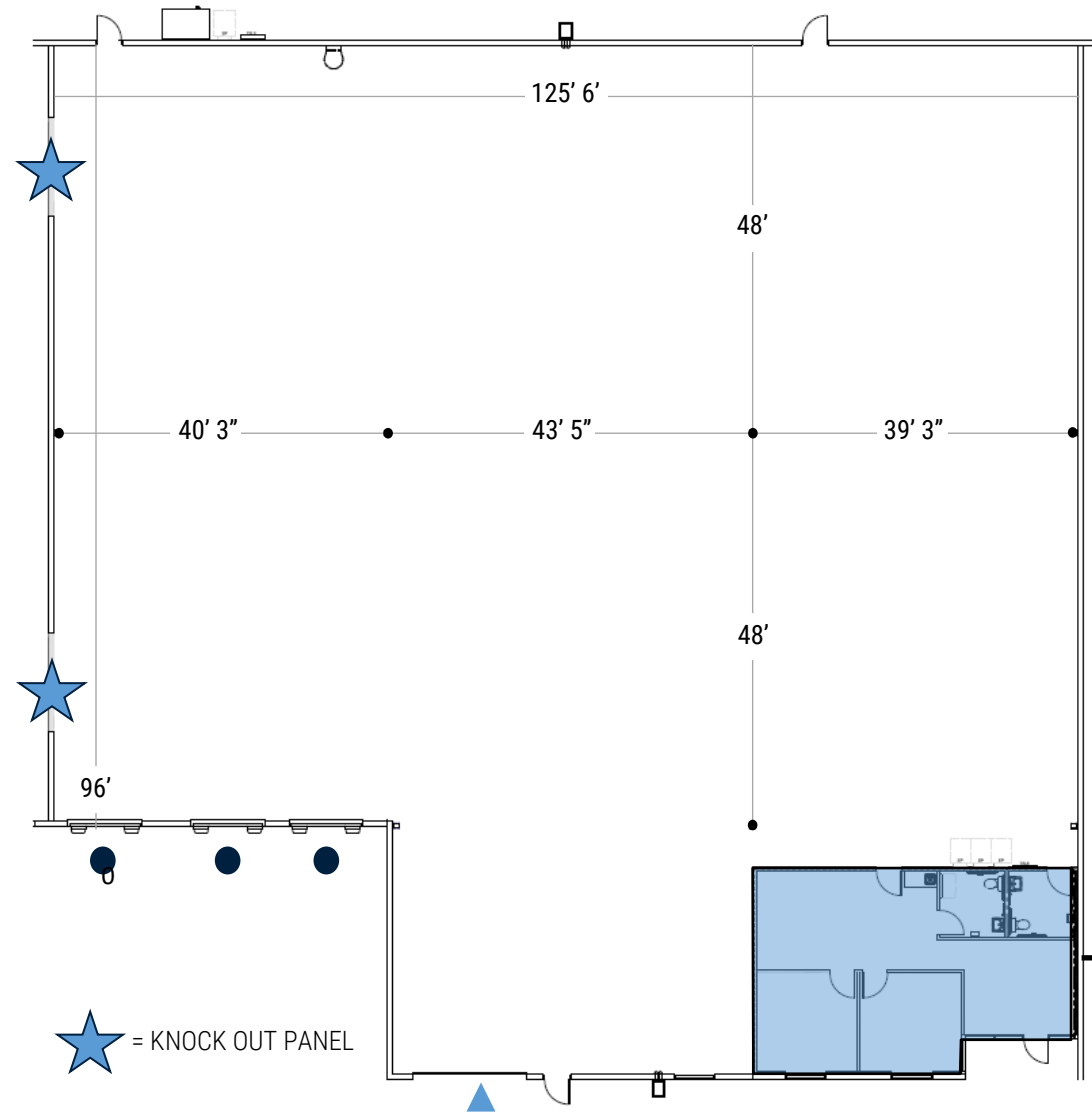

▲ = 14' x 16' GRADE DOOR ● = 9' x 10' DOCK DOOR

MIKE DE LEW, SIOR®
(702) 469-6496
MDelew@rcadvs.com
NV-RE License: S.0025952

PAUL HOYT, SIOR®
(702) 782-3306
PHoyt@rcadvs.com
NV-RE License: BS.0144760

REALCOMM ADVISORS
770 E. Warm Springs Road
Suite 120
Las Vegas, NV 89119
(702) 515-1010
www.realcommadvisors.com



3563 JOHN PETER LEE AVENUE

±12,757 TOTAL SF*

*AN ADDITIONAL ±13,097 SF CAN BE COMBINED = ±25,854 SF TOTAL
(3591 JOHN PETER LEE AVENUE)

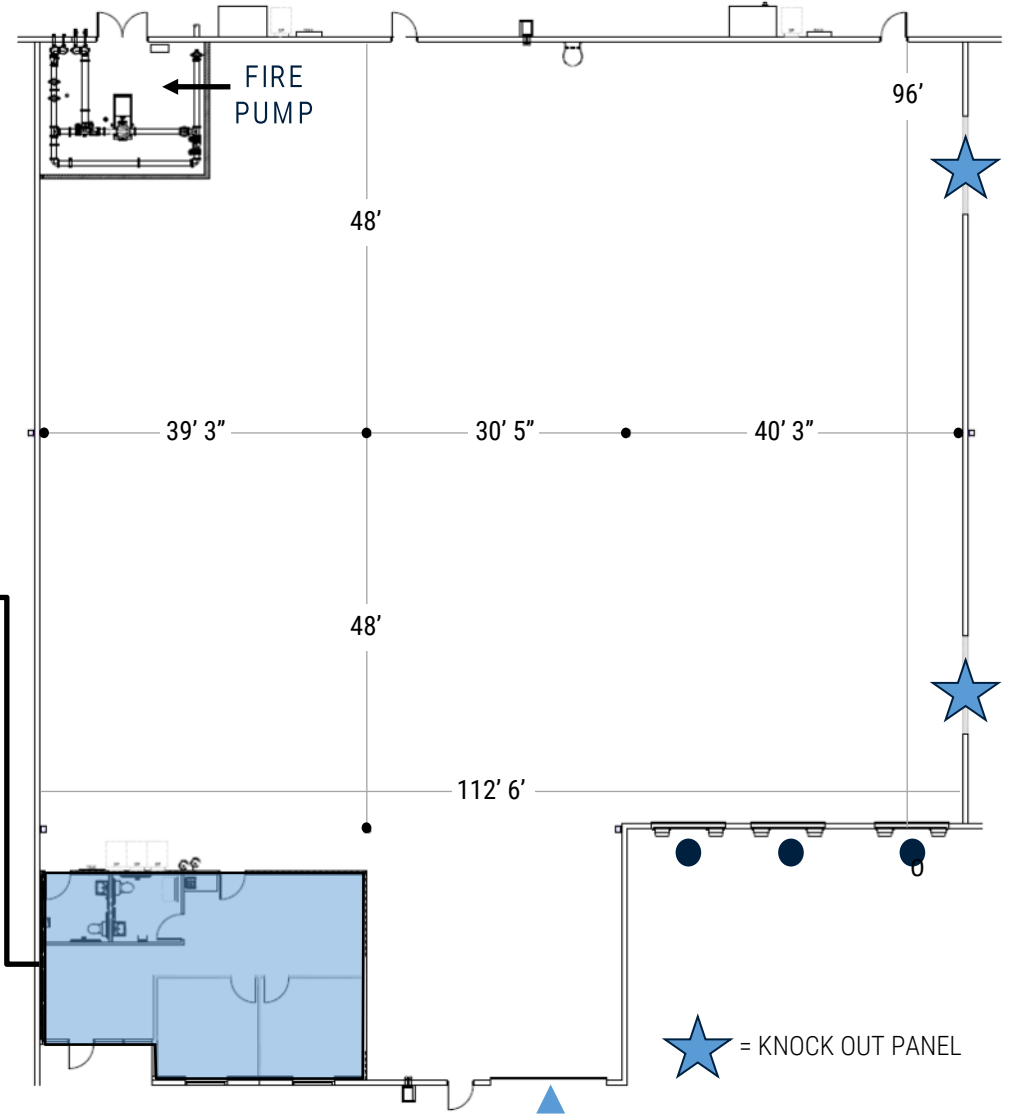
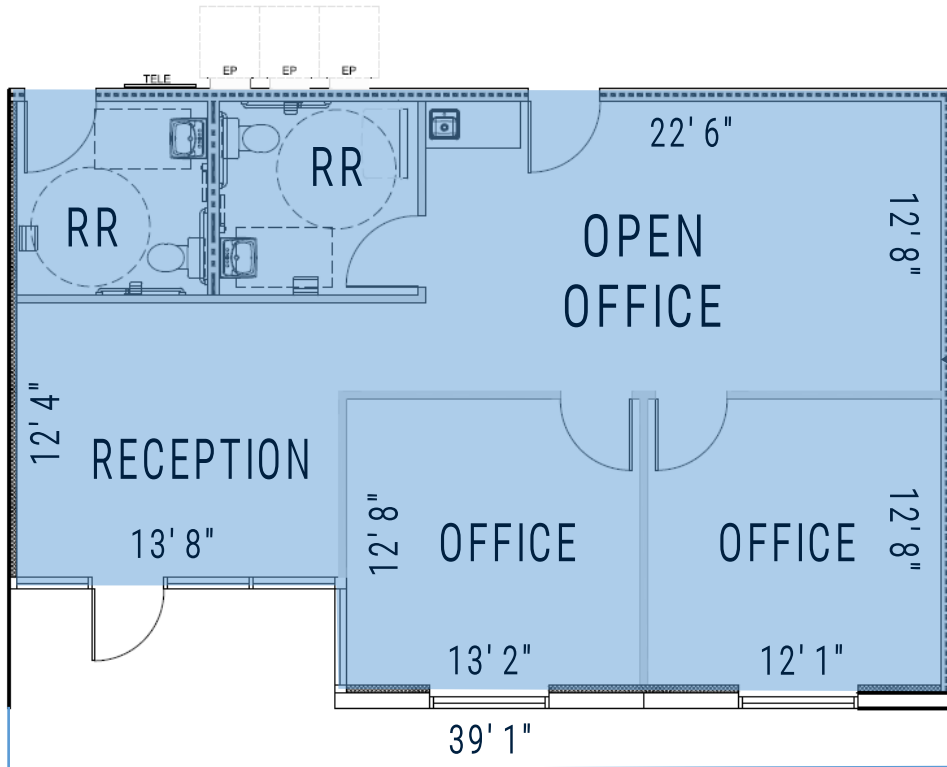

▲ = 14' x 16' GRADE DOOR

● = 9' x 10' DOCK DOOR

★ = KNOCK OUT PANEL

MIKE DE LEW, SIOR®

(702) 469-6496

MDelew@rcadvs.com

NV-RE License: S.0025952

PAUL HOYT, SIOR®

(702) 782-3306

PHoyt@rcadvs.com

NV-RE License: BS.0144760

REALCOMM ADVISORS

770 E. Warm Springs Road

Suite 120

Las Vegas, NV 89119

(702) 515-1010

www.realcommadvisors.com



3513 - 3591 JOHN PETER LEE AVENUE | NORTH LAS VEGAS, NV 89032

Diamond Gowan Industrial

FOR LEASE

3591 JOHN PETER LEE AVENUE

±13,097 TOTAL SF*

***AN ADDITIONAL ±12,757 SF CAN BE COMBINED = ±25,854 SF TOTAL
(3563 JOHN PETER LEE AVENUE)**

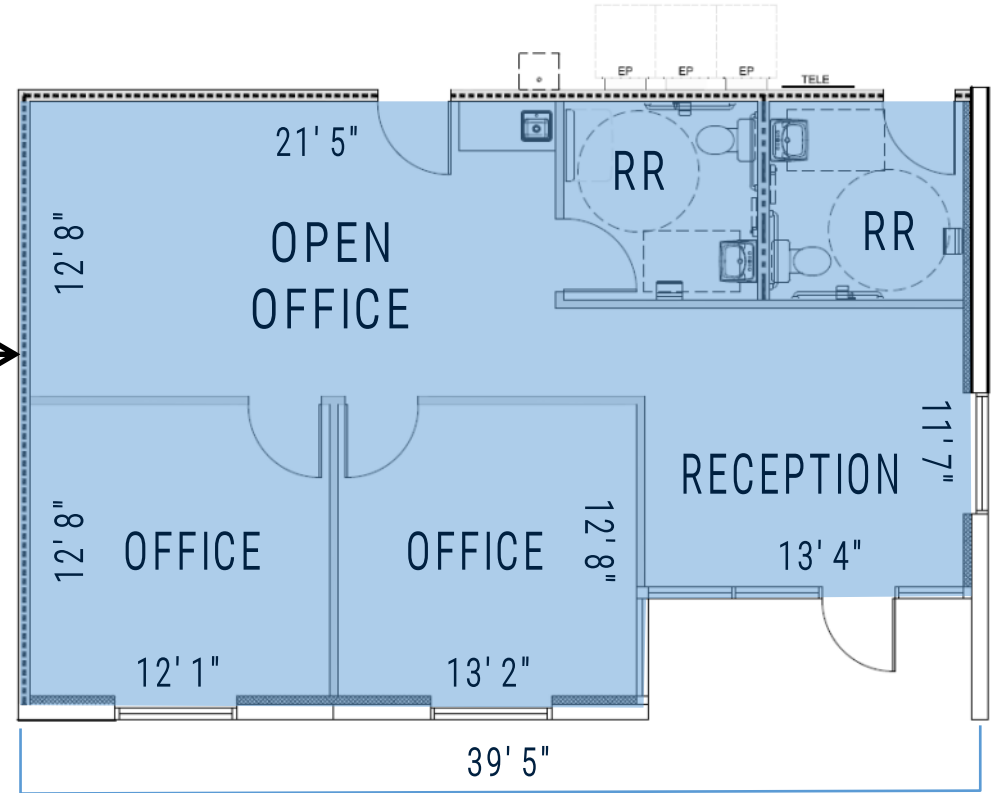
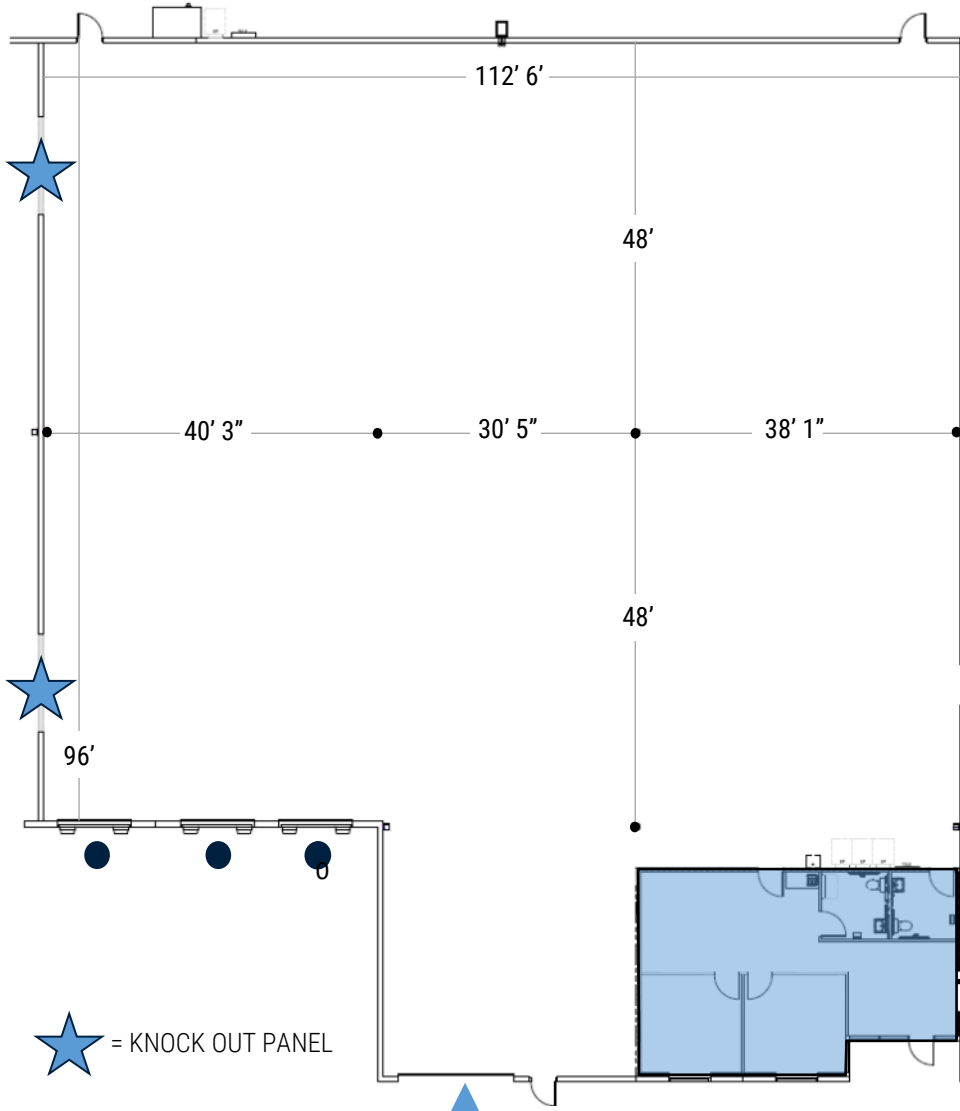

▲ = 14' x 16' GRADE DOOR ● = 9' x 10' DOCK DOOR

MIKE DE LEW, 
 (702) 469-6496
 MDelew@rcadvs.com
 NV-RE License: S.0025952

PAUL HOYT, 
 (702) 782-3306
 PHoyt@rcadvs.com
 NV-RE License: BS.0144760

REALCOMM ADVISORS
 770 E. Warm Springs Road
 Suite 120
 Las Vegas, NV 89119
 (702) 515-1010
 www.realcommadvisors.com



3513 - 3591 JOHN PETER LEE AVENUE | NORTH LAS VEGAS, NV 89032

Diamond Gowan Industrial

FOR LEASE

Diamond Gowan Industrial is a Four (4) Building, Class A Industrial Project totaling ±55,370 square feet with access to the I-15 via Cheyenne Avenue. Situated in the North Las Vegas Submarket, Diamond Gowan Industrial is within close proximity to the North Las Vegas Airport & Nearby Amenities.



MIKE DE LEW, 
(702) 469-6496
MDelew@rcadvs.com
NV-RE License: S.0025952

PAUL HOYT, 
(702) 782-3306
PHoyt@rcadvs.com
NV-RE License: BS.0144760

REALCOMM ADVISORS
770 E. Warm Springs Road
Suite 120
Las Vegas, NV 89119
(702) 515-1010
www.realcommadvisors.com



3513 - 3591 JOHN PETER LEE AVENUE | NORTH LAS VEGAS, NV 89032

Diamond Gowan Industrial

FOR LEASE



Information is subject to change at any time. The information provided has been obtained from sources believed reliable. While we do not doubt its accuracy, we have not verified it and make no guarantee, warranty or representation about it. It is your responsibility to independently confirm its accuracy & completeness. You and your advisors should conduct a careful, independent investigation of the property to determine to your satisfaction the suitability of the property for your needs.

MIKE DE LEW, 
(702) 469-6496
MDelew@rcadvs.com
NV-RE License: S.0025952

PAUL HOYT, 
(702) 782-3306
PHoyt@rcadvs.com
NV-RE License: BS.0144760

REALCOMM ADVISORS
770 E. Warm Springs Road
Suite 120
Las Vegas, NV 89119
(702) 515-1010
www.realcommadvisors.com

