

20403-20405 Seneca Meadows Parkway, Germantown, MD 20876

# 8,580 SF For Sublease

Available Now • Term through 7/31/2027



JLL METRO DC INDUSTRIAL

Dan Coats  
703 891 8410  
dan.coats@jll.com

Sam Haas  
443 878 3499  
sam.haas@jll.com



### Property Highlights

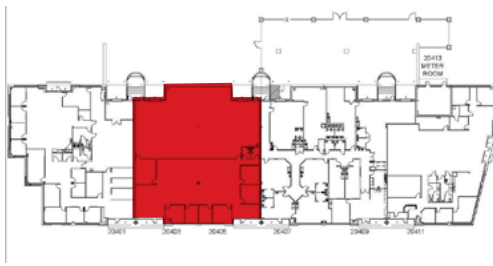
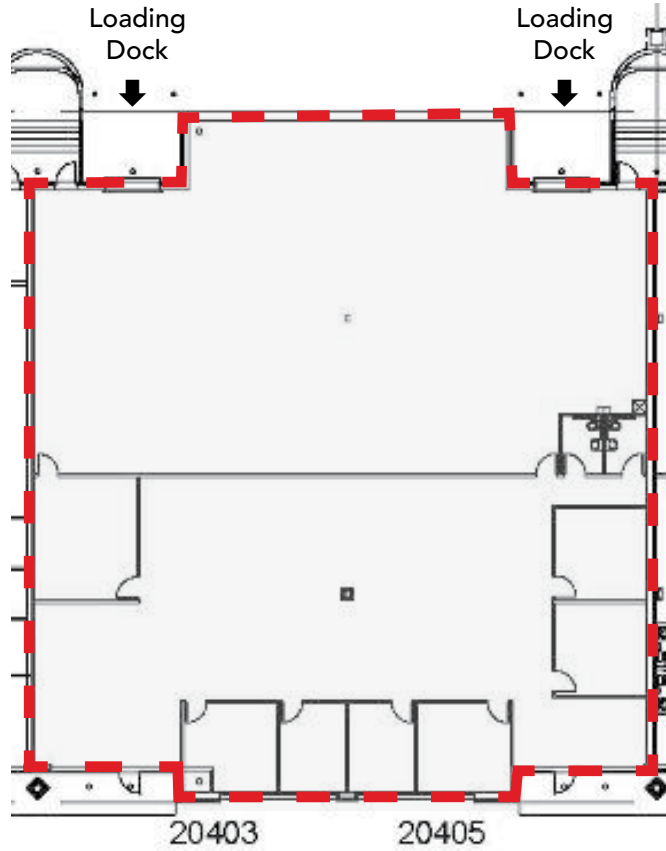

Term through 7/31/2027	8,580 SF total
3,200 SF existing office	18' clear height
Asking Rate - \$16.00 PSF, NNN OPEX - \$5.00 PSF	2 loading docks

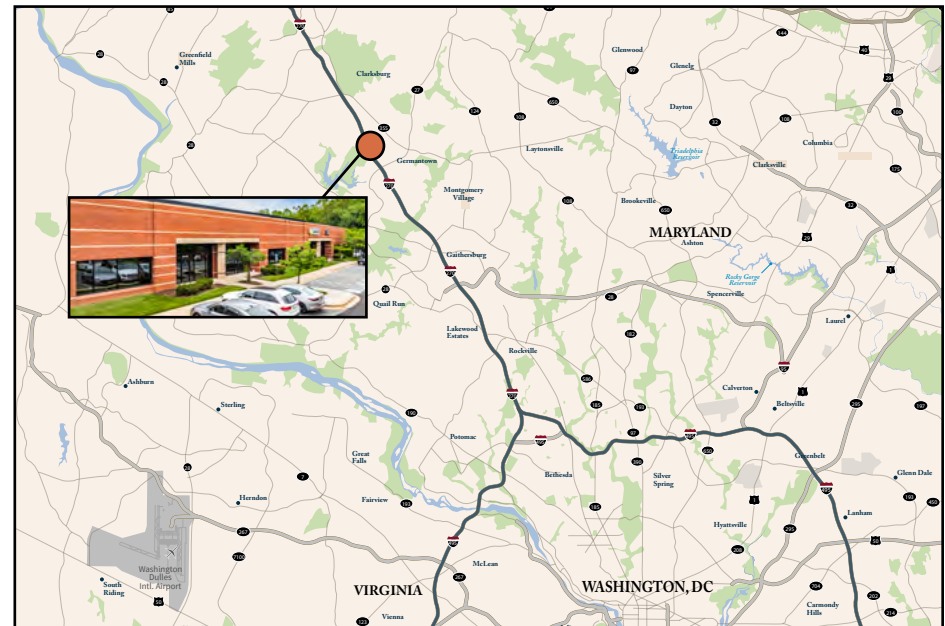



Available Now

20403-20405 Seneca Meadows Parkway, Germantown, MD 20876







For more information, please contact:

Dan Coats  
703 891 8410  
[dan.coats@jll.com](mailto:dan.coats@jll.com)

Sam Haas  
443 878 3499  
[sam.haas@jll.com](mailto:sam.haas@jll.com)

Although information has been obtained from sources deemed reliable, neither Owner nor JLL makes any guarantees, warranties or representations, express or implied, as to the completeness or accuracy as to the information contained herein. Any projections, opinions, assumptions or estimates used are for example only. There may be differences between projected and actual results, and those differences may be material. The Property may be withdrawn without notice. Neither Owner nor JLL accepts any liability for any loss or damage suffered by any party resulting from reliance on this information. If the recipient of this information has signed a confidentiality agreement regarding this matter, this information is subject to the terms of that agreement. ©2022. Jones Lang LaSalle IP, Inc. All rights reserved.